

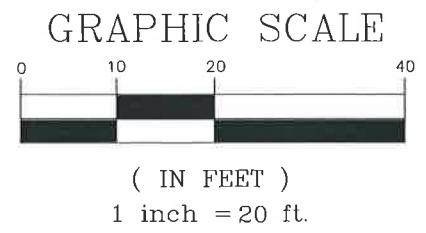

**NOTES**

1. OWNERSHIP:  
CUTSHAW ONE LLC  
INSTR. NO. 210023210  
P.B. 44 PG. 42  
PARCEL ID: W0001524028
2. THIS PROPERTY LIES IN ZONE 'X' OF THE FEMA DEFINED FLOOD HAZARD AREA AS SHOWN ON FLOOD INSURANCE RATE MAP NUMBER 5101290028D, EFFECTIVE DATE APRIL 2, 2009.
3. HORIZONTAL: THE MERIDIAN SOURCE OF THIS PLAT IS BASED ON THE VIRGINIA STATE PLANE COORDINATE SYSTEM, SOUTH ZONE, NAD 1983/1993 (HARN). COORDINATE VALUES SHOWN ARE EXPRESSED IN U.S. SURVEY FEET.  
VERTICAL: NAVD 88 DATUM
4. ZONED: UB-2 URBAN BUSINESS

SCRIPPS MEDIA, INC.  
INSTR. NO. 190019789  
PARCEL ID: W0001524025

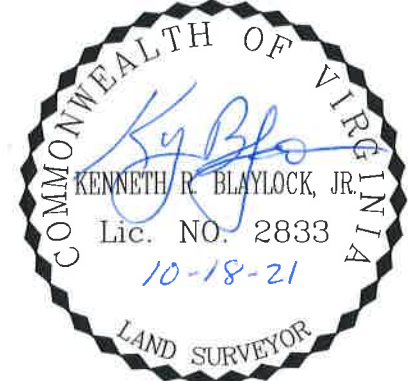

**PLAT SHOWING FOUR PROPOSED PARCELS OF LAND LYING ON THE SOUTHEAST CORNER OF W. BROAD STREET AND ROSENEATH ROAD**

CITY OF RICHMOND, VIRGINIA

DATE: OCTOBER 18, 2021

SCALE: 1" = 20'

**JENNINGSSTEPHENSON P.C.**



LAND SURVEYORS & PLANNERS



10160 STAPLES MILL ROAD  
SUITE 103  
GLEN ALLEN, VA 23060  
PHONE - 804-545-6235  
FAX - 804-545-6259  
J.N. 21-659