

City of Richmond Department of Planning & Development Review

Location, Character, and Extent

LOCATION: 3411 Semmes Avenue

COUNCIL DISTRICT: 5

PROPOSAL: Final location, character, and extent review of amenities associated with new outdoor classroom pavilion for Patrick Henry School of Science & Art (PHSSA).

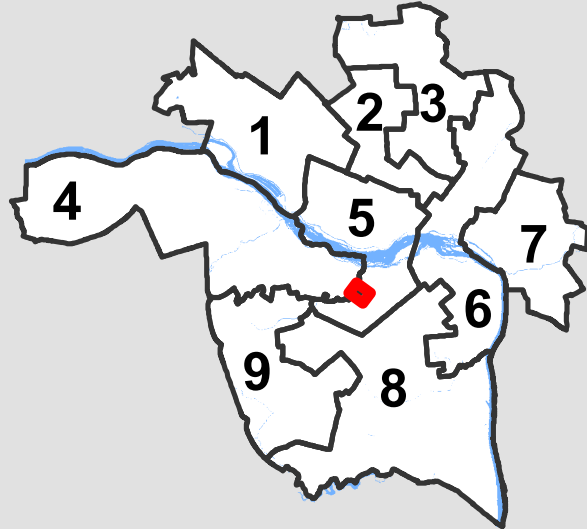

*For questions, please contact Josh Son
at 646-3741 or joshua.son@richmondgov.com*

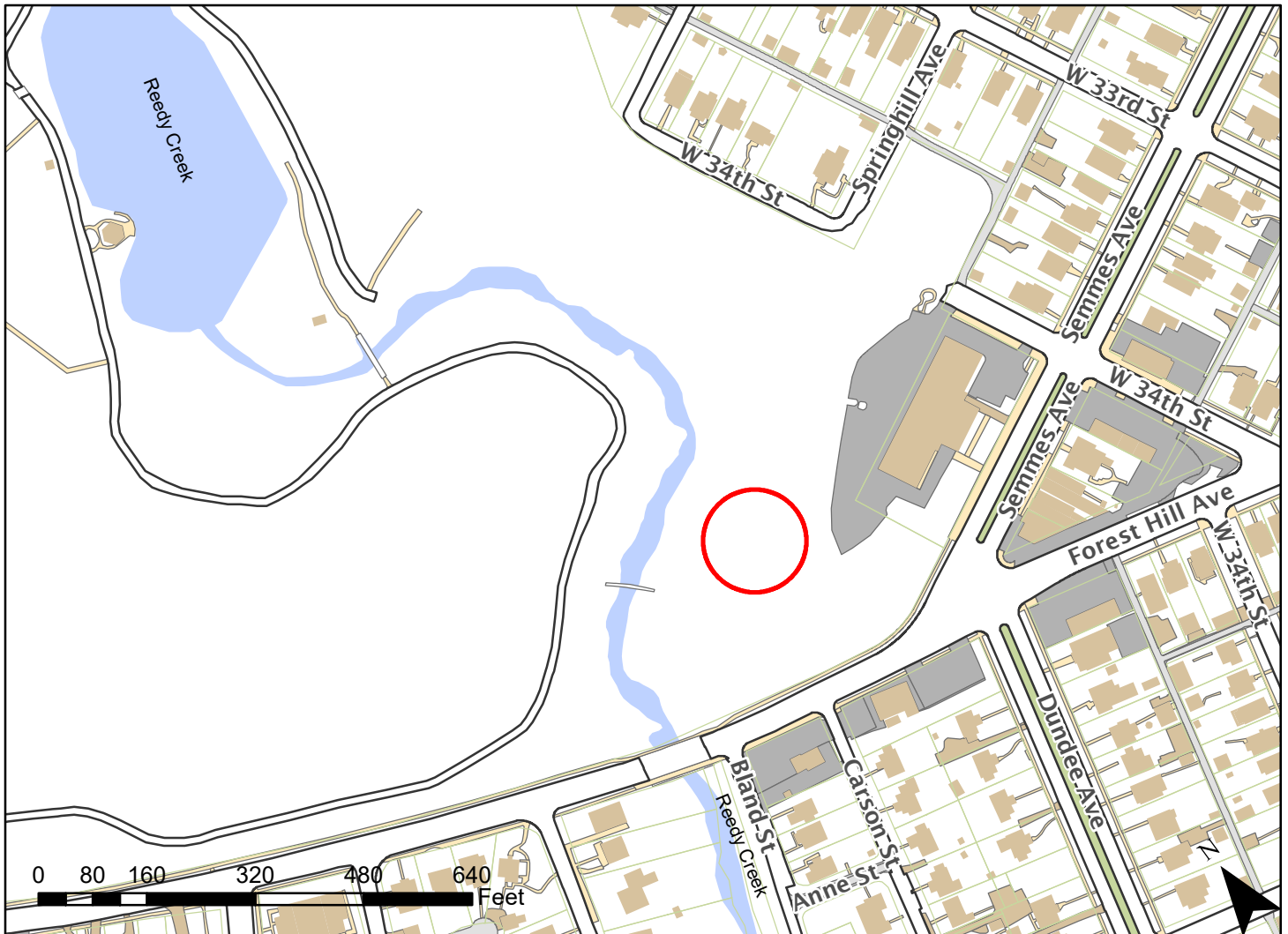



Application for URBAN DESIGN COMMITTEE Review

Department of Planning and Development Review
Planning & Preservation Division
900 E. Broad Street, Room 510
Richmond, Virginia 23219
(804) 646-6335

<http://www.richmondgov.com/CommitteeUrbanDesign>

Application Type

Addition/Alteration to Existing Structure
 New Construction
 Streetscape
 Site Amenity

Encroachment
 Master Plan
 Sign
 Other

Review Type

Conceptual
 Final

Project Name: Patrick Henry School of Science & Arts - Outdoor Classroom Pavilion

Project Address: 3411 Semmes Avenue, Richmond, VA 23225

Brief Project Description (this is not a replacement for the required detailed narrative) : _____

Multi-use outdoor education space, for students primarily seated at picnic style tables, with a teaching table as phase-1 development with enhanced site drainage swale and garden. Phase-2 will include a covered roof shelter, permanent paving, power, fans and lighting, terrace seating for larger student groups or parents, and an expanded rain water management garden feature.

Applicant Information

(on all applications other than encroachments, a City agency representative must be the applicant)

Name: Thomas Kranz Email: tkranz@rvaschools.net

City Agency: Richmond Public Schools Phone: 804-780-7710

Address: 901 East Broad Street, Richmond VA

Main Contact (if different from Applicant): Jason Maloney

Company: HKS Inc. Phone: 804-644-8400

Email: jmaloney@hksinc.com

Submittal Deadlines

All applications and support materials must be filed no later than 21 days prior to the scheduled meeting of the Urban Design Committee (UDC). Please see the schedule on page 3 as actual deadlines are adjusted due to City holidays. **Late or incomplete submissions will be deferred to the next meeting.**

Filing

Applications can be mailed or delivered to the attention of "Urban Design Committee" at the address listed at the top of this page. **It is important that the applicant discuss the proposal with appropriate City agencies, Zoning Administration staff, and area civic associations and residents prior to filing the application with the UDC.**

UDC Background

The UDC is a ten member committee created by City Council in 1968 whose purpose is to advise the City Planning Commission on the design of projects on City property or right-of-way. The UDC provides advice of an aesthetic nature in connection with the performance of the duties of the Commission under Sections 17.05, 17.06 and 17.07 of the City Charter. The UDC also advises the Department of Public Works in regards to private encroachments in the public right-of-way.

Pavilion Multi-Use Outdoor Classroom

growing
potential

Our **mission** is to cultivate students' maximum growth and develop stewardship through a premier environmental and arts education

Patrick Henry School of Science and Arts'

Outdoor Multi-purpose Classroom

To support the mission of the school and enhance learning in a nature environment, PHSSA received a grant to create an outdoor classroom space. Designed as a full sheltered pavilion, current grant funding combined with donated services, school PTA and community support will initiate the project's first phase to establish a defined site amenity space for focused gathering. By successful fundraising and additional donor contributions, complete construction of the full pavilion design is achievable within the following year. First phase budget development is targeted for \$20,000 and total project budget is estimated at \$65,000. The site work project is intended to occur over the school break period of June 18 - July 27 this early summer.

The school goals of a new pavilion classroom are:

- Enhance the science + art programs
- Be functionally flexible, provide physical accessibility
- Designed at an appropriate scale, visually fit the environment and be environmentally sensitive
- Be an amazing and inspiring space!

The program for PHSSA academic uses and functionality consist of:

- Accommodating 24 students / 4 picnic-type tables, plus extra capacity with added bench seating space and exterior seat opportunities
- Providing an Instructor demo table (mobile, with secure weather-proof storage)
- White-board (enclosable/protected) within secure/weather-proof storage cabinet - possible phase-2 item
- Potential use as a stage or stage-like function
- Additional seating on a seat wall terrace for larger gatherings and performances - planned for as phase-2 item
- Power, lighting, fans and potential security (lighting) sensors - planned for as phase-2 items

Materials for phase-1 portion of the project:

- Landscape retaining block wall as edge curbing and compacted fine-crushed stone (or pavers) as gathering space ground surface to accommodate phase-2 structure/foundation addition and the permanent slab or paver surface finish
- Mulch border at curbing with grass seed replacement of perimeter to blend into existing yard area, and accommodate phase-2 rain garden swale extension (for roof rain run-off management) around the gathering space pad
- Small rain garden enhancement at the end of the existing drainage swale (on edge of playground asphalt paving) with large stone/mulch surfaces, amended soils for improved percolation and low, hardy shrub plant materials

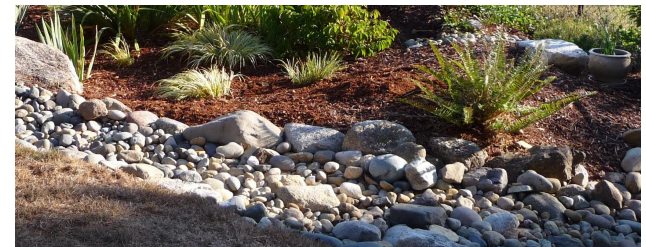



SITE PLAN LOCATION

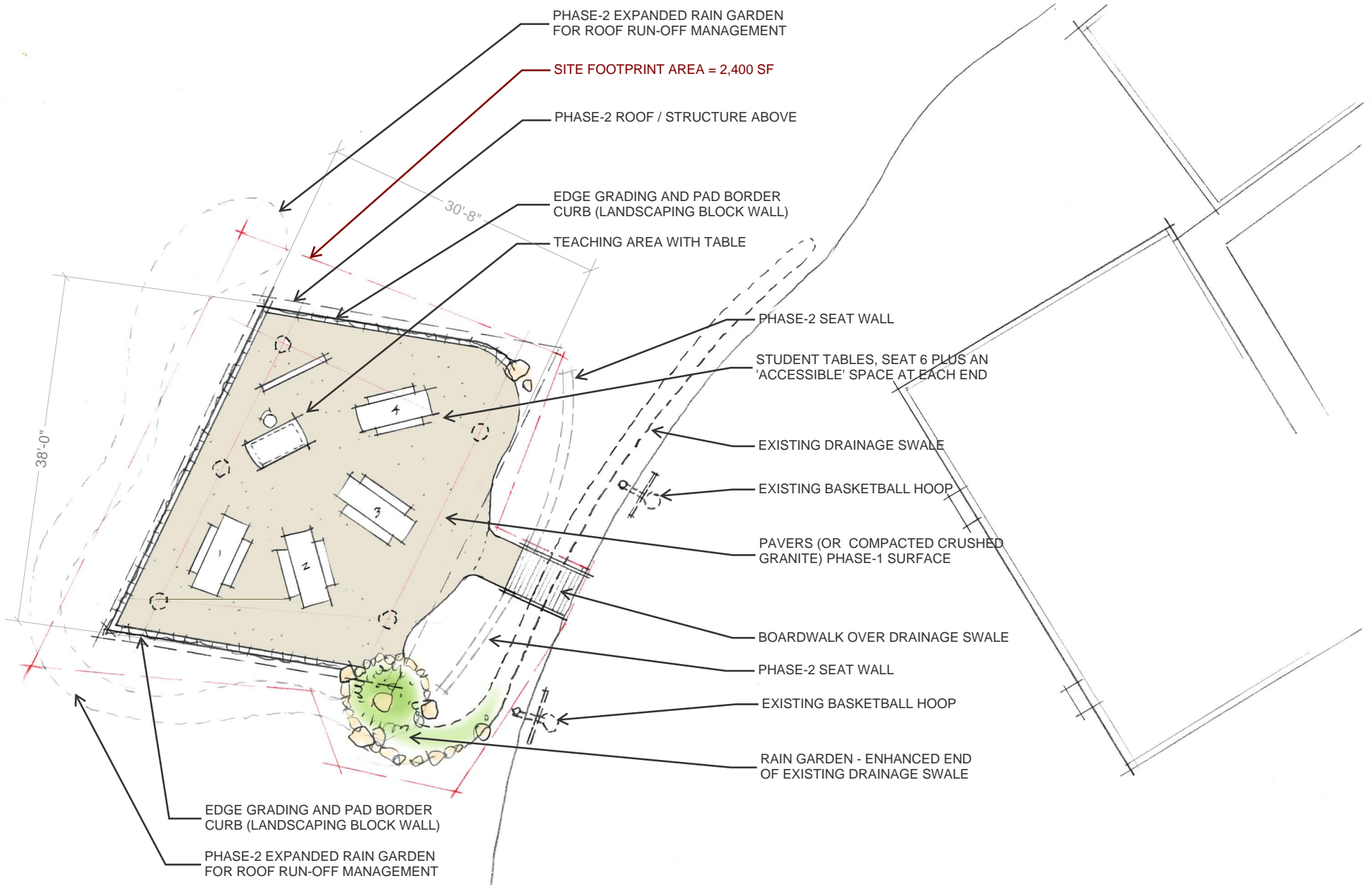

PHASE-1 SITE PLAN "TREE GROVE"

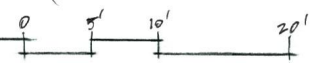

METAL PANEL ROOFING, ON SOLID WOOD STRUCTURAL DECKING (OR TRANSLUCENT ROOFING PANEL SYSTEM FOR DAYLIGHTING WITH BUDGET UPGRADE)

TIMBER COLUMNS AND TIMBER BRACKET AND ROOF FRAMING

GUARDRAIL NOT REQUIRED WITH MINIMAL GRADE DIFFERENCE (ADDED WITH BUDGET UPGRADE)

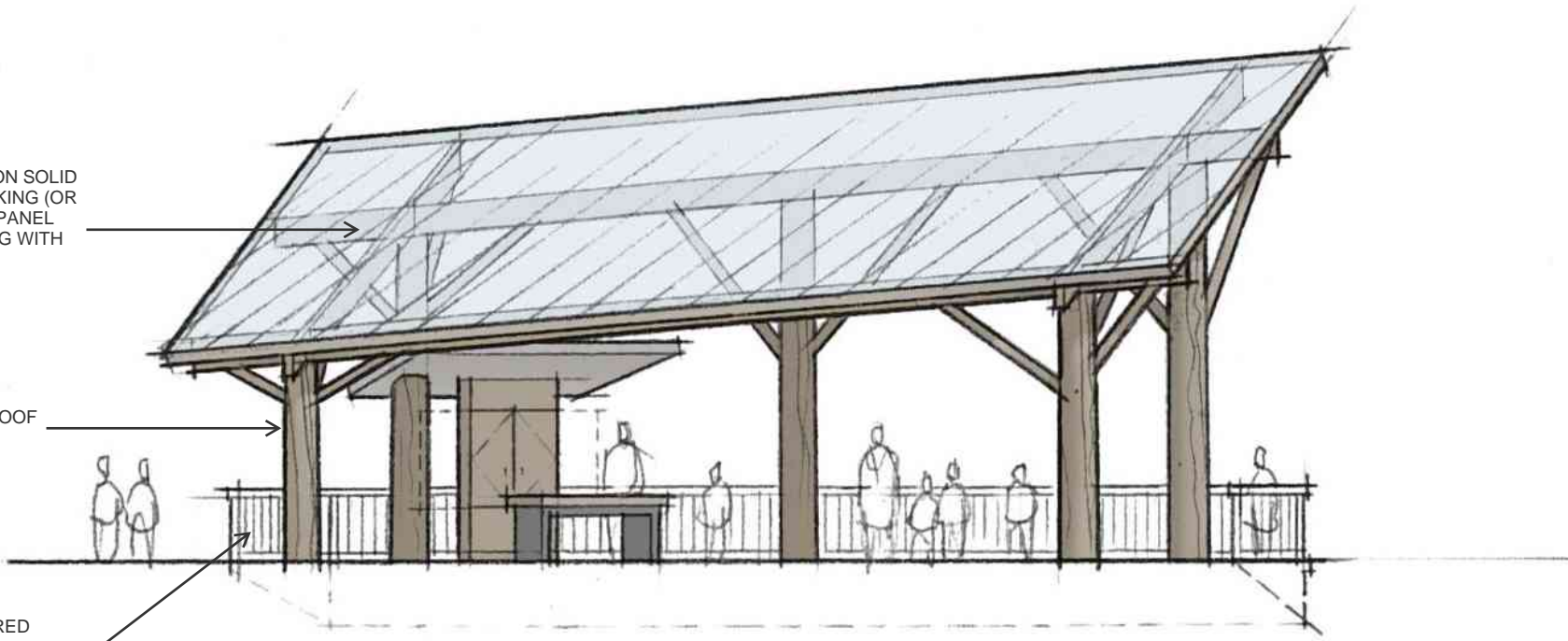

PHASE-2 STRUCTURE ELEVATION "TREE GROVE"

