



COMMISSION OF ARCHITECTURAL REVIEW

APPLICATION FOR CERTIFICATE OF APPROPRIATENESS

PROPERTY (location of work)

Address 2017-2019 Monument Ave
Historic district Monument

Date/time rec'd: _____
Rec'd by: _____
Application #: _____
Hearing date: _____

APPLICANT INFORMATION

Name DAN ENSMINGER
Company ENSMINGER ARCHITECTURE
Mailing Address 503 RIDGE TOP RD
RICHMOND VA 23229

Phone 804-314-1147
Email DAN@ENSMINGERARCHITECTURE.COM
Applicant Type: Owner Agent
 Lessee Architect Contractor
 Other (please specify):

OWNER INFORMATION (if different from above)

Name DR. JUAN ASTRUC
Mailing Address _____

Company _____
Phone _____
Email _____

PROJECT INFORMATION

Review Type: Conceptual Review Final Review
Project Type: Alteration Demolition New Construction
(Conceptual Review Required)

Project Description: (attach additional sheets if needed)

RENOVATION AND ADDITION TO PROPERTY @ REAR.

ACKNOWLEDGEMENT OF RESPONSIBILITY

Compliance: If granted, you agree to comply with all conditions of the certificate of appropriateness (COA). Revisions to approved work require staff review and may require a new application and approval from the Commission of Architectural Review (CAR). Failure to comply with the COA may result in project delays or legal action. The COA is valid for one (1) year and may be extended for an additional year, upon written request.

Requirements: A complete application includes all applicable information requested on checklists to provide a complete and accurate description of existing and proposed conditions. Applicants proposing major new construction, including additions, should meet with Staff to review the application and requirements prior to submitting an application. Owner contact information and signature is required. Late or incomplete applications will not be considered.

Zoning Requirements: Prior to Commission review, it is the responsibility of the applicant to determine if zoning approval is required and application materials should be prepared in compliance with zoning.

Signature of Owner [Signature] Date 1/31/20

Print plans at 11" x 17",

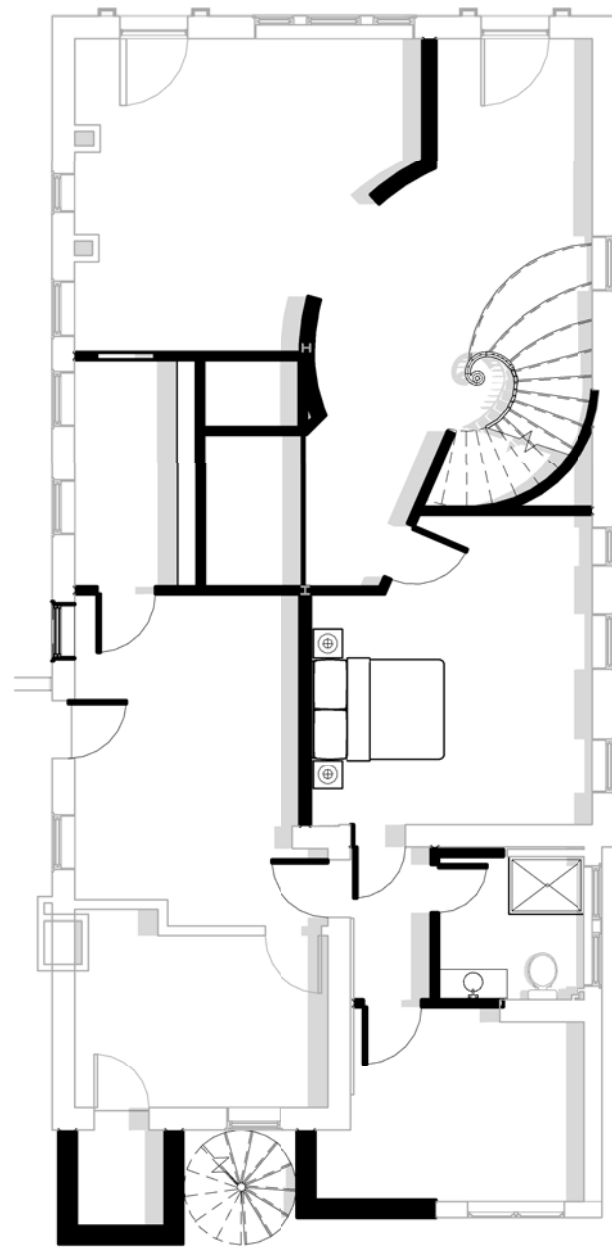

1 Basement - Proposed
1" = 10'-0"

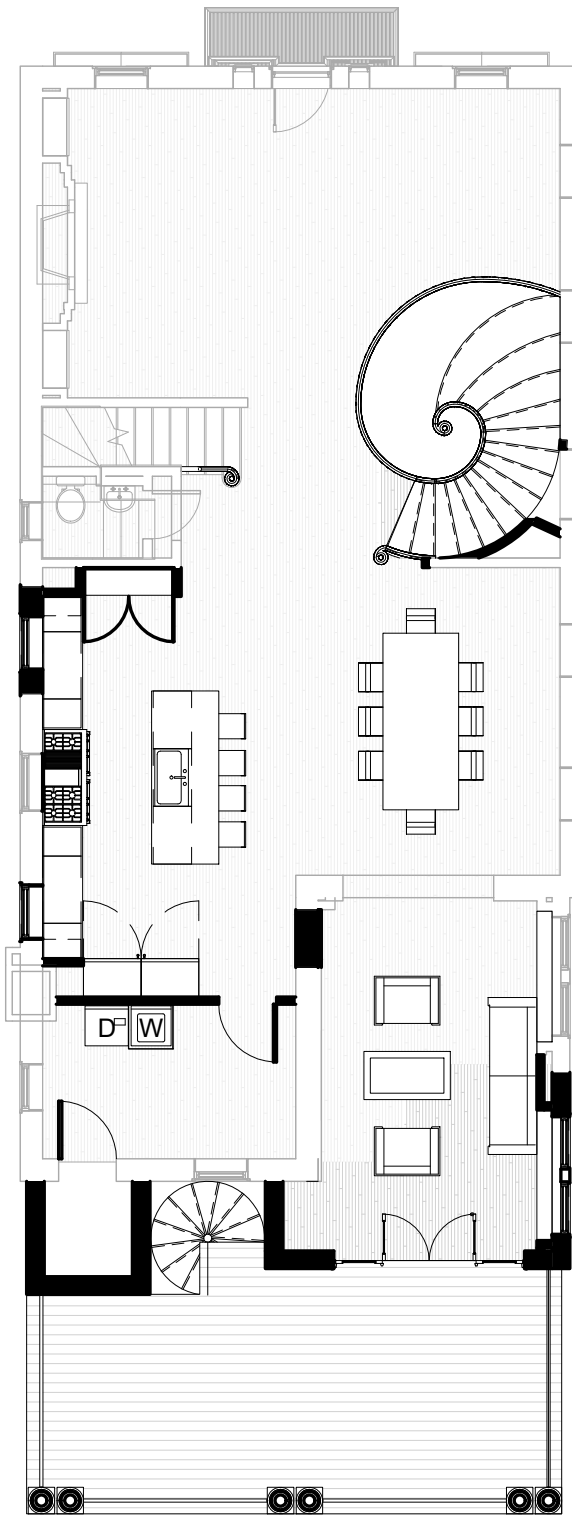

2 1st Floor - Proposed
1" = 10'-0"

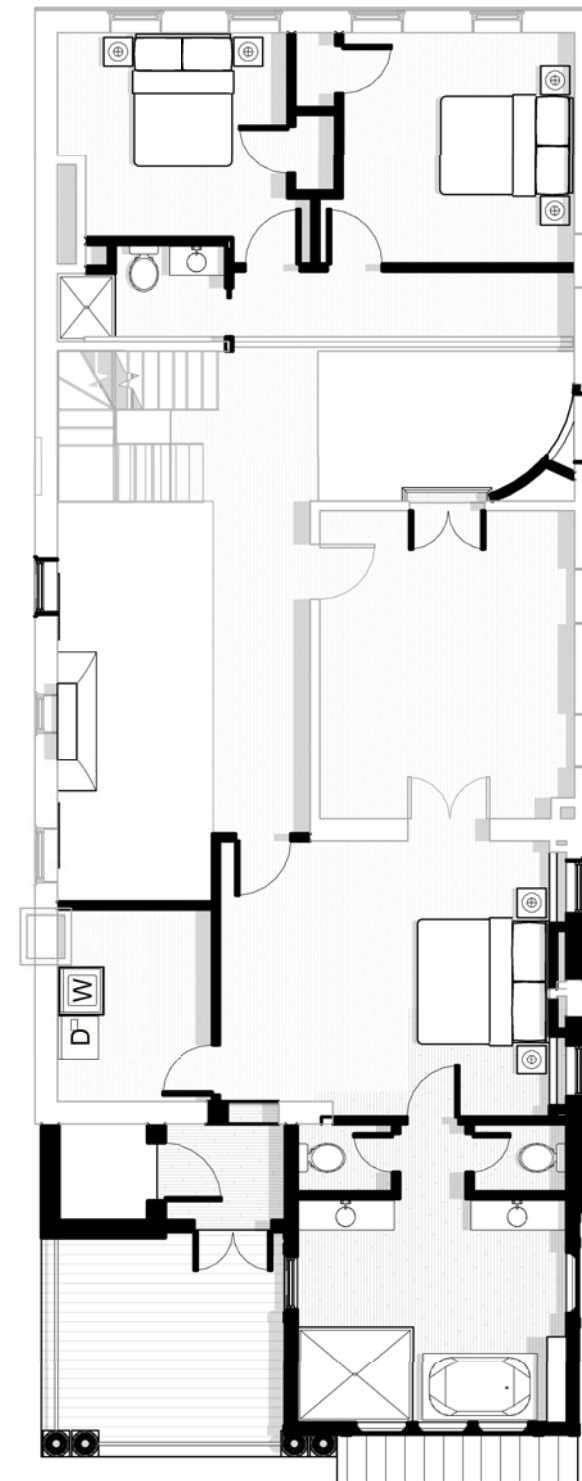

3 2nd Floor - Proposed
1" = 10'-0"

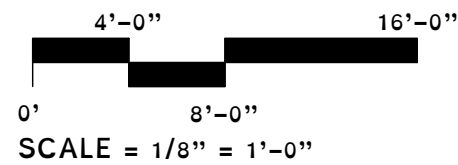

Floor Plans
2019 Monument Avenue
Astruc Residence
January 27, 2020

A 1.1

Rev.	Date	Description

ARCHITECTURE
Ensminger
503
804.323.6299
Ridge Top Road, Richmond, VA 23229
Dan@ensmingerarchitecture.com

Print plans at 11" x 17",

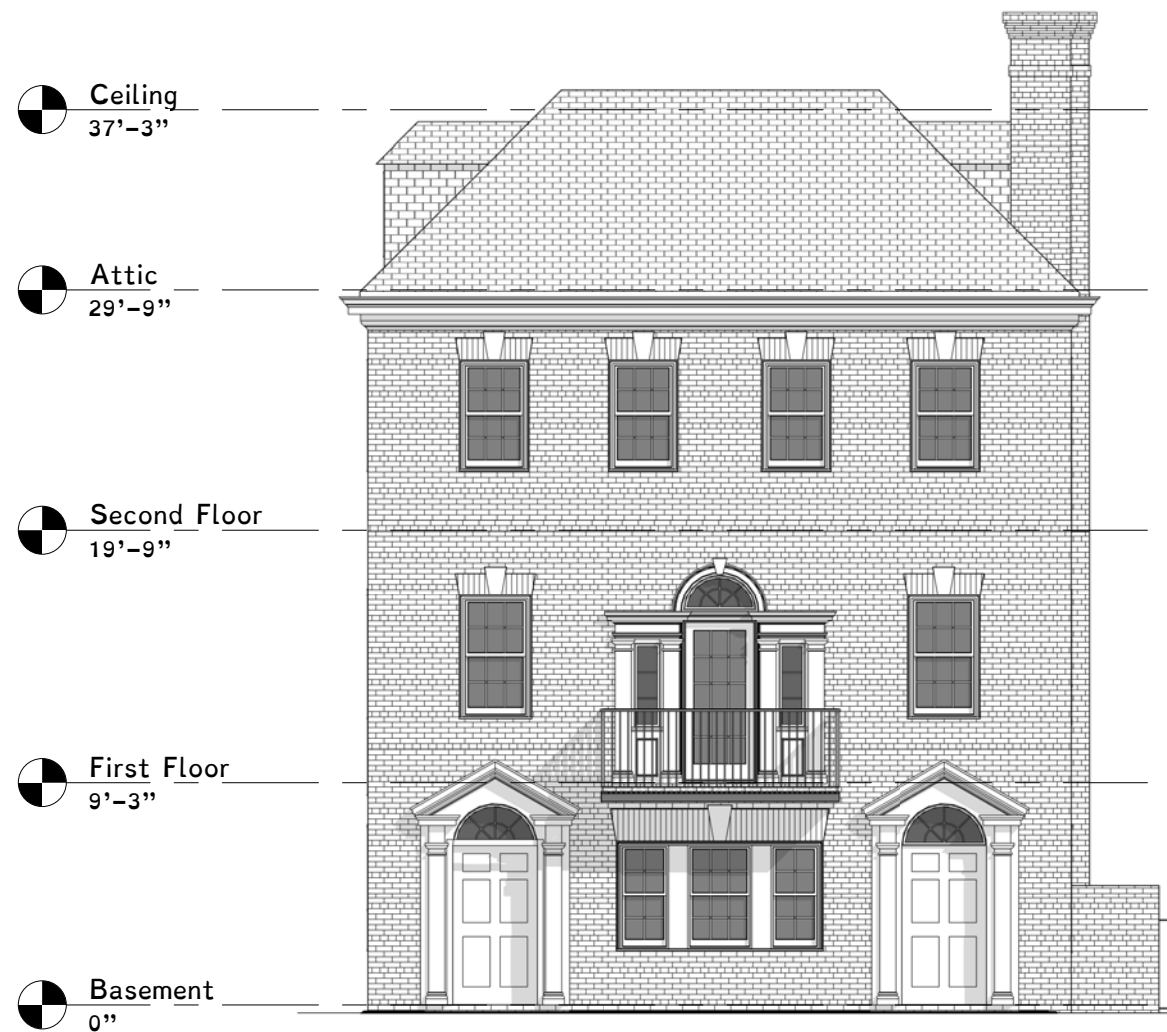

1 Existing North
1/8" = 1'-0"

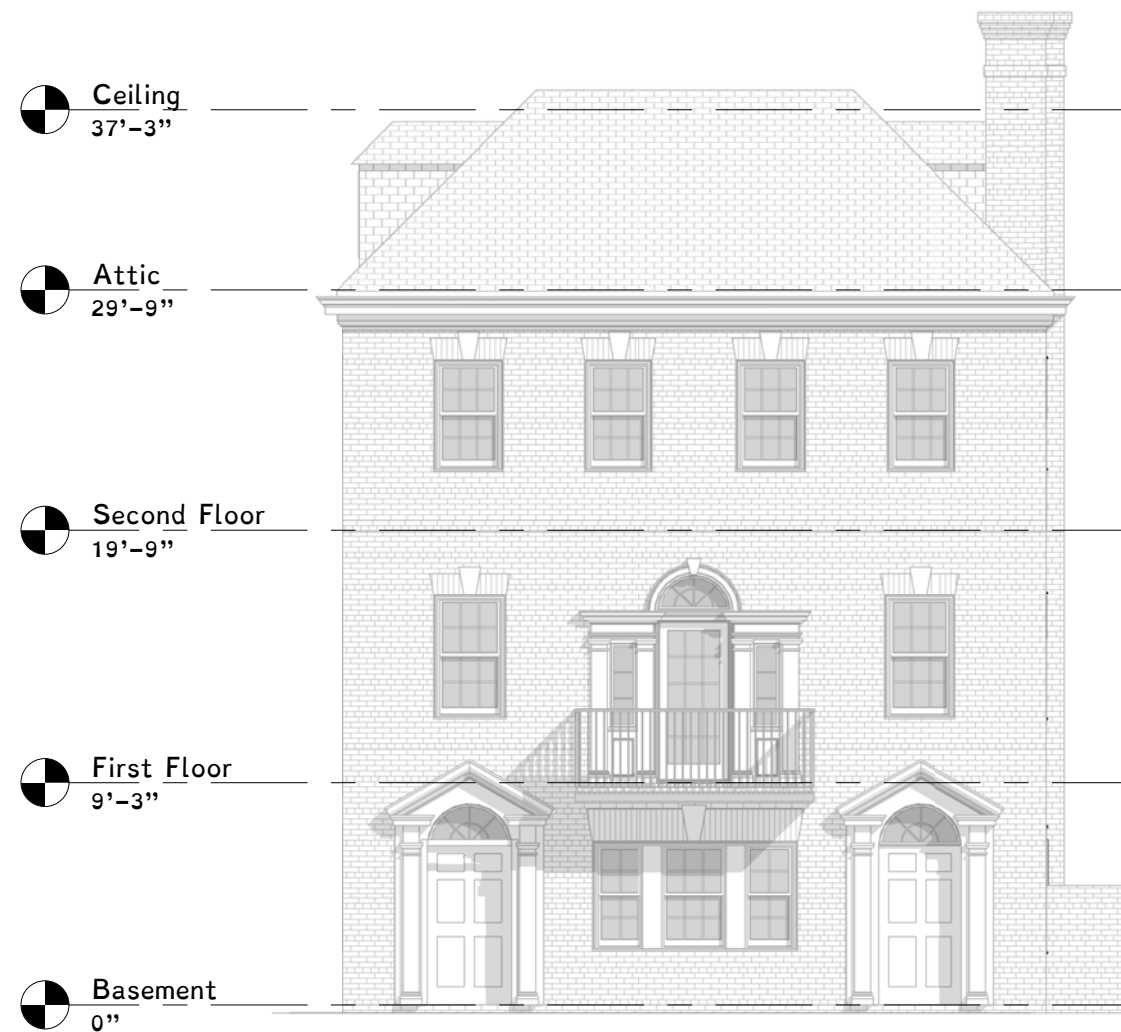

2 CAR- Proposed North
1/8" = 1'-0"

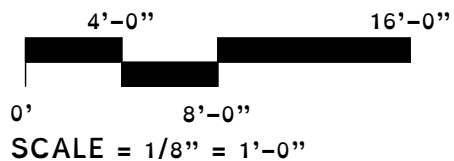

Rev.	Date	Description

North Elevations
 2019 Monument Avenue
 Astruc Residence

January 27, 2020 A 2.1



Print plans at 11" x 17",



Rev.	Date	Description

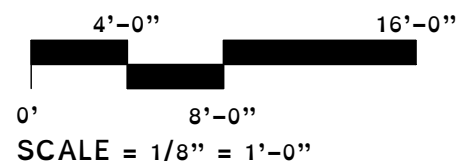

Existing East Elevation
 2019 Monument Avenue
 Astruc Residence

January 27, 2020

A 2.2

ARCHITECTURE

Ensminger

503

804.323.6299

Ridge Top Road, Richmond, VA 23229

Dan@ensmingerarchitecture.com

Print plans at 11" x 17",



Rev.	Date	Description

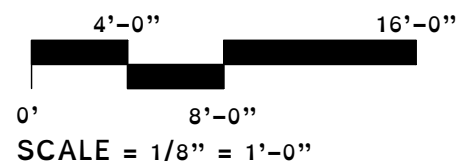

Proposed East Elevation
 2019 Monument Avenue
 Astruc Residence

January 27, 2020

A 2.3

ARCHITECTURE
Ensminger

804.323.6299

503
 Ridge Top Road, Richmond, VA 23229

Dan@ensmingerarchitecture.com

Print plans at 11" x 17",

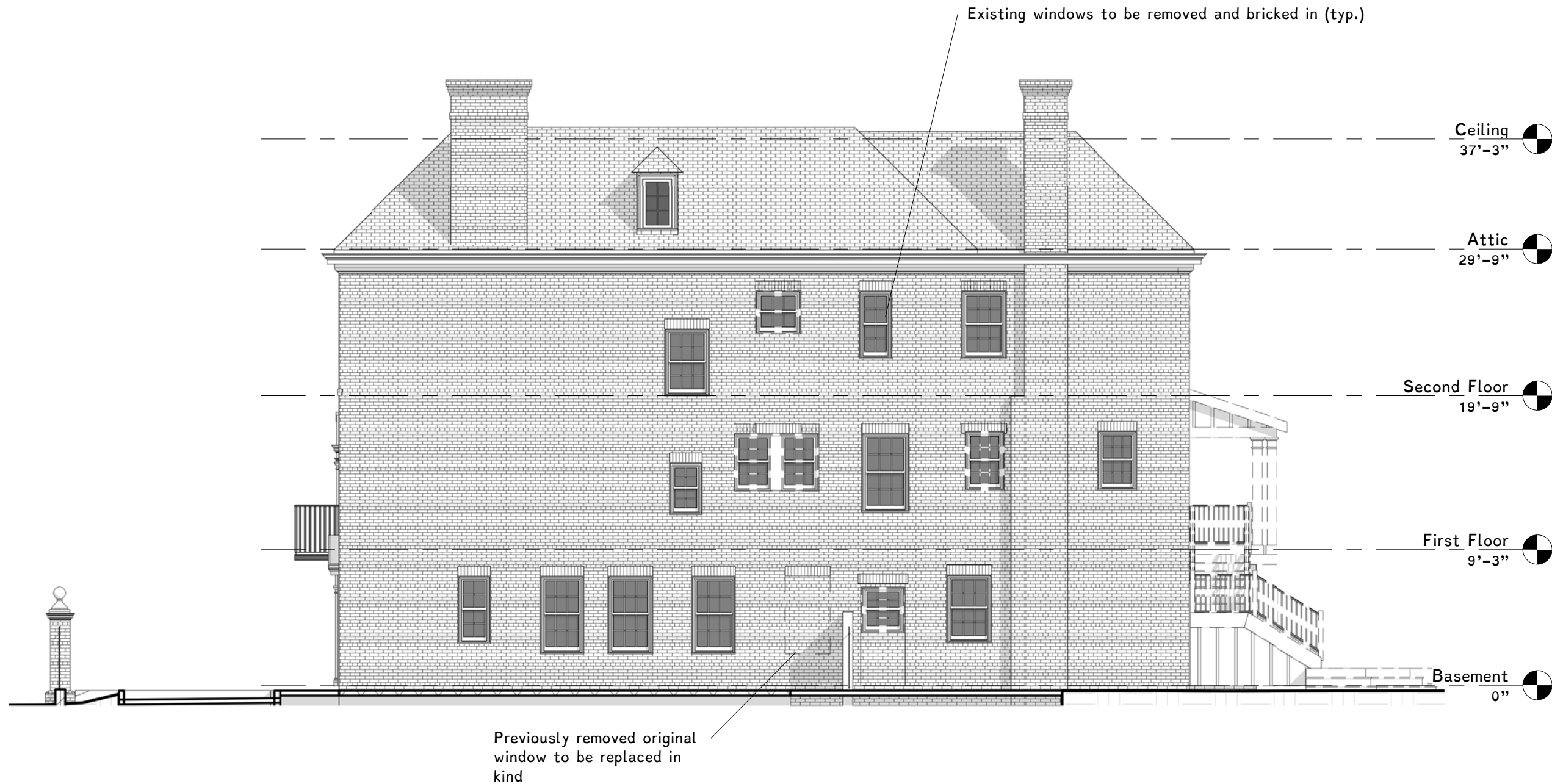

Rev.	Date	Description

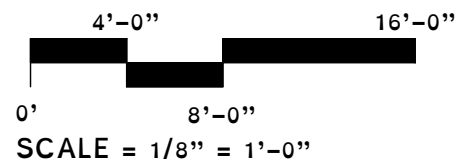

Existing West Elevation
 2019 Monument Avenue
 Astruc Residence

January 27, 2020 A 2.4

ARCHITECTURE
Ensminger

503

804.323.6299

Ridge Top Road, Richmond, VA 23229

Dan@ensmingerarchitecture.com

Print plans at 11" x 17",

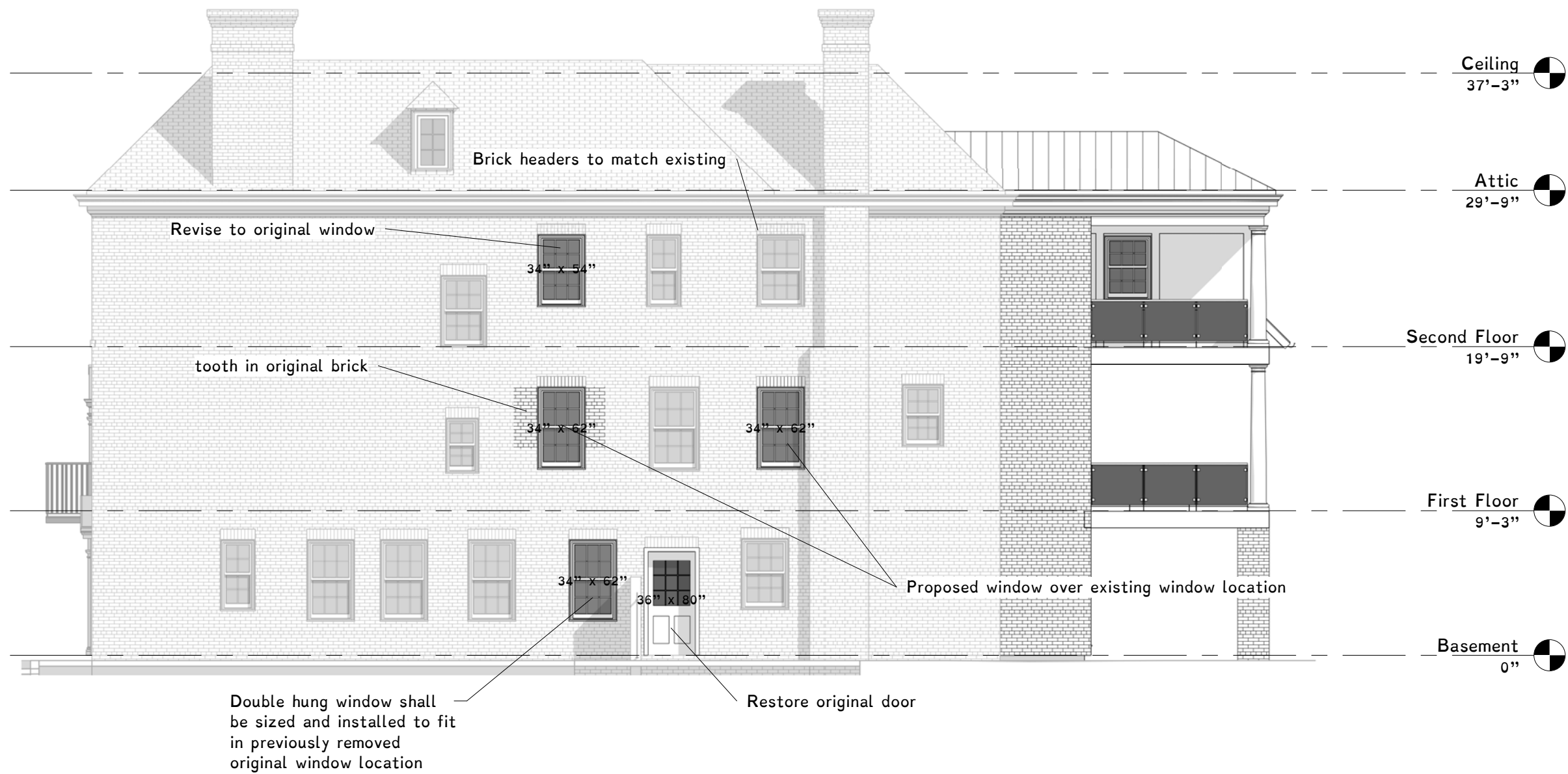

Rev.	Date	Description

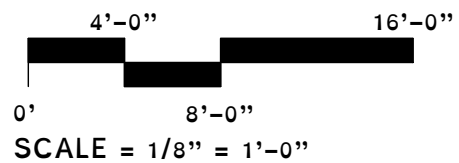

Proposed West Elevation
 2019 Monument Avenue
 Astruc Residence
 January 27, 2020

A 2.5

ARCHITECTURE
Ensminger
 503
 804.323.6299
 Ridge Top Road, Richmond, VA 23229
 Dan@ensmingerarchitecture.com

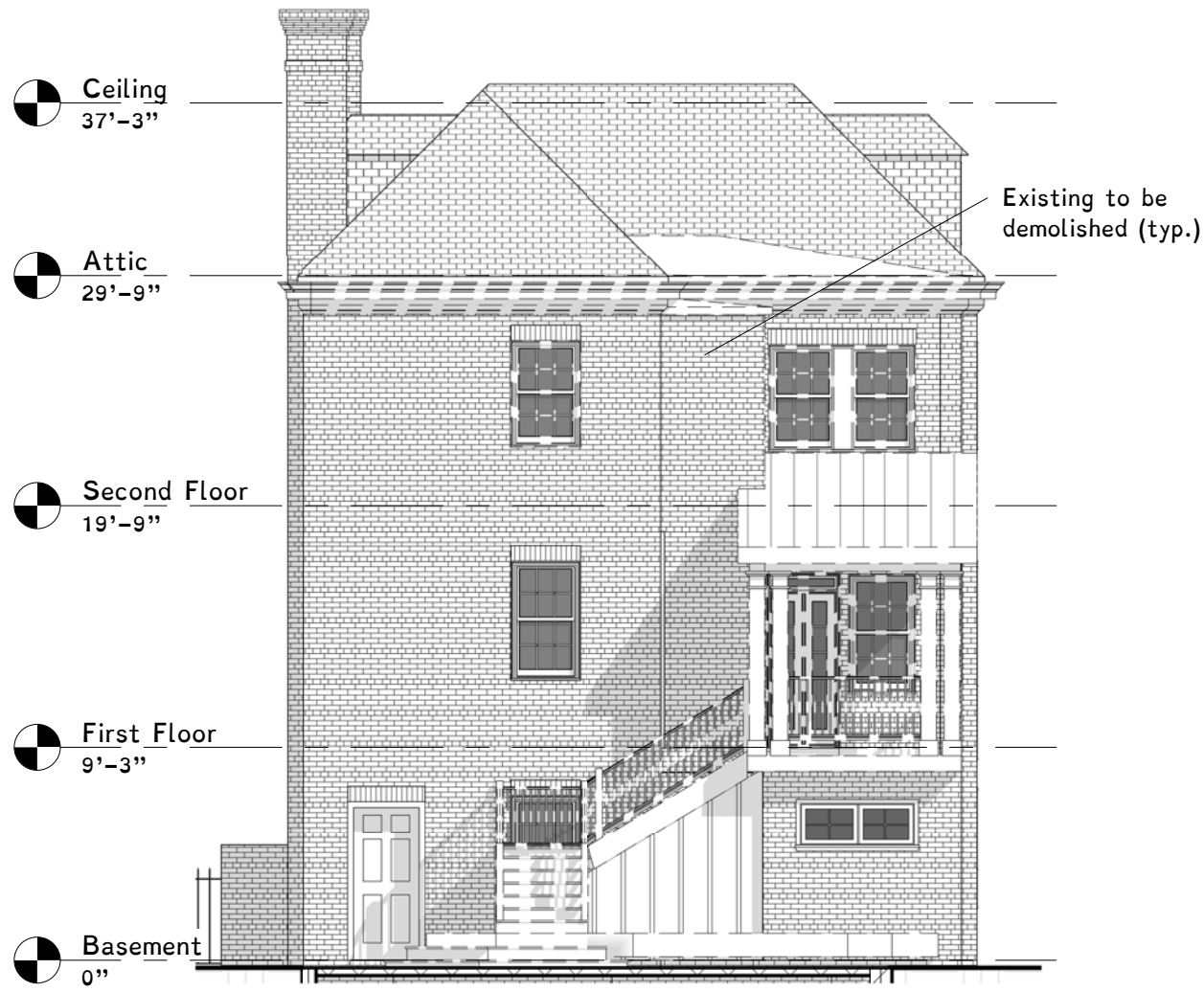

1 Existing South
1/8" = 1'-0"

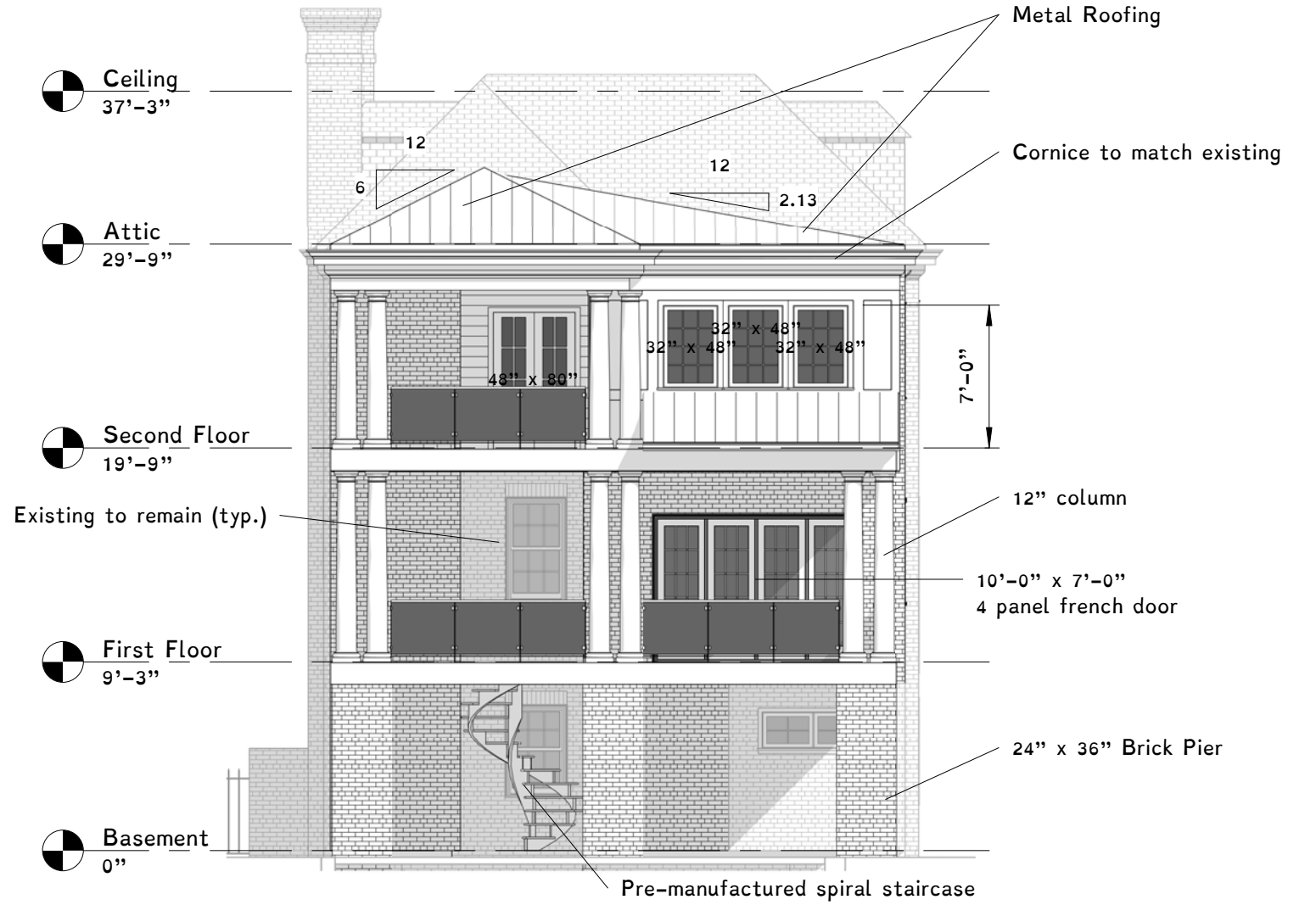

2 Existing South
1/8" = 1'-0"

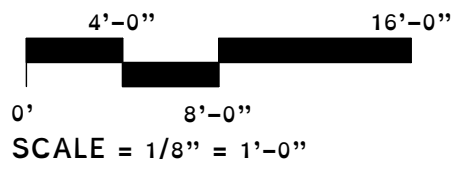

South Elevations
2019 Monument Avenue
Astruc Residence
January 27, 2020

A 2.6

ARCHITECTURE
Ensminger
503
804.323.6299
Ridge Top Road, Richmond, VA 23229
Dan@ensmingerarchitecture.com

Print plans at 11" x 17",

Rev.	Date	Description



Existing



Proposed



Print plans at 11" x 17",

Rev.	Date	Description

Alley Perspective
 2019 Monument Avenue
 Astruc Residence

January 27, 2020 A 9.1

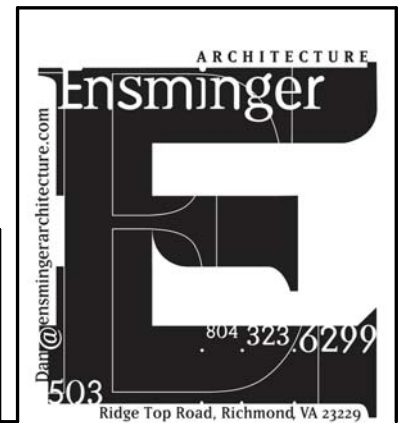



Existing



Proposed

Print plans at 11" x 17",

Rev.	Date	Description

Alley Perspective
 2019 Monument Avenue
 Astruc Residence
 January 27, 2020 A 9.2

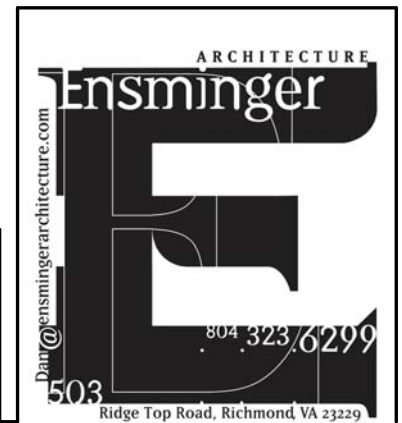



Existing



Proposed

Print plans at 11" x 17",

Rev.	Date	Description

Alley Perspective
 2019 Monument Avenue
 Astruc Residence
 January 27, 2020

A 9.3





Existing



Proposed

Print plans at 11" x 17",

Rev.	Date	Description

Street Perspective
 2019 Monument Avenue
 Astruc Residence
 January 27, 2020

A 9.4





Existing



Proposed

Print plans at 11" x 17",

Rev.	Date	Description

Street Perspective
 2019 Monument Avenue
 Astruc Residence

January 27, 2020 A 9.5

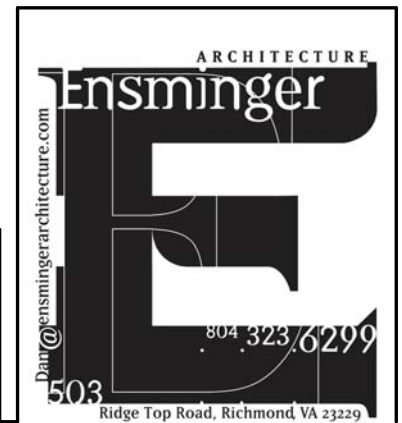



Existing

Proposed

Driveway Perspective
 2019 Monument Avenue
 Astruc Residence

January 27, 2020 A 9.6

Rev.	Date	Description



Print plans at 11" x 17",