

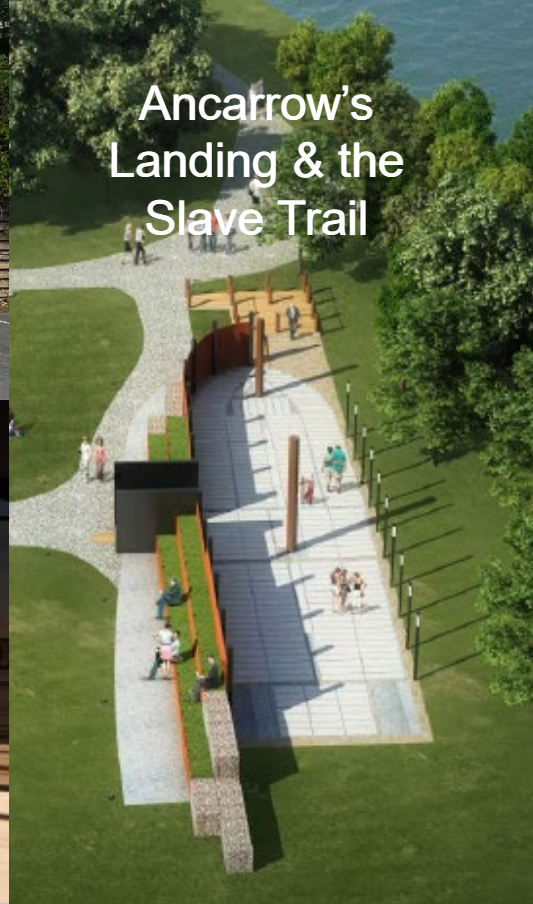

Emily Winfree's Cottage



Ancarrow's  
Landing & the  
Slave Trail



Lumpkin's Jail Site



The South Memorial



The Shockoe Project  
Interpretive Center

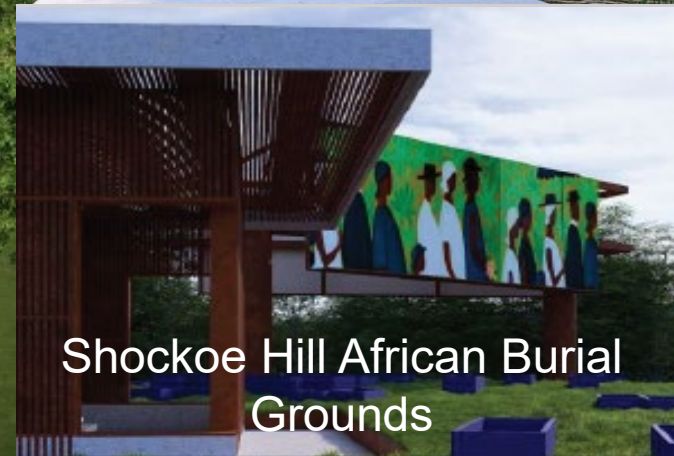

Shockoe Hill African Burial  
Grounds



National Slavery Museum

# THE SHOCKOE PROJECT: A Brief Update

LAND USE, HOUSING & TRANSPORTATION COUNCIL COMMITTEE MEETING

April 22, 2025

PRESENTED BY: SHARON L. EBERT, DEPUTY CAO, FOR PLANNING AND ECONOMIC DEVELOPMENT



**The Shockoe Project is a destination and a way to tell the history of the United States' role in the domestic slave trade industry during the first half of the 1800s.**

**The Shockoe Project is also a collection of places:**

- **The Slave Trail and Ancarrow's Landing**
- **The Shockoe Hill African Burial Ground**
- **Emily Winfree's Cottage**
- **The Shockoe Interpretive Center and**
- **The 10-acre Shockoe Campus that includes Lumpkin's Jail Site and the South Memorial**

## **SHOCKOE PROJECT'S KEY PERSONNEL**

### **The City's Project Management Team:**

Leo Mantey, Senior Project Manager  
Jeannie Welliver, City's Architect-in-charge  
Marty West

### **The Shockoe Institute:**

Marland Buckner, CEO

### **The National Slavery Museum Foundation:**

Delegate McQuinn  
Ben Campbell  
Sylvester Turner

### **The Design Consultants:**

Baskervill, Burt Pinnock, Principal in-charge  
Waterstreet Studio  
Siddall Communications

### **The Construction Team for the Shockoe Institute & Ancarrow's Landing & Slave Trail:**

Team Henry

# **THE SHOCKOE PROJECT: The Management Team**

**LAND USE, HOUSING & TRANSPORTATION COUNCIL COMMITTEE MEETING**

**April 22, 2025**

**PRESENTED BY: SHARON L. EBERT, DEPUTY CAO, FOR PLANNING AND ECONOMIC DEVELOPMENT**







In 2023 the City applied for and received a \$11 million grant from the Mellon Foundation to “tell America’s story of the struggle to expand human freedom”.

“The Shockoe Institute is a national organization headquartered in Richmond, Virginia and dedicated to revealing the enduring impact of racial slavery on our shared American experience.” (Shockoe Institute’s website)

The City and the Shockoe Institute worked with Baskervill to design a 12,000 SF exhibition, educational and interactive storytelling facility in the Main Street Station Train Shed lower level. Baskervill’s contract was for \$986,948.

The City has awarded \$2,562,081 for the facility’s construction to Team Henry which started this spring. The Shockoe Institute has partnered with Local Projects to design and build the exhibition spaces at a cost of \$1,257,939.90.

The facility is scheduled to open next spring.

# THE SHOCKOE PROJECT: The Shockoe Institute

LAND USE, HOUSING & TRANSPORTATION COUNCIL COMMITTEE MEETING

April 22, 2025

PRESENTED BY: SHARON L. EBERT, DEPUTY CAO, FOR PLANNING AND ECONOMIC DEVELOPMENT





**Emily Winfree's Cottage was originally located in the Blackwell neighborhood of Manchester where formerly enslaved African Americans lived in the late 1800s and early 1900s.**

**It was the home of Emily Winfree and her children and represents her life of “hardship, resilience and triumph”. The building was saved from demolition in 2002 and temporarily moved to Shockoe Bottom next to Lumpkin's Jail site, where it remains today.**

**The City has been working with descendants of the Winfree family, the State History and Cultural Museum and Parks and Recreation Department staff to relocate the Cottage back to the Blackwell neighborhood on a parcel of land across the street from Blackwell Elementary School and next to the playground at 15<sup>th</sup> and Maury streets.**

**The project's cost is estimated at \$1,500,000.**

# THE SHOCKOE PROJECT: Emily Winfree Cottage

**LAND USE, HOUSING & TRANSPORTATION COUNCIL COMMITTEE MEETING**

**April 22, 2025**

**PRESENTED BY: SHARON L. EBERT, DEPUTY CAO, FOR PLANNING AND ECONOMIC DEVELOPMENT**





## Ancarrow's Landing & the Slave Trail

The Richmond Slave trail chronicles the history of the trade of enslaved Africans through 1775 from Africa to Virginia and there after from Virginia to other locations in the deep South. The trail starts at Ancarrow's Landing (the Manchester Docks) and ends in Shockoe Bottom at numerous slave trade establishments.

The City hired Baskervill to design Ancarrow's Landing and related improvements to the Slave Trail.

Team Henry has been procured to do the construction work.

The Cost is \$2,096,043.

The project is scheduled to start this year and be completed in Spring 2026.

# THE SHOCKOE PROJECT: Ancarrow's Landing

LAND USE, HOUSING & TRANSPORTATION COUNCIL COMMITTEE MEETING

April 22, 2025

PRESENTED BY: SHARON L. EBERT, DEPUTY CAO, FOR PLANNING AND ECONOMIC DEVELOPMENT





# The 2025 Conceptual Site Plan

The Shockoe Project is both a destination to recognize history, and an effort to uncover its truths. The project focuses on Richmond, Virginia's Shockoe Valley, which was an epicenter of America's slave trade. The project consists of both a central campus and outlying sites. The central campus hosts the Shockoe Institute, National Slavery Museum, Lumpkin's Slave Jail Pavilion, a memorial honoring the hundreds of thousands of enslaved Africans traded here, and a memorial honoring the African Burial Ground. The campus will interconnect with a winding path indicative of the journey of the enslaved. Outlying sites include the Richmond Slave Trail, Winfree Cottage, the Reconciliation Statue and Shockoe Hill African Burying Ground. The Shockoe Project will also serve as an organization that supports the truth in history and its indelible effects.



## THE SHOCKOE PROJECT: The Ten-Acre Campus

LAND USE, HOUSING & TRANSPORTATION COUNCIL COMMITTEE MEETING

April 22, 2025

PRESENTED BY: SHARON L. EBERT, DEPUTY CAO, FOR PLANNING AND ECONOMIC DEVELOPMENT



## PHASE ONE: The South Campus

The City currently has \$32,986,325 in funds available for the project, inclusive of \$13,400,966 from the State.

Another \$10,100,000 is budgeted in the City's FY26 CIP, bringing the total funding available to \$45,476,307.

MAIN STREET  
STATION

The Shockoe Institute

Lumpkin's Slave Jail Pavilion

The South Memorial

SOUTH  
CAMPUS

East Broad Street

I-95

N16THST

# THE SHOCKOE PROJECT: South Campus

LAND USE, HOUSING & TRANSPORTATION COUNCIL COMMITTEE MEETING

April 22, 2025

PRESENTED BY: SHARON L. EBERT, DEPUTY CAO, FOR PLANNING AND ECONOMIC DEVELOPMENT







Lumpkin's Jail Site



The South Memorial

# THE SHOCKOE PROJECT: South Campus

LAND USE, HOUSING & TRANSPORTATION COUNCIL COMMITTEE MEETING

April 22, 2025

PRESENTED BY: SHARON L. EBERT, DEPUTY CAO, FOR PLANNING AND ECONOMIC DEVELOPMENT







One of the most important archeological finds in this century was the remains of Robert Lumpkin's slave trader complex buried 10 to 15 feet below grade. The remains consists of the main house, hotel cook's quarters and jail. Known during the mid1800s as the Devil's Half Acre, Lumpkin was known as a notoriously cruel slave trader.

When he died in 1866, he left his property to his wife Mary, a mulatto enslaved African woman who bore his children. She eventually sold the property to the Colver Theological Seminary hat later became Virginia Union University.

# THE SHOCKOE PROJECT: Lumpkin's Jail Site & Pavilion

LAND USE, HOUSING & TRANSPORTATION COUNCIL COMMITTEE MEETING

April 22, 2025

PRESENTED BY: SHARON L. EBERT, DEPUTY CAO, FOR PLANNING AND ECONOMIC DEVELOPMENT





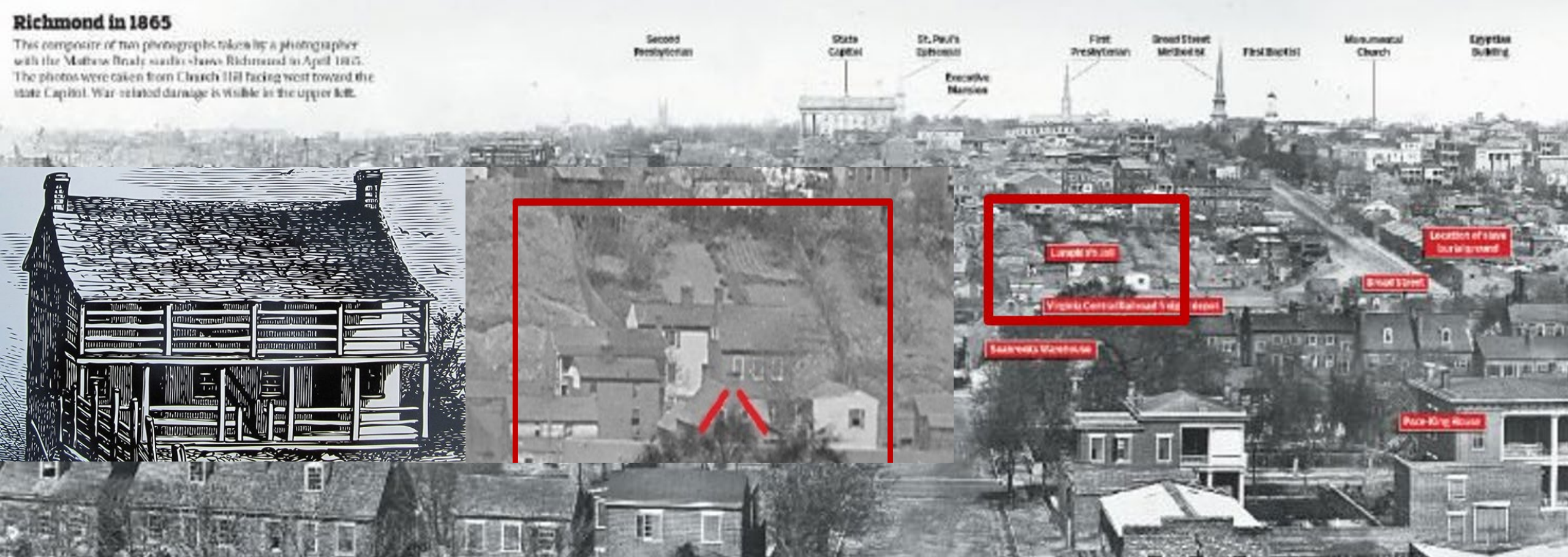

# THE SHOCKOE PROJECT: Lumpkin's Pavilion

LAND USE, HOUSING & TRANSPORTATION COUNCIL COMMITTEE MEETING

April 22, 2025

PRESENTED BY: SHARON L. EBERT, DEPUTY CAO, FOR PLANNING AND ECONOMIC DEVELOPMENT







# THE SHOCKOE PROJECT: Lumpkin's Pavilion

LAND USE, HOUSING & TRANSPORTATION COUNCIL COMMITTEE MEETING

April 22, 2025

PRESENTED BY: SHARON L. EBERT, DEPUTY CAO, FOR PLANNING AND ECONOMIC DEVELOPMENT





**The Lumpkin's Jail site is currently under design by Baskervill.**

**The construction of the project is scheduled to begin in 2026 with the unearthing of the archeological remains.**

**The total project costs are estimated to be \$17,500,000.**

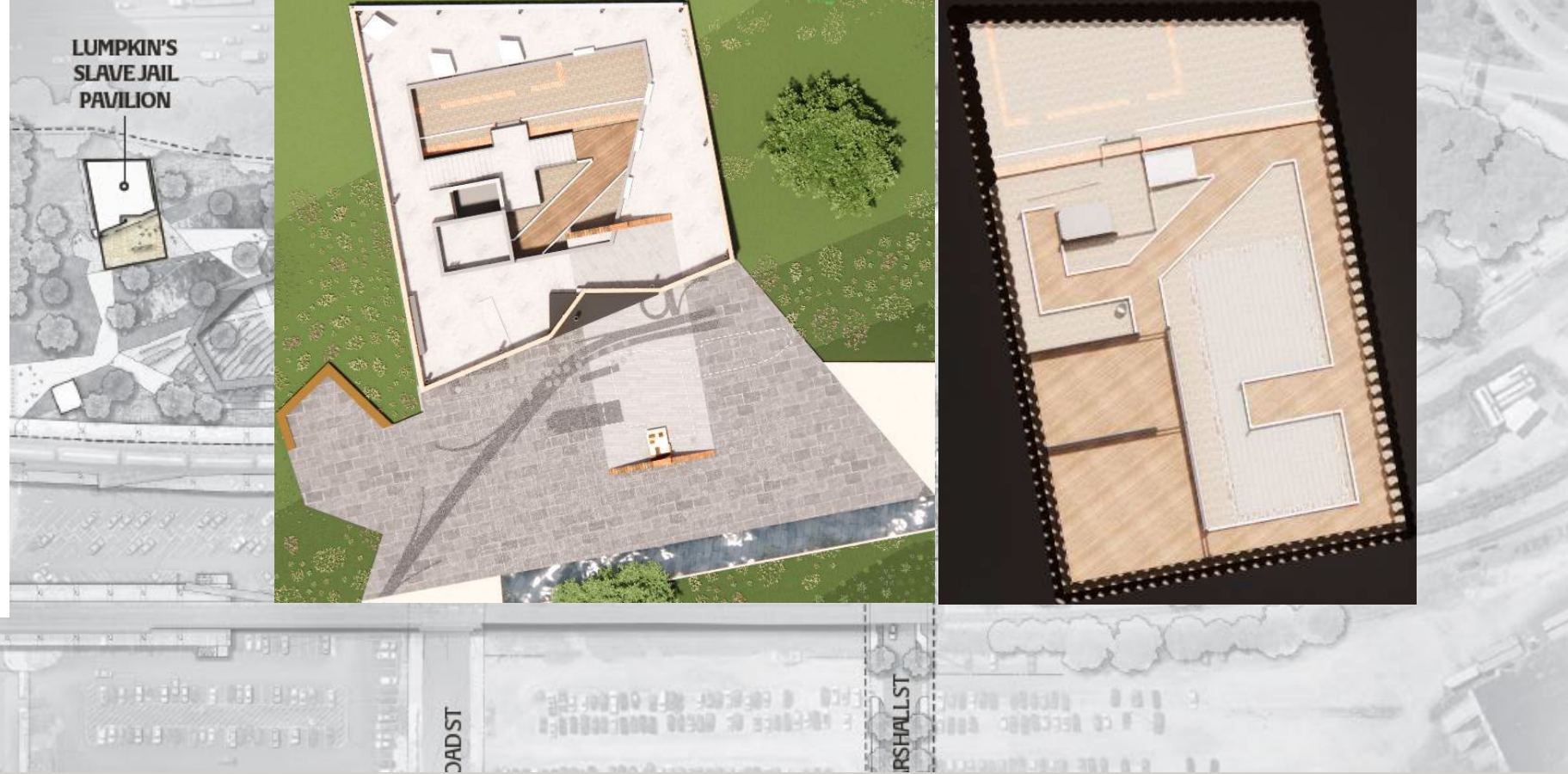

# THE SHOCKOE PROJECT: Lumpkin's Pavilion

LAND USE, HOUSING & TRANSPORTATION COUNCIL COMMITTEE MEETING

April 22, 2025

PRESENTED BY: SHARON L. EBERT, DEPUTY CAO, FOR PLANNING AND ECONOMIC DEVELOPMENT







**The South Campus includes the Lumpkin's Jail Site and the Memorial. The Memorial is a reflective space and represents the hundreds of thousands of enslaved people that were bought and sold in Shockoe Bottom during the time-period from 1830 through 1865.**

**The South Campus and Memorial is currently under design by Baskervill.**



**The estimated total project costs for both the South Campus and the Memorial is estimated at \$34,000,000.**

**Construction is scheduled to begin after the start of the Lumpkin's Jail Site.**

# THE SHOCKOE PR

**LAND USE, HOUSING & TRANSPORTATION COUNCIL COMMITTEE MEETING**

**April 22, 2025**

**PRESENTED BY: SHARON L. EBERT, DEPUTY CAO, FOR PLANNING AND ECONOMIC DEVELOPMENT**





The Shockoe Hill African Burial Ground is located at 1305 N 5<sup>th</sup> Street. The current 1.2-acre parcel is a portion of the original 15-acre burial ground that was created when the Burial Ground for Negroes was closed in 1816. (The Burial Ground for Negroes is located under State Highway I-95. A North Campus Memorial is planned to honor this burial ground.) The Shockoe Hill African Burial Ground was closed in 1879, and it is believed to have an estimated 22,000 people buried there. The 1.2-acre parcel was purchased by the City in 2021 at a tax delinquent property sale and was officially declared a cemetery by the City in November 2024.

The City has engaged Baskervill who is working with historians and descendants of the cemetery, most notably Lenora McQueen, to design a commemorative place.

The estimated construction cost is \$1,800,000.

# THE SHOCKOE PROJECT: Shockoe Hill Burial Ground

LAND USE, HOUSING & TRANSPORTATION COUNCIL COMMITTEE MEETING

April 22, 2025

PRESENTED BY: SHARON L. EBERT, DEPUTY CAO, FOR PLANNING AND ECONOMIC DEVELOPMENT







**The National Slavery Museum has been a project of Delegate McQuinn, Ben Campbell and Sylvester Turner for more than 20 years. Their dedication created the National Slavery Museum Foundation.**

**The City is working with Baskervill to create a separate parcel for the Museum that the City is planning to convey to the Foundation as they work to raise funds for the design and construction of the Museum. The current estimate for the construction of the Museum is over \$100,000,000.**

**The rendering of the Museum has been created by Baskervill, to ensure that the footprint of the building and its surrounding landscaping works in harmony with the rest of the Campus, including the needed stormwater and floodway management infrastructure that is needed to protect the site.**

# **THE SHOCKOE PROJECT: National Slavery Museum**

**LAND USE, HOUSING & TRANSPORTATION COUNCIL COMMITTEE MEETING**

**April 22, 2025**

**PRESENTED BY: SHARON L. EBERT, DEPUTY CAO, FOR PLANNING AND ECONOMIC DEVELOPMENT**





# THE SHOCKOE PROJECT: QUESTIONS?

LAND USE, HOUSING & TRANSPORTATION COUNCIL COMMITTEE MEETING

April 22, 2025

PRESENTED BY: SHARON L. EBERT, DEPUTY CAO, FOR PLANNING AND ECONOMIC DEVELOPMENT

