

1201 & 1201 1/2 N 31ST ST

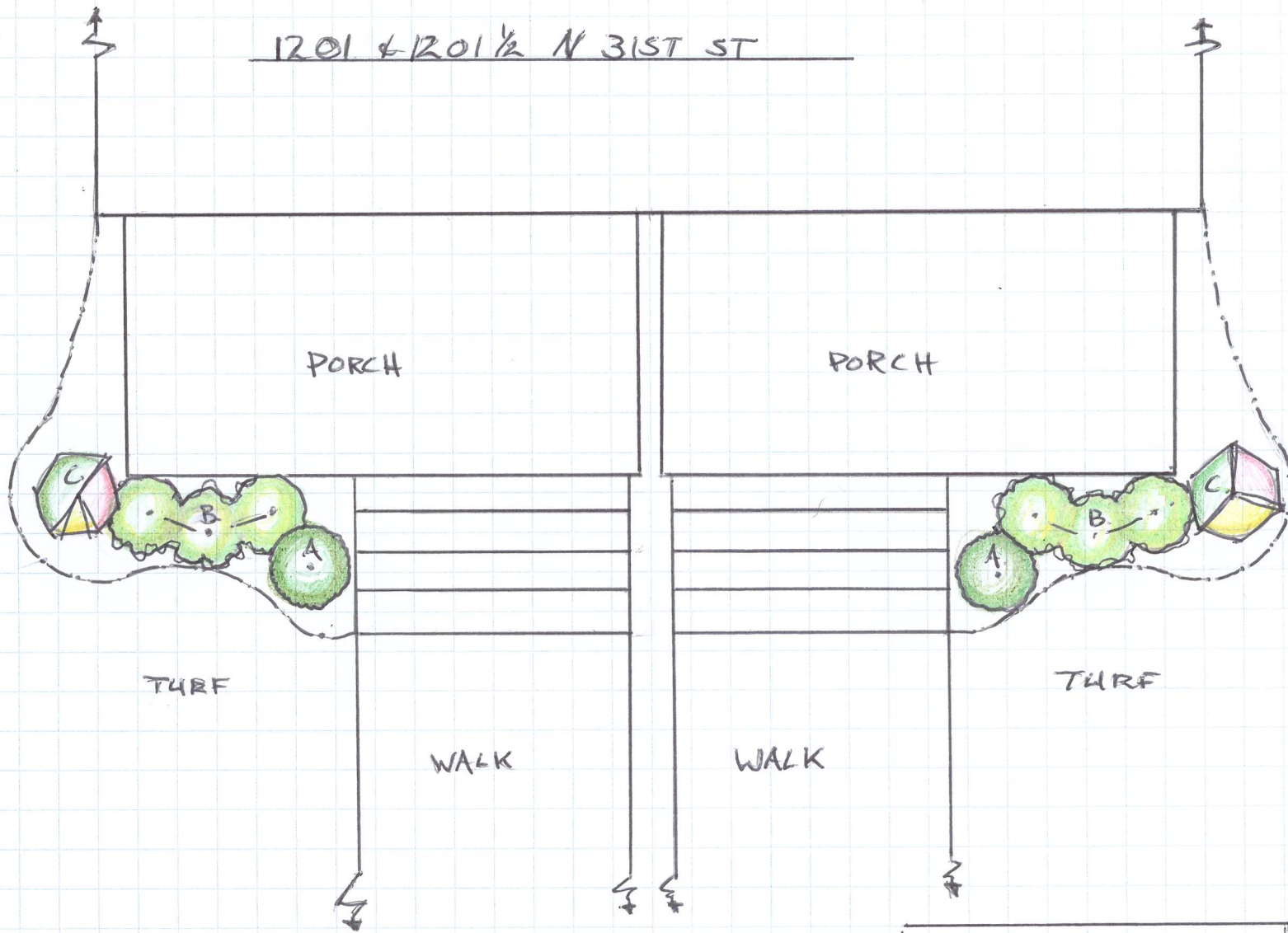

KEY: SHRUBS

	QTY	SIZE
A. STEEDS HOLLY	2	3 gal.
B. ABELIA 'RADIANCE'	6	3 gal.
C. NANDINA 'GULF STREAM'	2	5 gal.

PROJECT:

1201 & 1201 1/2 N 31ST ST.

DATE:

11/19

PLANTING PLAN

SCALE 1/4" = 1'

CLIENT:

CENTER CREEK HOMES

DESIGN:

GARDEN KEEPERS, LTD

P.O. BOX 17852

RICHMOND, VA 23226