

This is to certify that on 6/26/19
 I made an accurate field survey of the known premises shown hereon; that all improvements known or visible are shown hereon; that there are no encroachments by improvements either from adjoining premises, or from subject premises upon adjoining premises, other than shown hereon.

NOTE: THIS LOT APPEARS TO BE IN FEMA FLOOD ZONE X AS SHOWN ON HUD COMMUNITY PANEL NUMBERS 5101290041E

NOTE: This survey has been prepared without the benefit of a title report and does not therefore necessarily indicate all encumbrances on the property.

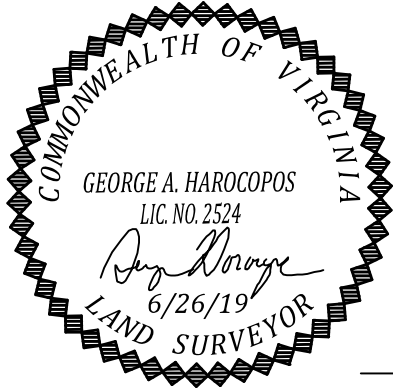

Subject Parcel Informationn

E0000513006
 3517.90 Sq. Feet
 0.081 Acres

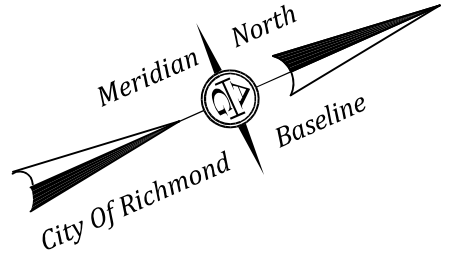

P&T T

Alley

(2) 9' X 17.5' Parking Spaces

LEGEND

- Rod/S
- Rod/F
- ⊕ Power Pole
- ⊕ Super Can
- ⊗ HVAC

E0000513007
 Solomons Temple Church
 ID 9700-0860

12' X 35' Construction Ent.

E0000513005
 Shawn Samuel Harris
 ID 2014-1947

Proposed Silt Fence & Limits Of Disturbance
 3205.87 Sq. Feet

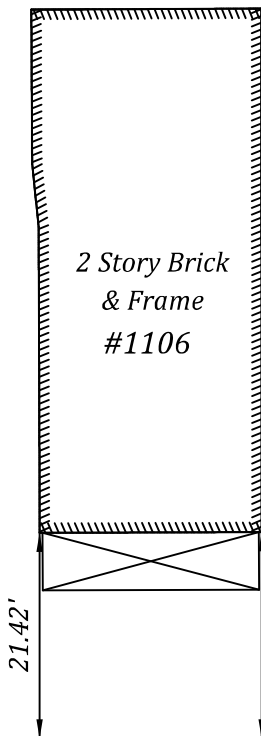

2 Story Brick & Frame #1106

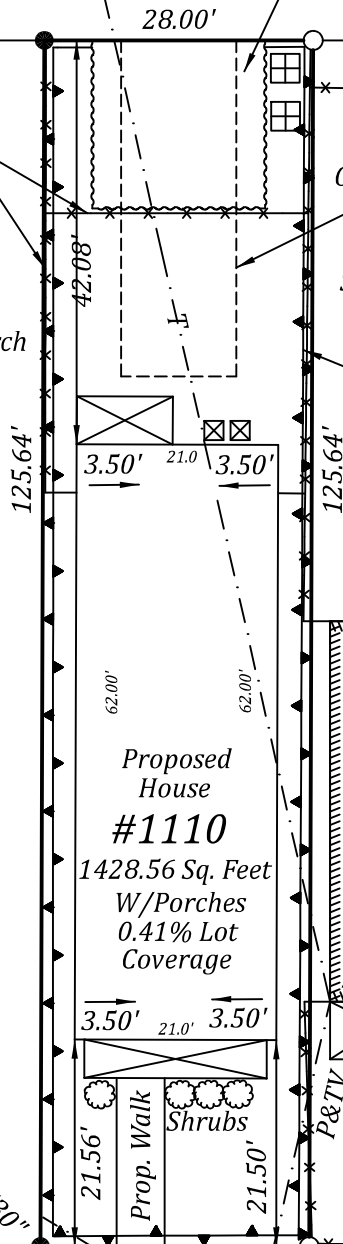

Proposed House #1110
 1428.56 Sq. Feet
 W/Porches
 0.41% Lot Coverage

2 Story Vinyl #1112

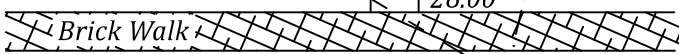

Brick Walk
 Conc Curb

143.00' To The S/L Of "R" Street

N. 20th STREET

SURVEY OF
 LOT AND IMPROVEMENTS THEREON LOCATED AT

JN 48635

#1110 N. 20th STREET

RICHMOND, VIRGINIA

A. G. HAROCOPOS & ASSOCIATES, P.C.

CERTIFIED LAND SURVEYOR AND CONSULTANT

4920 E. MILLRIDGE PKWY. SUITE 200 MIDLOTHIAN VA. 23112

Office 804 744 2630 FAX 804 744 2632

E-MAIL AGHAROCOPOS72@GMAIL.COM

NOTE: PLAT PREPARED FOR THE EXCLUSIVE USE OF THE CONVEYANCE TO BRYAN TRAYLOR

Scale 1"=20' Date 6/26/19 Drawn by GAH