

SIGNTYPES KEY			
D	Donor Identification	P	Pedestrian Directional
E	Exhibit (Interpretive)	R	Regulatory
G	Gateway	RE	Restroom
M	Free Standing Map		

BROWN'S ISLAND

PROGRAMMING Section 8

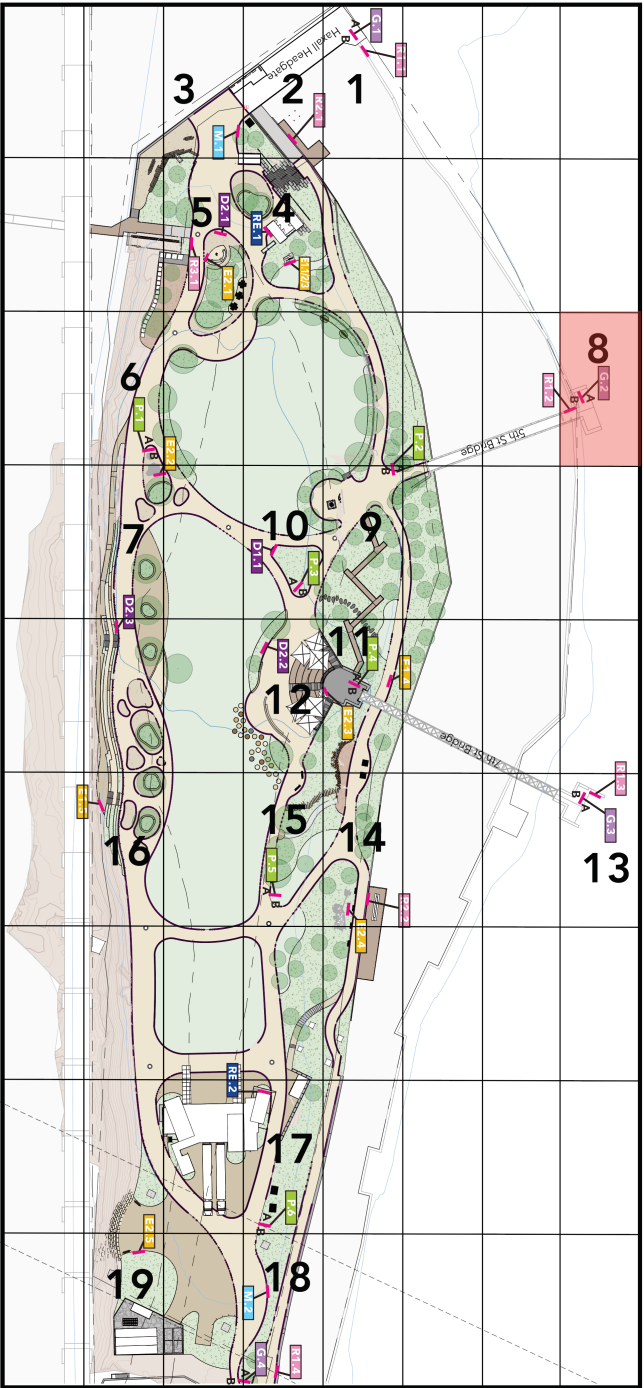

Date 6.3.25	Revisions 6.9.25 6.11.25	Scale NTS
----------------	--------------------------------	--------------



Sign Type G.2 - Side A
Gateway Sign

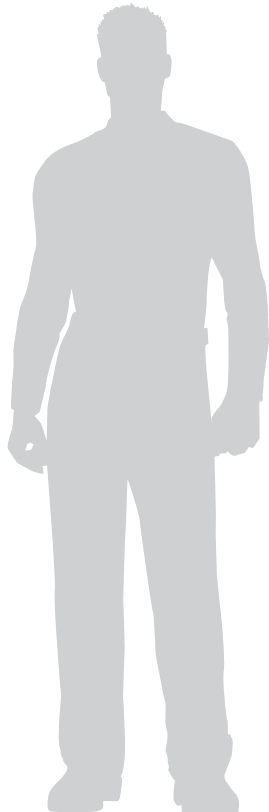

Sign Type G.2 - Side B
Gateway Sign



Sign Type R1.2
Regulatory General

Date 6.3.25	Revisions 6.9.25	Scale 3/4" = 1'
Client/Project Brown's Island Wayfinding		14

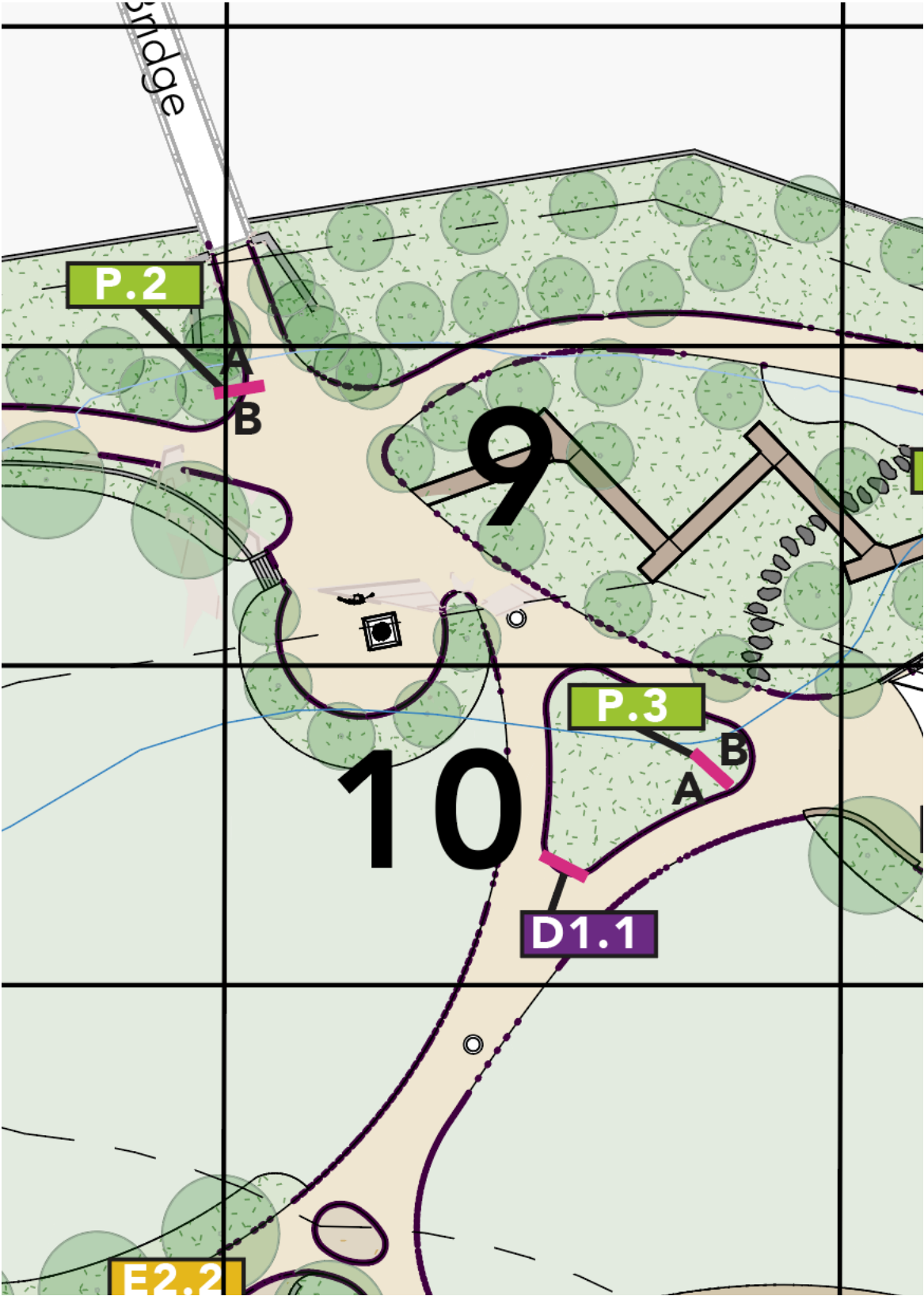

SIGNTYPES KEY			
D	Donor Identification	P	Pedestrian Directional
E	Exhibit (Interpretive)	R	Regulatory
G	Gateway	RE	Restroom
M	Free Standing Map		

BROWN'S ISLAND

PROGRAMMING Sections 9 -10

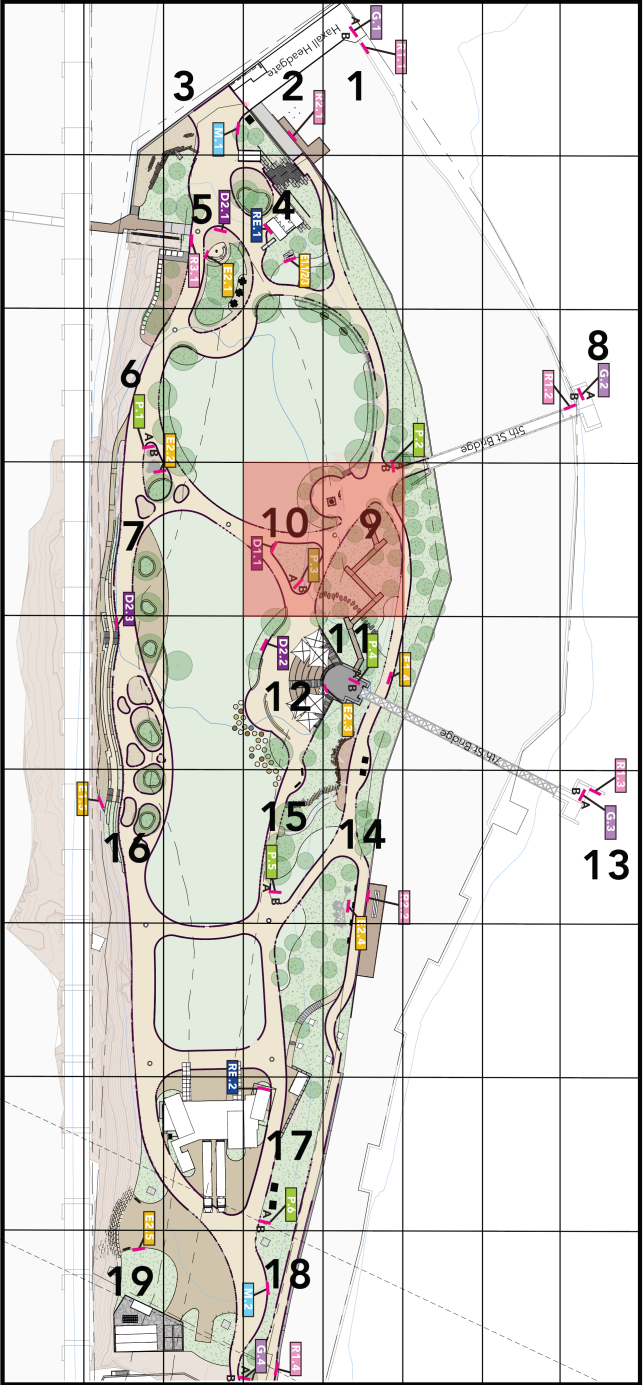

Date 6.3.25	Revisions 6.9.25 6.11.25	Scale NTS
----------------	--------------------------------	--------------

Client/Project
Brown's Island
Wayfinding

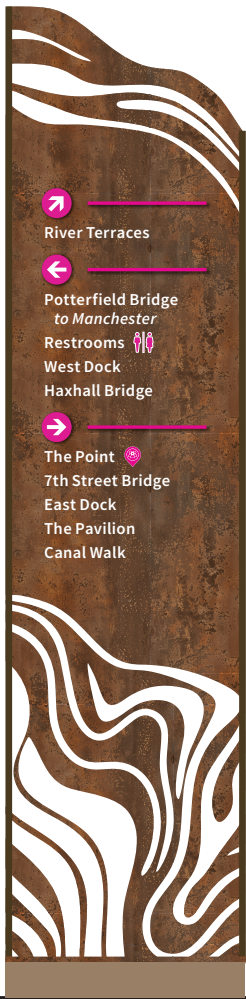

Sign Type P.2 - Side A
Pedestrian Directional

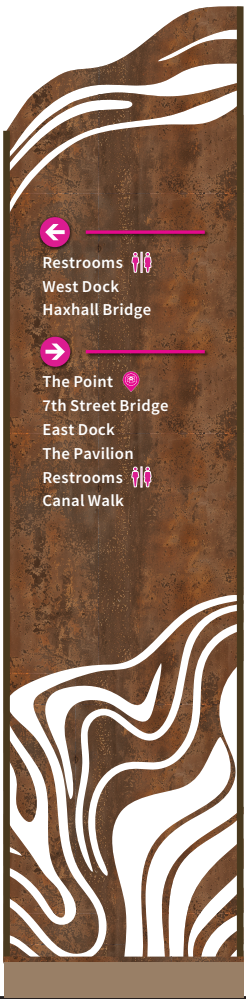

Sign Type P.2 - Side B
Pedestrian Directional

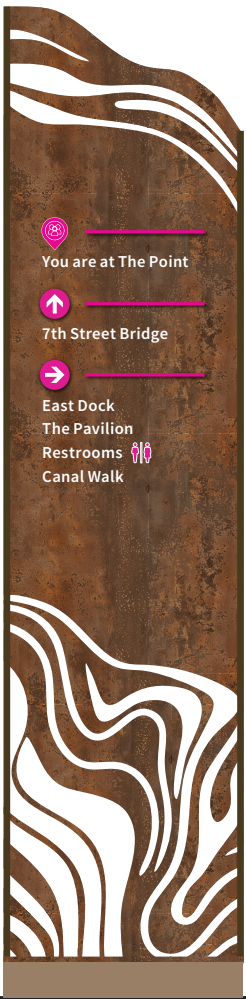
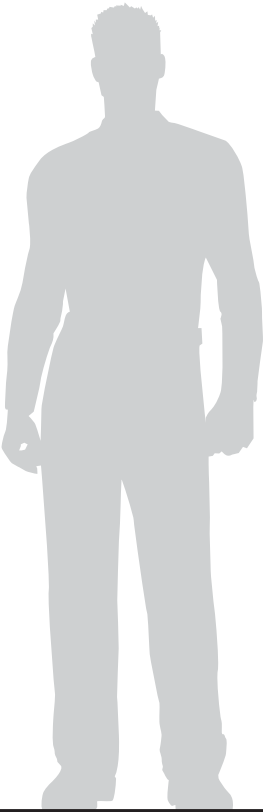

Sign Type P.3 - Side A
Pedestrian Directional



Sign Type P.3 - Side B
Pedestrian Directional

Date 6.3.25	Revisions 6.9.25	Scale 3/4" = 1'
Client/Project Brown's Island Wayfinding		16

FINAL LAYOUT TBD

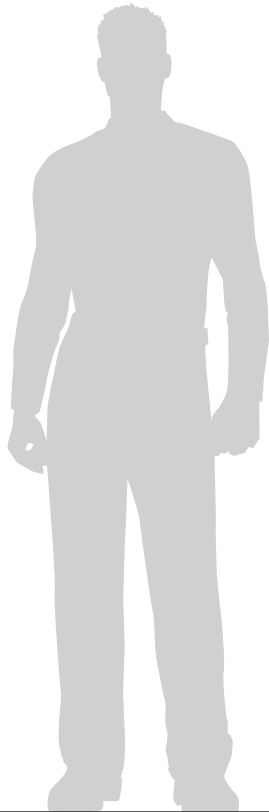

PLATINIUM DONORS

Donor A

Donor B

Donor C

Donor D

Venture Richmond, and the City of Richmond, would like to thank all of our supporters that brought this vision for Brown's Island to life.

GOLD DONORS

Avayah Duran

Ismael Ibarra

Madilynn Sharp

Royce Swanson

Helen Dyer

Atreus Duran

Willa Dominguez

Kaden Clements

Cara Cline

Cullen Rogers

Madelyn Gray

Nicholas Weeks

Karen Sullivan

Evan Curtis

Alexis Schultz

Cody Quintana

Kenia Miller

Benjamin O'Connor

Charli Noble

Idris Cervantes

SILVER DONORS

Adriel Hayes

Iris Hines

Uriel Acevedo

Ashlynn Richardson

Robert Cervantes

Aylin Roach

Caspian Gross

Angel Casey

Armando Camacho

Armani Graham

Giovanni Lamb

Amalia Maldonado

Javier Madden

Violette Burgess

Johnny Crane

Kolton Horton

Aitana Hartman

Baker Tate

Skye Trevino

Jaime Harrington

Legacy Eaton

Leighton Bonilla

Romina Bell

Emmett Stokes

Miranda Ruiz

Austin Knox

Kallie Stark

Kristopher Contreras

Daniela Truong

Ayan Boyer

Chaya Sparks

Drake Cantu

Galilea Byrd

Cristian McDonald

Daisy Gallegos

Jonas Fernandez

Amara Palacios

Thaddeus Wolfe

Hallie Burgess

Kolton Mason

Siemma Lyons

Cyrus Mosley

Zaniyah Erickson

Johnny Crane

Della Santana

Mohamed Tanner

Harmoni Pearson

Gunner Spence

Aislinn Faulkner

Jabari Hall

Leah Schroeder

Izaliah Chan

Hattie Charles

Amalia Maldonado

Javier Madden

Violette Burgess

Kolton Horton

Aitana Hartman

Baker Tate

BRONZE DONORS

Adriel Hayes

Iris Hines

Uriel Acevedo

Ashlynn Richardson

Robert Cervantes

Aylin Roach

Caspian Gross

Angel Casey

Armando Camacho

Armani Graham

Giovanni Lamb

Amalia Maldonado

Javier Madden

Violette Burgess

Kolton Horton

Aitana Hartman

Baker Tate

Skye Trevino

Jaime Harrington

Legacy Eaton

Leighton Bonilla

Romina Bell

Emmett Stokes

Miranda Ruiz

Austin Knox

Kallie Stark

Kristopher Contreras

Daniela Truong

Ayan Boyer

Sign Type D1.1
Multiple Donors Sign

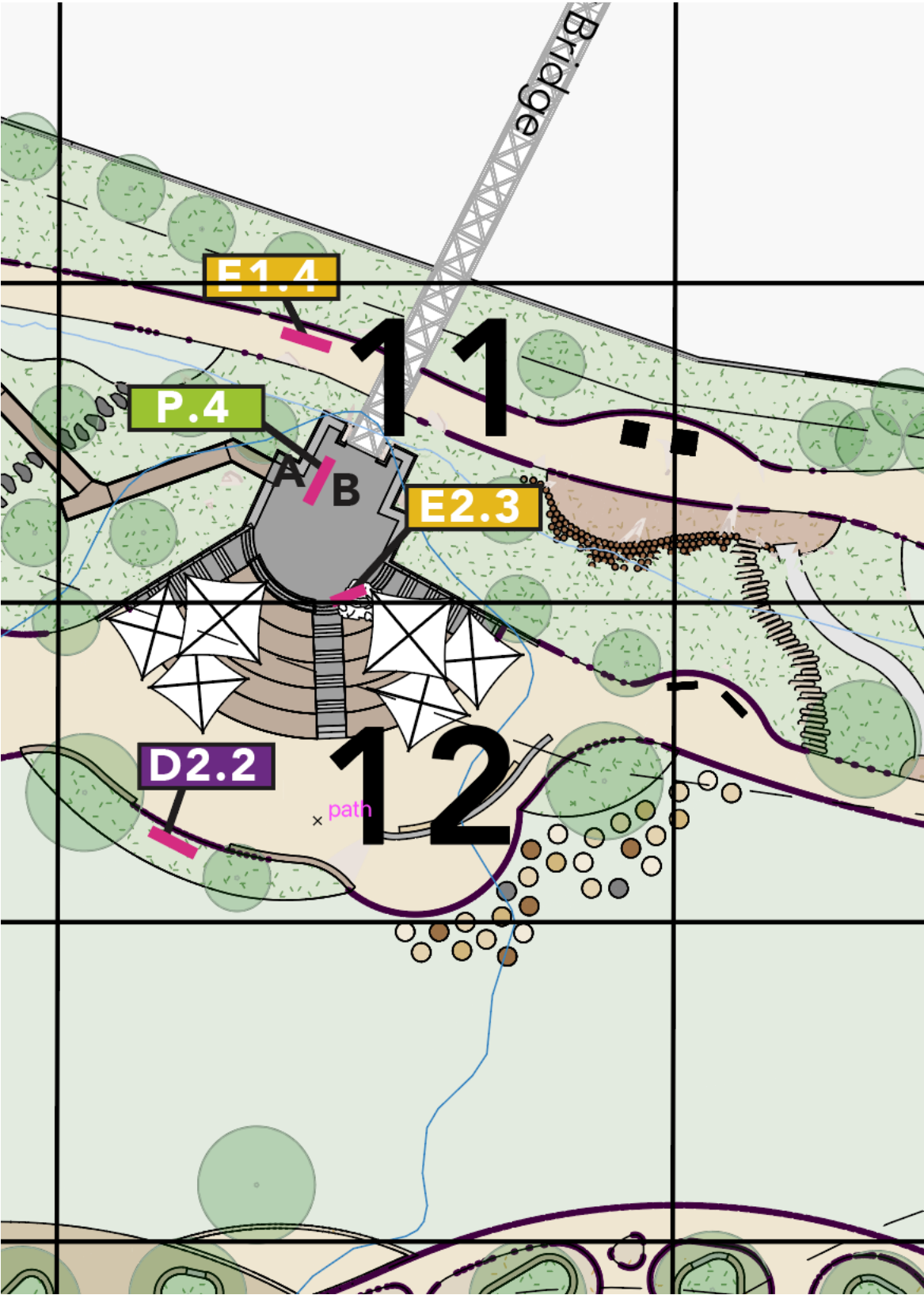

SIGNTYPES KEY			
D	Donor Identification	P	Pedestrian Directional
E	Exhibit (Interpretive)	R	Regulatory
G	Gateway	RE	Restroom
M	Free Standing Map		

BROWN'S ISLAND

PROGRAMMING Sections 11 - 12

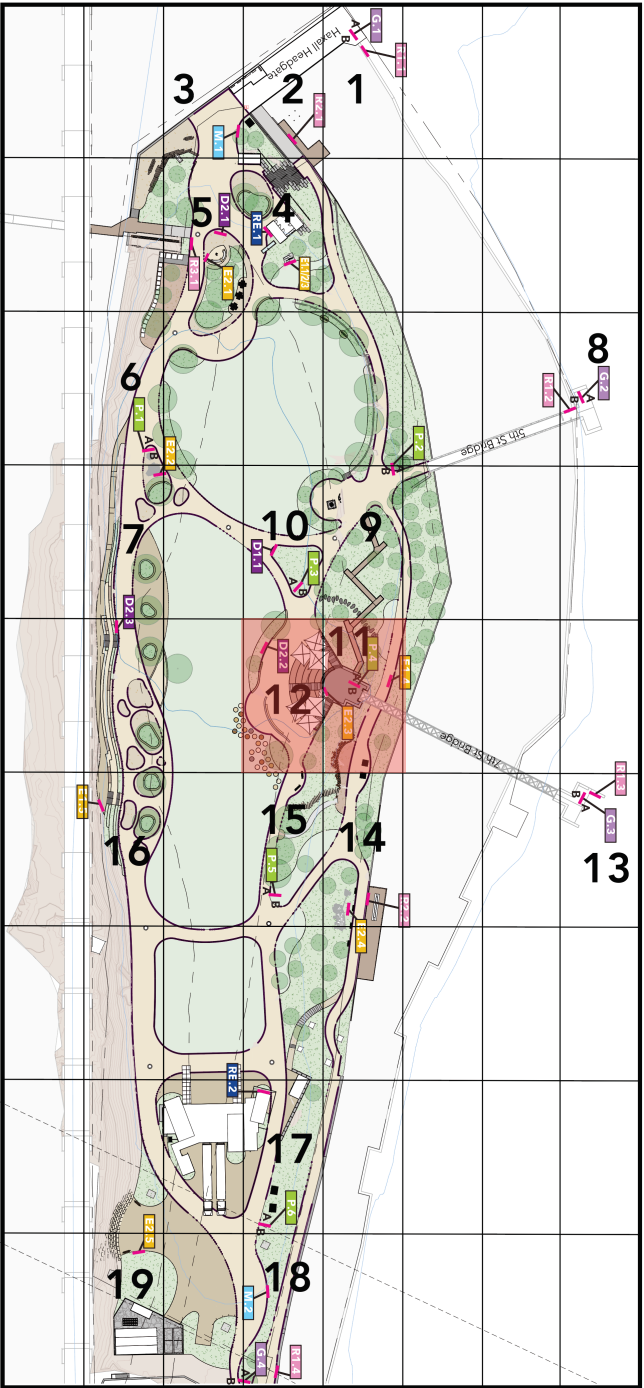

Date 6.3.25	Revisions 6.9.25 6.11.25	Scale NTS
----------------	--------------------------------	--------------



Date	Revisions	Scale
6.3.25	6.9.25 6.11.25	3/4" = 1'

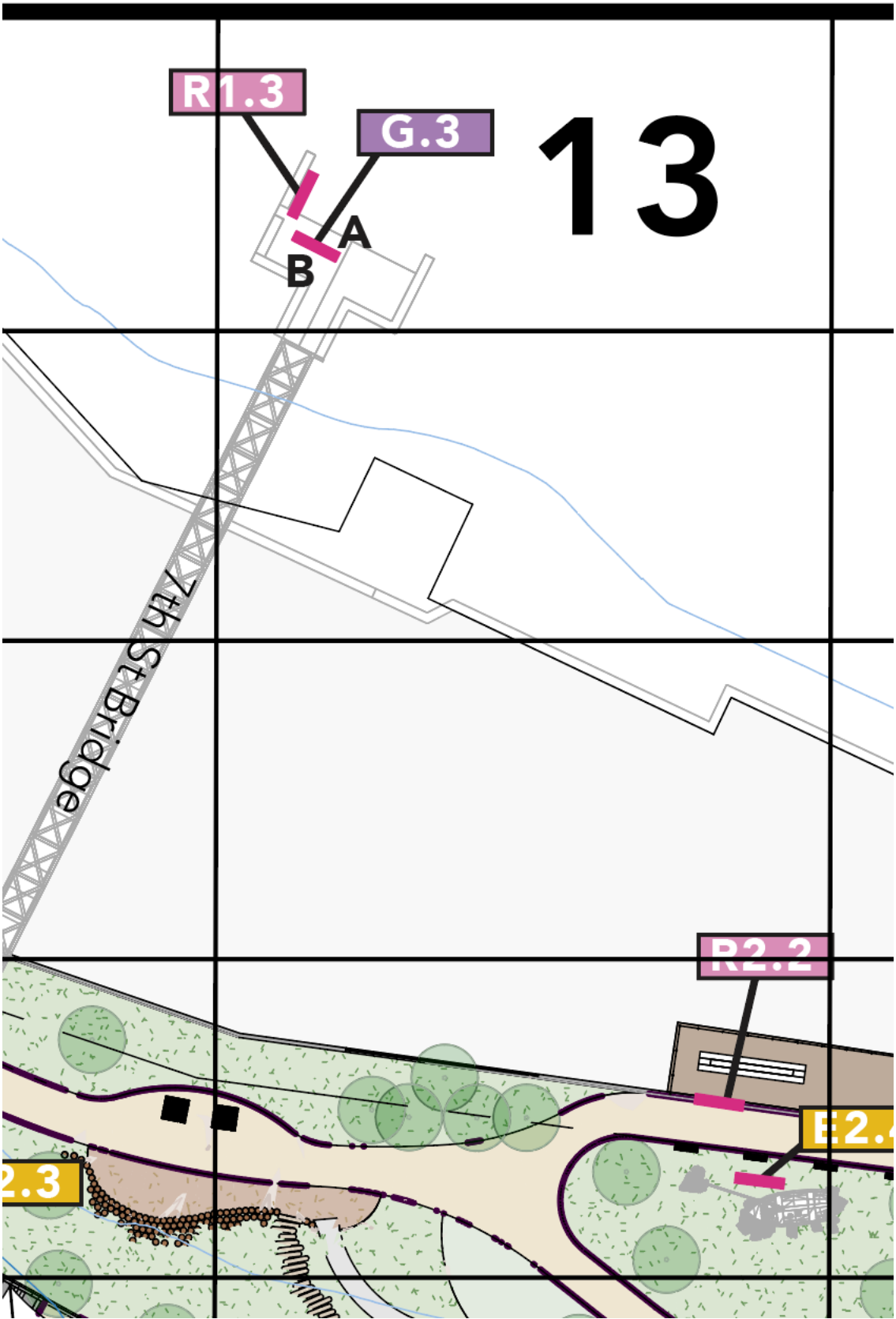

SIGNTYPES KEY			
<div>D</div>	Donor Identification	<div>P</div>	Pedestrian Directional
<div>E</div>	Exhibit (Interpretive)	<div>R</div>	Regulatory
<div>G</div>	Gateway	<div>RE</div>	Restroom
<div>M</div>	Free Standing Map		

BROWN'S ISLAND

PROGRAMMING Section 13

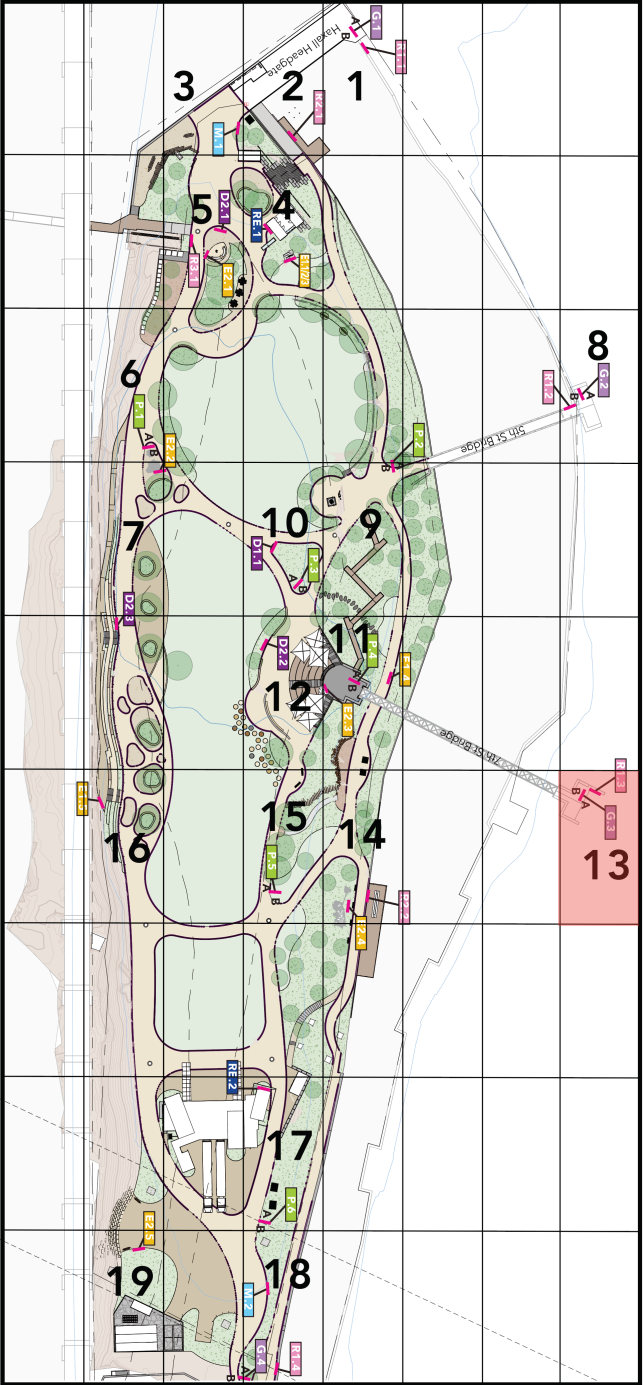

Date 6.3.25	Revisions 6.9.25 6.11.25	Scale NTS
Client/Project Brown's Island Wayfinding		20



Sign Type G.3 - Side A
Gateway Sign

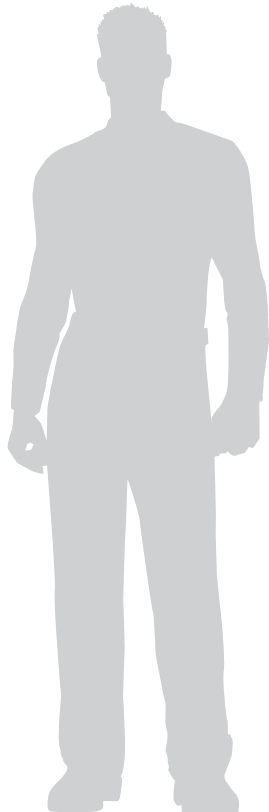

Sign Type G.3 - Side B
Gateway Sign



Sign Type R1.3
Regulatory General

Date	Revisions	Scale
6.3.25	6.9.25 6.11.25	3/4" = 1'

Client/Project
Brown's Island
Wayfinding

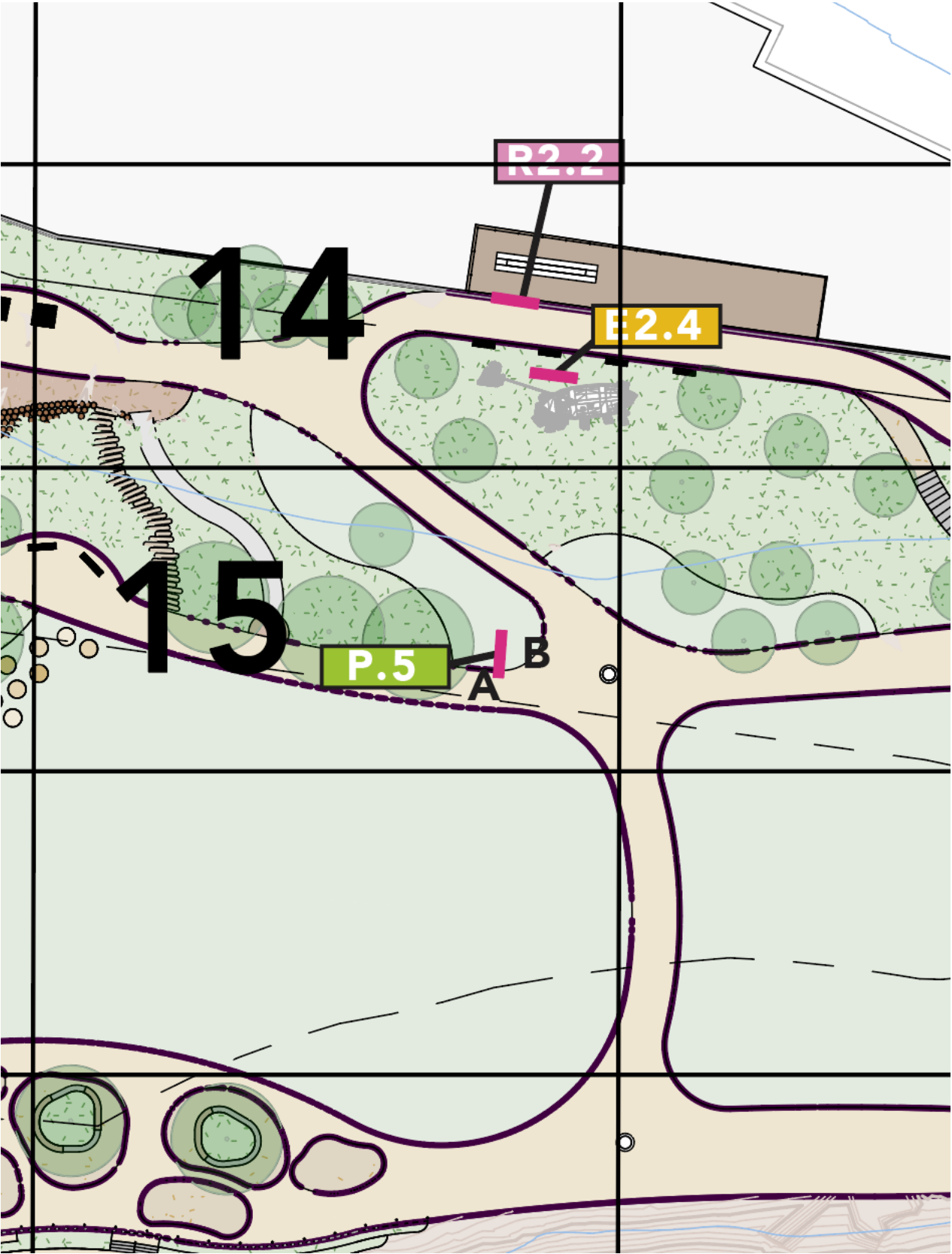

SIGNTYPES KEY			
D	Donor Identification	P	Pedestrian Directional
E	Exhibit (Interpretive)	R	Regulatory
G	Gateway	RE	Restroom
M	Free Standing Map		

BROWN'S ISLAND

PROGRAMMING Sections 14 -15

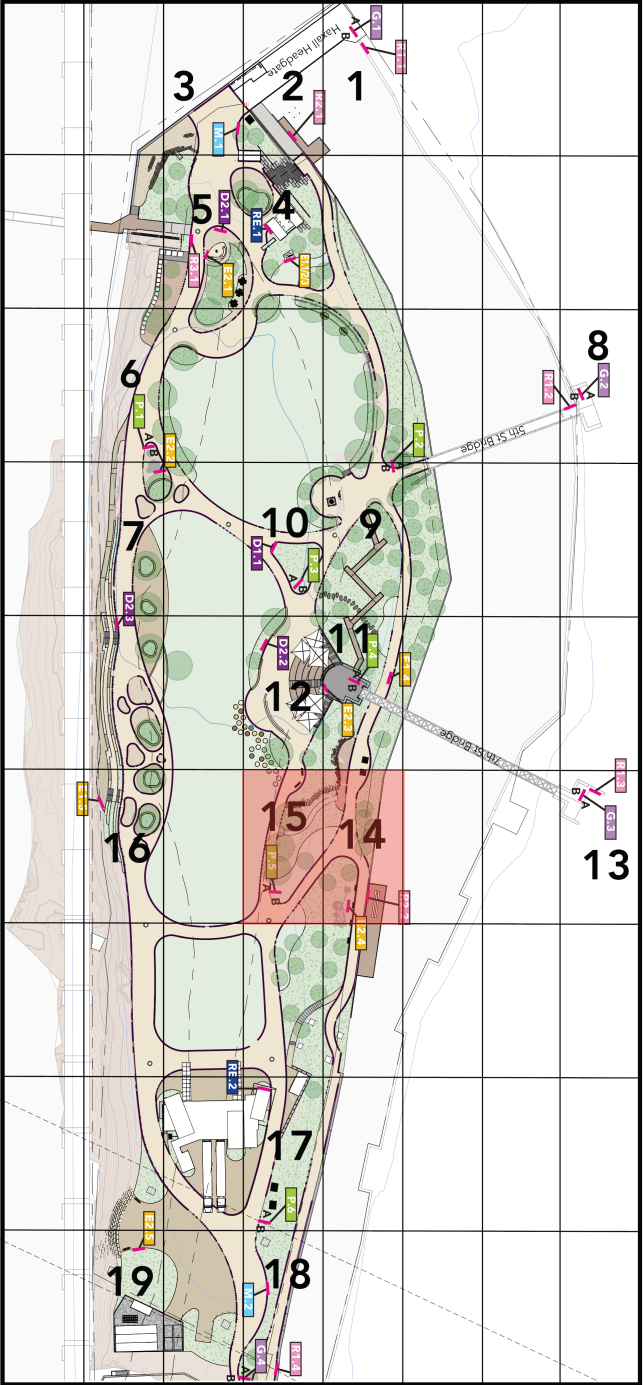

Date 6.3.25	Revisions 6.9.25 6.11.25	Scale NTS
----------------	--------------------------------	--------------

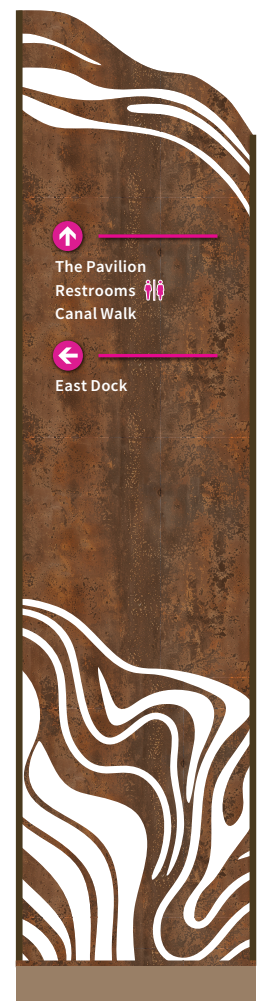

Sign Type P.5 - Side A
Pedestrian Directional



Sign Type P.5 - Side B
Pedestrian Directional

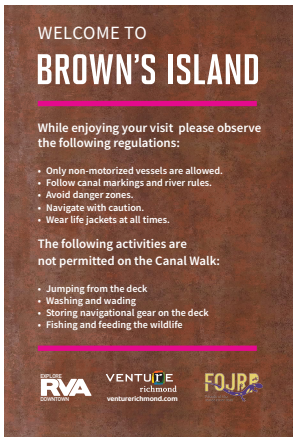
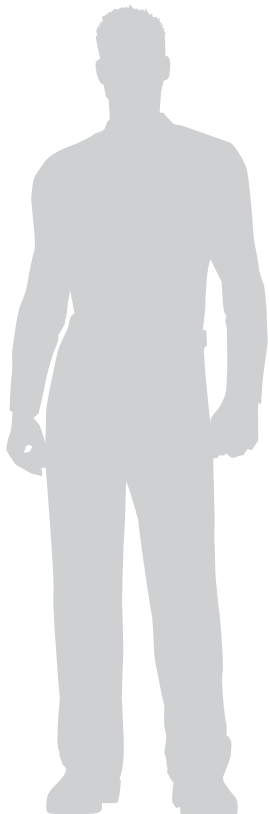

Sign Type R2.2
Regulatory on Deck

Headman sculpture sign
telling story of the piece,
and artist.

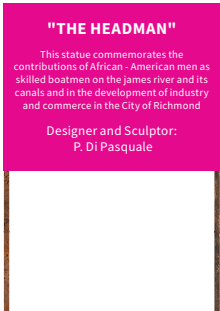

Sign Type E2.4
Exhibit/Artwork

SIDE VIEW



Date	Revisions	Scale
6.3.25	6.9.25 6.11.25	3/4" = 1'

Client/Project
Brown's Island
Wayfinding

BROWN'S ISLAND

PROGRAMMING Sections 16 - 17

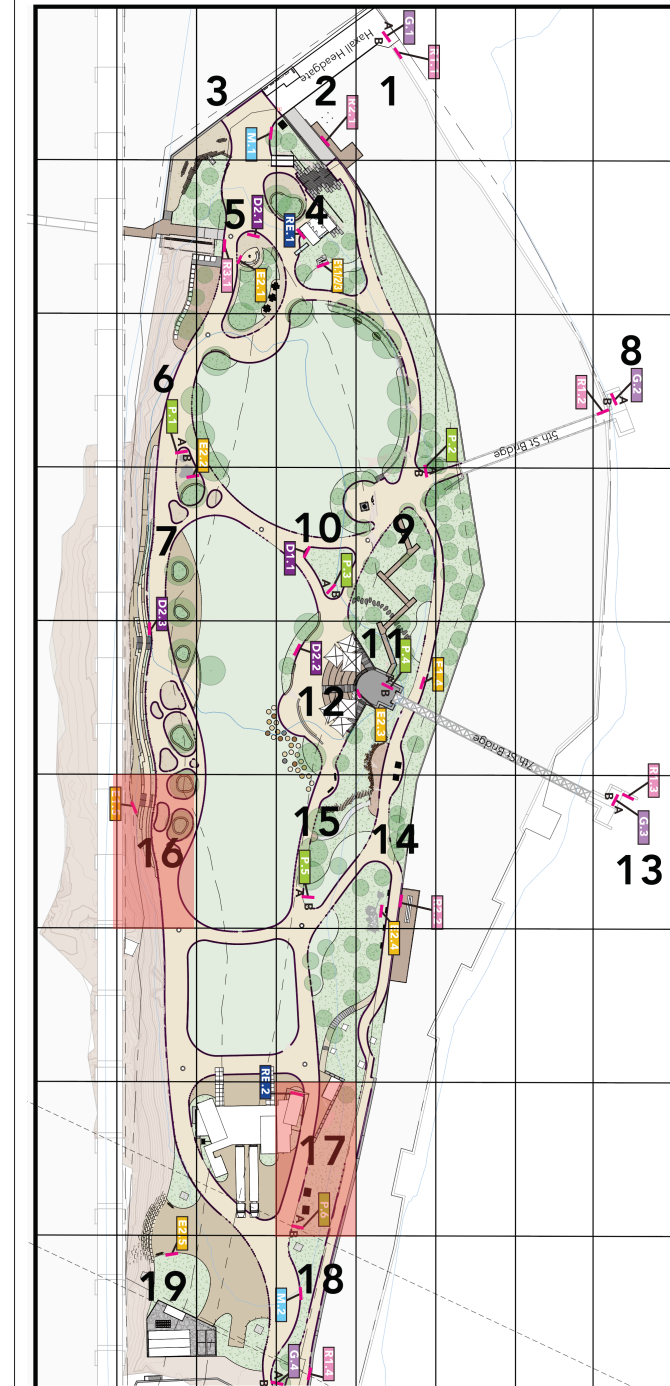
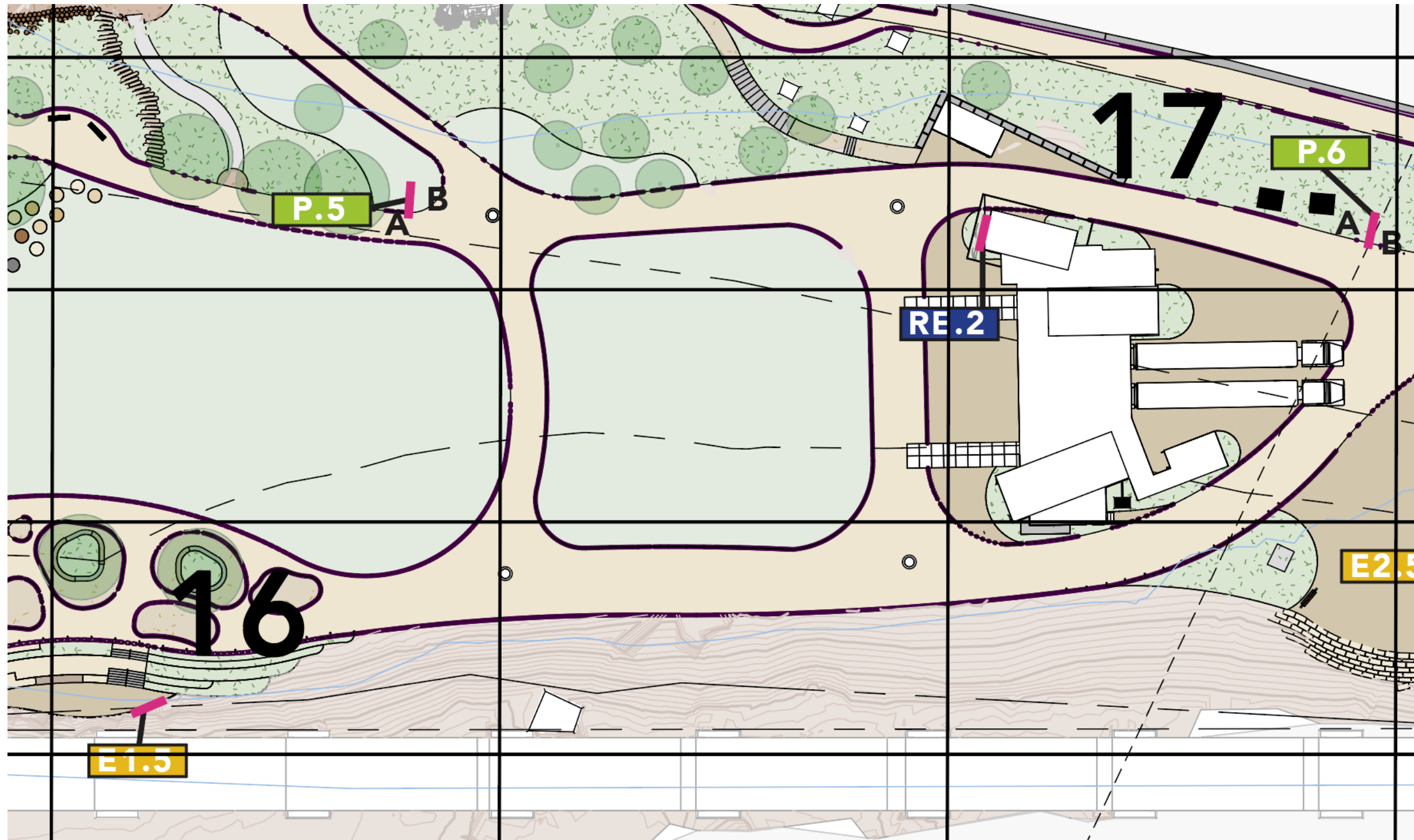

SIGNTYPES KEY

D Donor Identification	P Pedestrian Directional
E Exhibit (Interpretive)	R Regulatory
G Gateway	RE Restroom
M Free Standing Map	

Date
6.3.25

Revisions
6.9.25
6.11.25

Scale
NTS

BROWN'S ISLAND

PROGRAMMING
Sections 16 - 17

Sign about invasive plant species management and the river - would be attached to the railing. To include text and images.

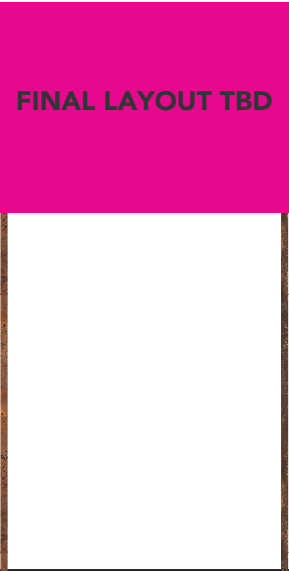

Sign Type E1.5
Exhibit/Interpretive

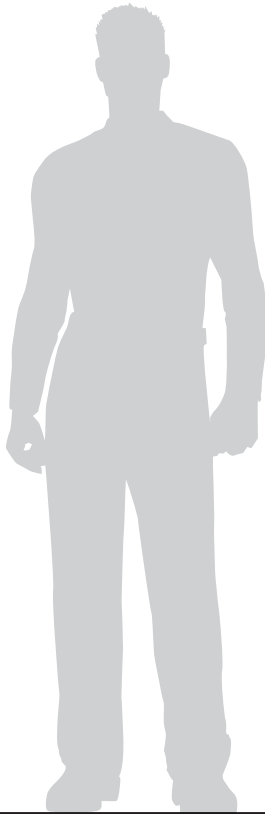

Sign Type P.6 - Side A
Pedestrian Directional

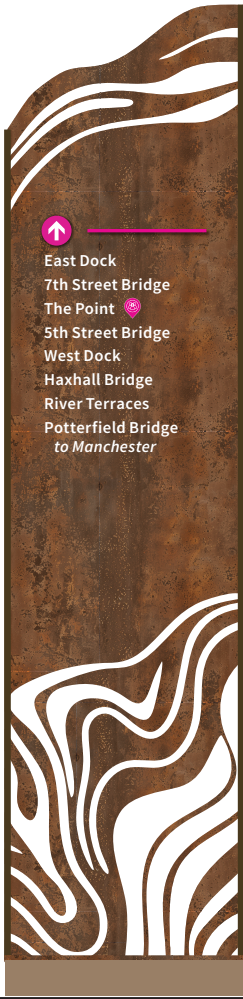

Sign Type P.6 - Side B
Pedestrian Directional

Date	Revisions	Scale
6.3.25	6.9.25	3/4" = 1'

Client/Project
Brown's Island
Wayfinding

One set to be applied to the east elevation
of the Pavilion attached building

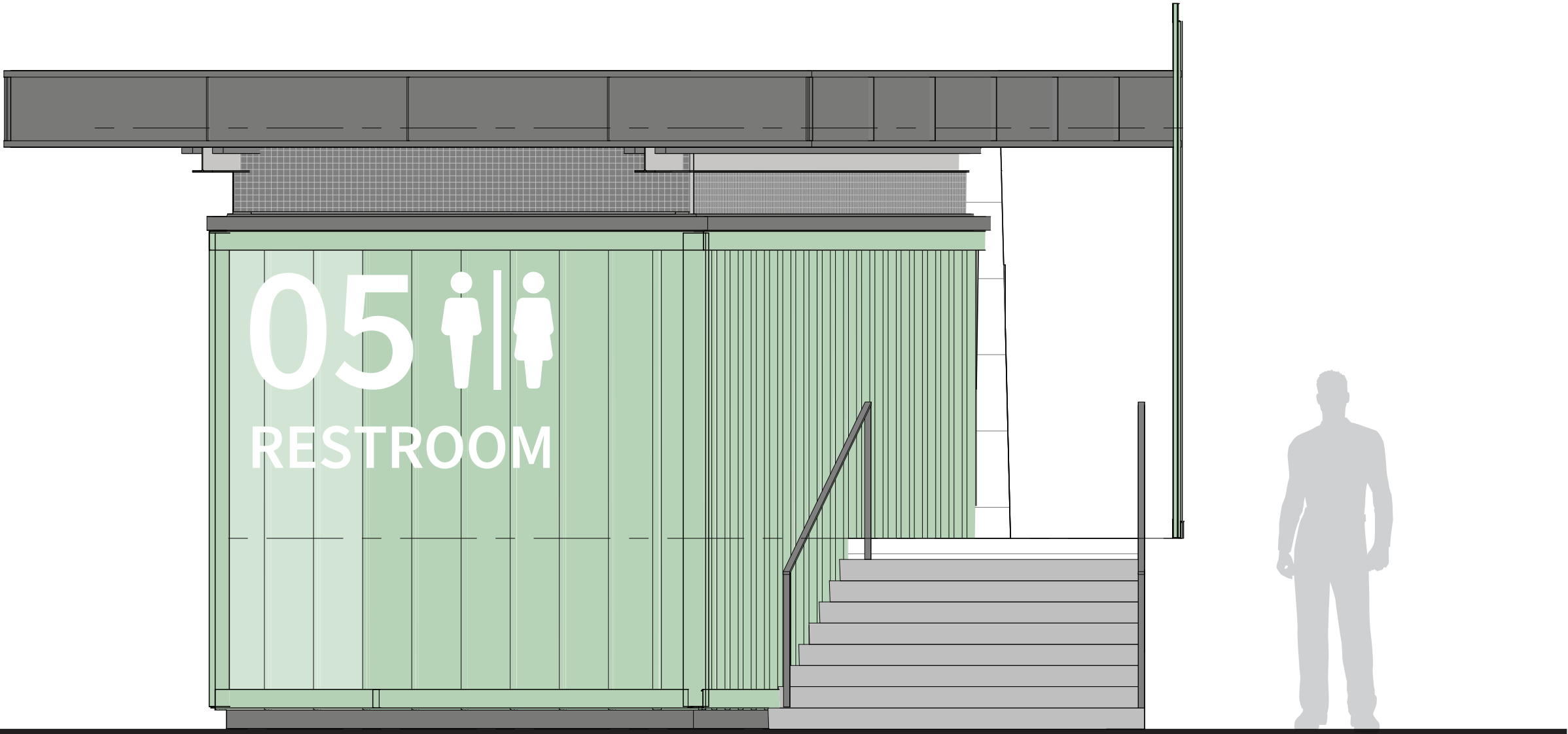

Sign Type RE.2
Restroom Vinyl Decals

Date 6.3.25	Revisions 6.9.25	Scale NTS
Client/Project Brown's Island Wayfinding		26

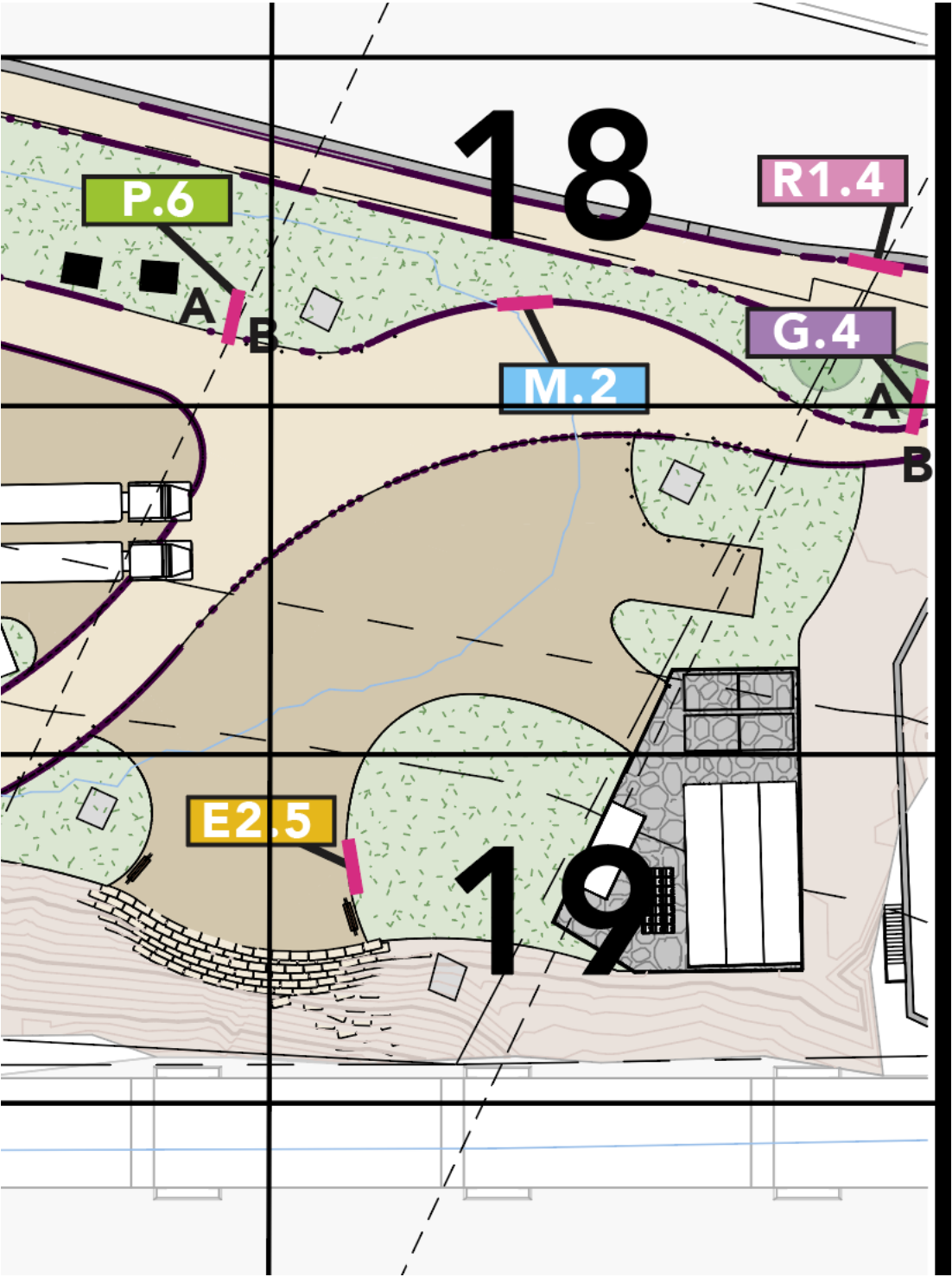

SIGNTYPES KEY

- | | |
|---------------------------------|---------------------------------|
| D Donor Identification | P Pedestrian Directional |
| E Exhibit (Interpretive) | R Regulatory |
| G Gateway | RE Restroom |
| M Free Standing Map | |

BROWN'S ISLAND

PROGRAMMING Sections 18 -19

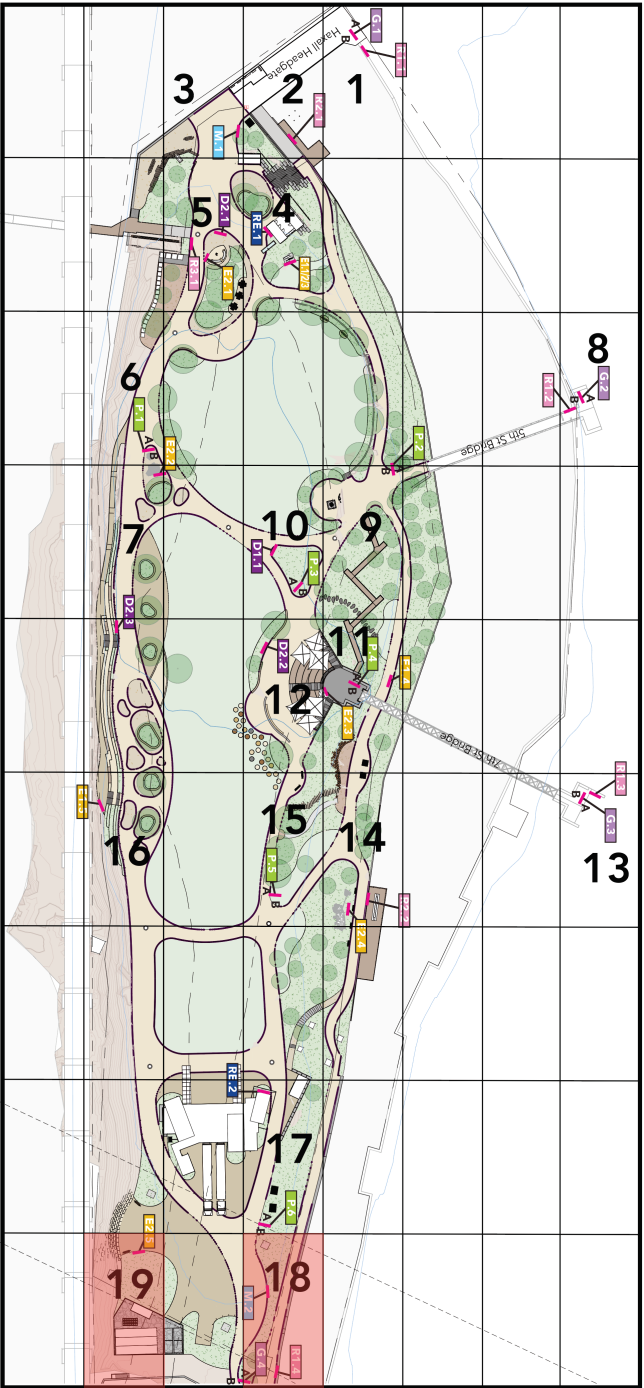

Date 6.3.25	Revisions 6.9.25 6.11.25	Scale NTS
----------------	--------------------------------	--------------

BROWN'S ISLAND

PROGRAMMING
Sections 18 -19

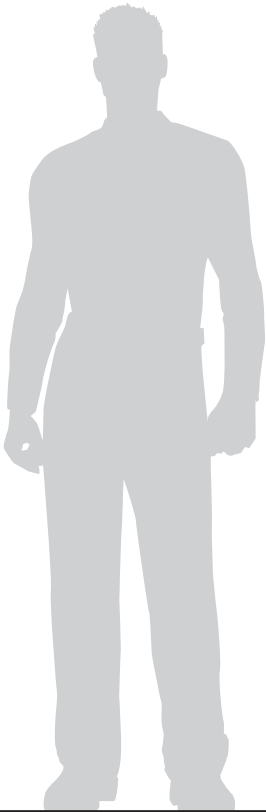

Sign Type M.2
Free Standing Map

Date 6.3.25	Revisions 6.9.25	Scale 3/4" = 1'
Client/Project Brown's Island Wayfinding		28



Sign Type R1.4
Regulatory General

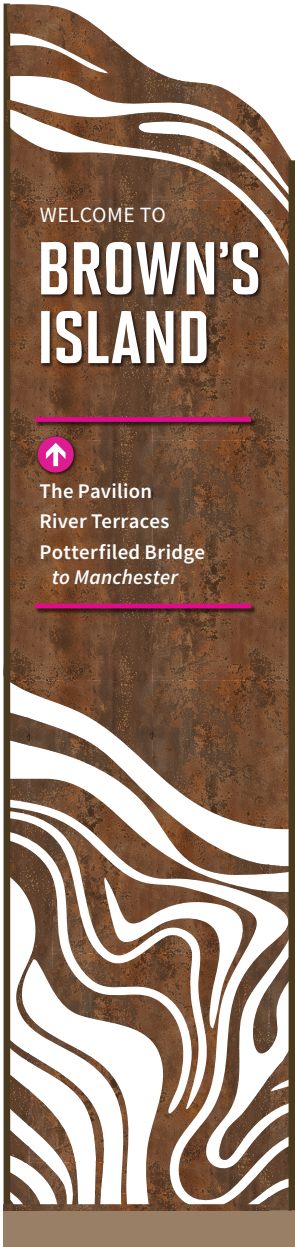

Sign Type G.4 - Side A
Gateway Sign



Sign Type G.4 - Side B
Gateway Sign

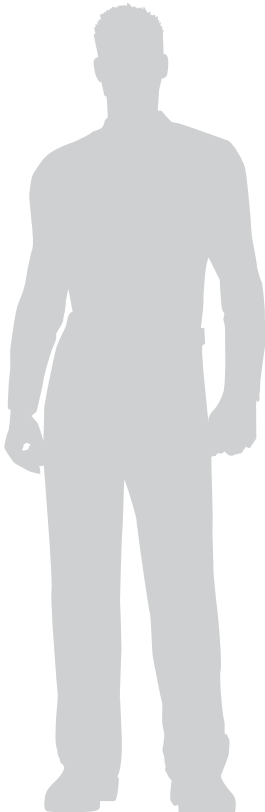

Sign about the art piece
(theme is native wildlife,
TBD) to include piece, and
artist information.

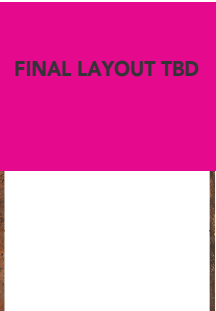

Sign Type E2.5
Exhibit/Interpretive

Date	Revisions	Scale
6.3.25	6.9.25 6.11.25	3/4" = 1'
Client/Project Brown's Island Wayfinding		