

Adjacent Property: 5801 Forest Hill Ave - C0050232010

# 5720 BLILEY ROAD CONCEPTUAL MASTER PLAN

9 SINGLE FAMILY DWELLINGS  
[(3) DETACHED & (6) ATTACHED (3 SETS OF 2)]

## DRAWING LIST

- A1 SITE LAYOUT
- A2 EXTERIOR ELEVATIONS
- A2.1 GARAGE ELEVATION
- A3 STREET PROFILES
- A4 ZONING NOTES

REVISIONS:  
8/9/2017 Comments Response  
7/31/2017 ROW Comments

J O H A N N A S D E S I G N G R O U P 1901 WEST CARY STREET RICHMOND, VA 23220 P 804.358.4993 F 804.358.8211

5720 BLILEY ROAD - CONDITIONAL REZONING APPLICATION

SHEET TITLE  
**SITE LAYOUT**

REVISED  
DATE  
**7/31/2017**

PROJECT NO.  
**1671**

SHEET NO.

# A1

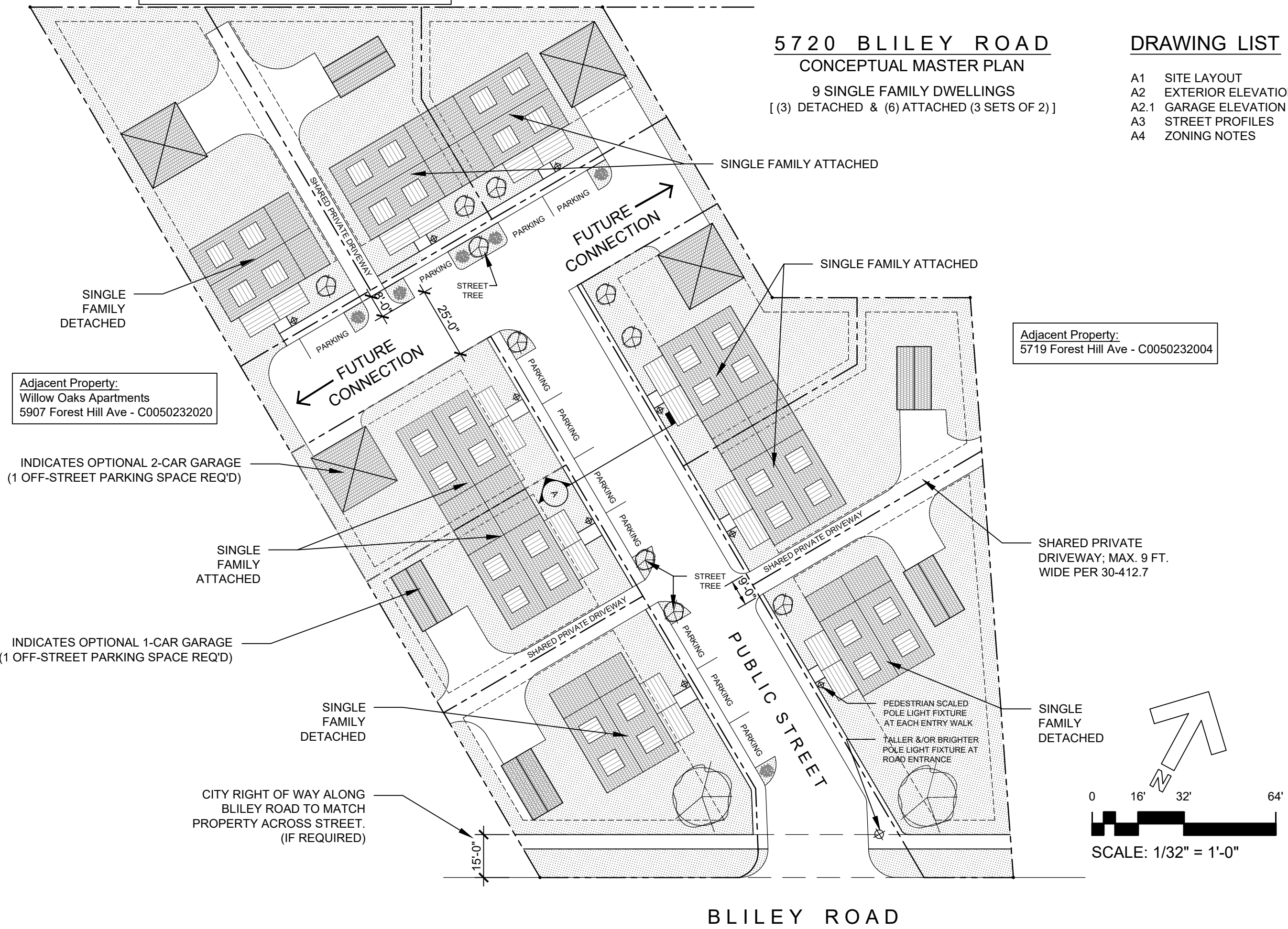

Adjacent Property:  
Willow Oaks Apartments  
5907 Forest Hill Ave - C0050232020

Adjacent Property:  
5719 Forest Hill Ave - C0050232004

INDICATES OPTIONAL 2-CAR GARAGE  
(1 OFF-STREET PARKING SPACE REQ'D)

INDICATES OPTIONAL 1-CAR GARAGE  
(1 OFF-STREET PARKING SPACE REQ'D)

CITY RIGHT OF WAY ALONG  
BLILEY ROAD TO MATCH  
PROPERTY ACROSS STREET.  
(IF REQUIRED)

SHARED PRIVATE  
DRIVEWAY; MAX. 9 FT.  
WIDE PER 30-412.7

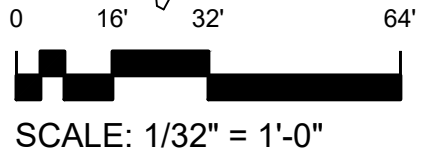

## BLILEY ROAD

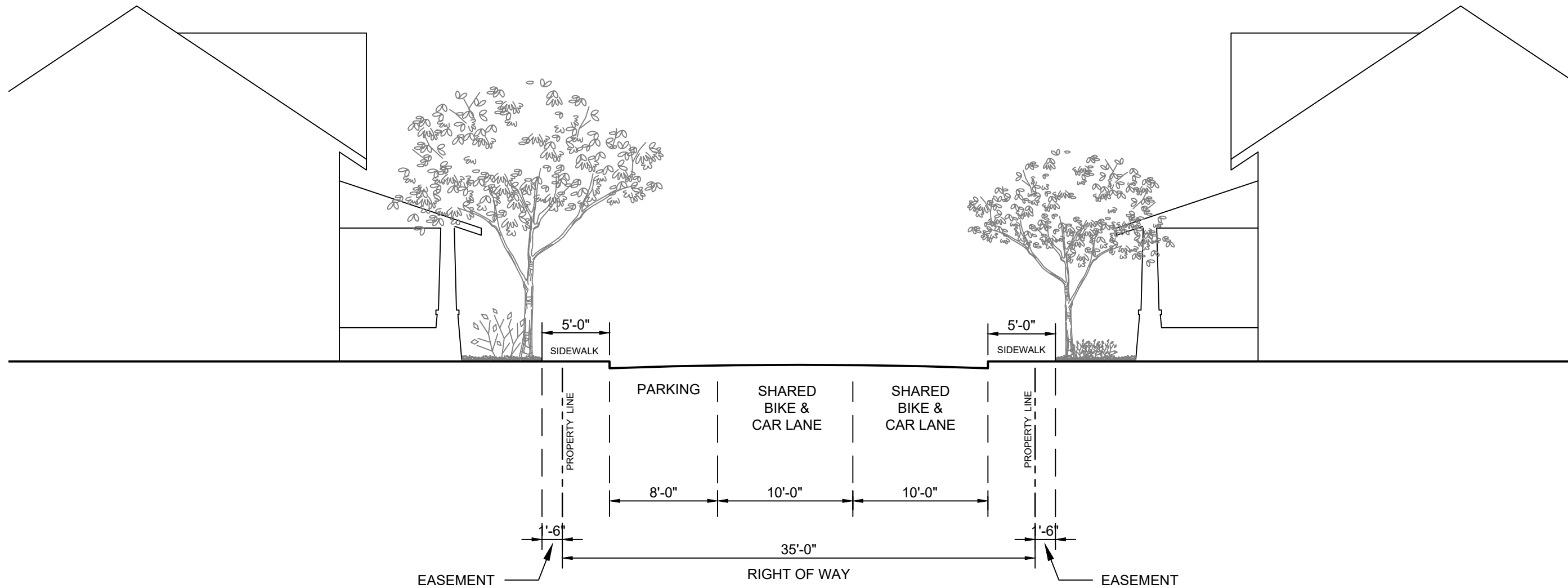

**SECTION 'A'**  
1/8" = 1'-0"

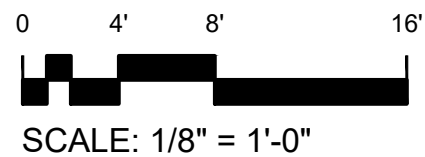

**REVISIONS**  
6/9/2017 Comments Response  
7/31/2017 ROW Comments

J O H A N N A S   D E S I G N   G R O U P   1901 WEST CARY STREET   R I C H M O N D ,   V A   23220   P 804.358.4993

5720 BLILEY ROAD - CONDITIONAL REZONING APPLICATION

SHEET TITLE  
STREET  
PROFILES  
REVISED  
DATE  
7/31/2017  
PROJECT NO.  
1671  
SHEET NO.

A3