



COMMISSION OF ARCHITECTURAL REVIEW

APPLICATION FOR CERTIFICATE OF APPROPRIATENESS

PROPERTY (location of work)

Address _____

Historic district _____

Date/time rec'd: _____
Rec'd by: _____
Application #: _____
Hearing date: _____

APPLICANT INFORMATION

Check if Billing Contact

Name _____

Phone _____

Company _____

Email _____

Mailing Address _____

Applicant Type: Owner Agent
 Lessee Architect Contractor
 Other (please specify): _____

OWNER INFORMATION (if different from above)

Check if Billing Contact

Name _____

Company _____

Mailing Address _____

Phone _____

Email _____

PROJECT INFORMATION

Project Type:

Alteration

Demolition

New Construction

(Conceptual Review Required)

Project Description: (attach additional sheets if needed)

ACKNOWLEDGEMENT OF RESPONSIBILITY

Compliance: If granted, you agree to comply with all conditions of the certificate of appropriateness (COA). Revisions to approved work require staff review and may require a new application and approval from the Commission of Architectural Review (CAR). Failure to comply with the conditions of the COA may result in project delays or legal action. The COA is valid for one (1) year and may be extended for an additional year, upon written request and payment of associated fee.

Requirements: A complete application includes all applicable information requested on checklists available on the CAR website to provide a complete and accurate description of existing and proposed conditions, as well as payment of the application fee. Applicants proposing major new construction, including additions, should meet with Staff to review the application and requirements prior to submitting an application. Owner contact information and signature is required. Late or incomplete applications will not be considered.

Zoning Requirements: Prior to Commission review, it is the responsibility of the applicant to determine if zoning approval is required and application materials should be prepared in compliance with zoning.

Signature of Owner _____

Date _____

 Proposed
car
port
location

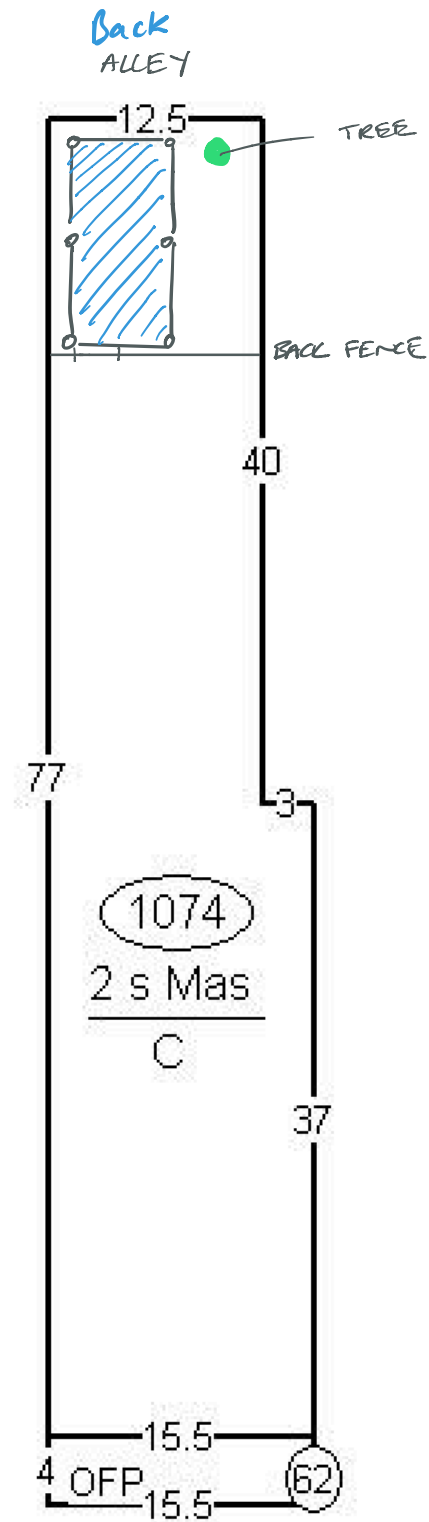

S W. clay St (Front)

Pictures of where the carport will be going. It will be up against the back fence and close against the tree.



HANOVER



19' x 10' Arch-Roof Carport

Rain, snow, UV rays, - protect your car from the elements with the all-weather Arch-Roof Carport by Hanover.

Constructed with the freedom of aluminum, it resists corrosion, with built-in drainage.

Stronger and more durable, it blocks harmful UV rays and will look stylish.

DIMENSIONS

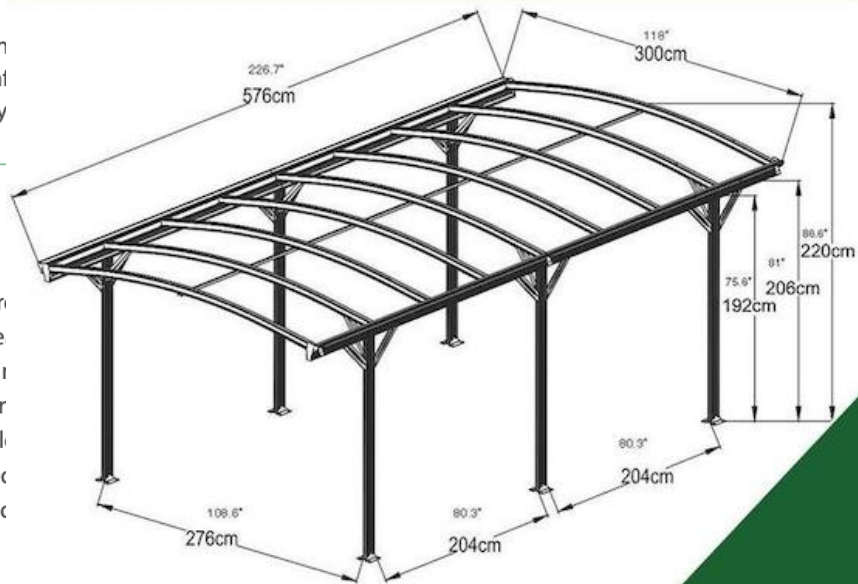

- Arch-roof
- All-weather
- Aluminum
- 6 structural
- Double
- Arch-roof
- Ribbed

19-FT X 10-FT ALUMINUM CARPORT