

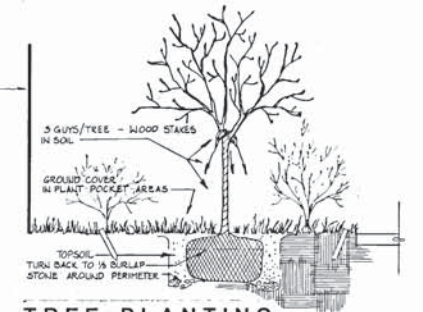

CITY OF RICHMOND  
**HULL STREET BRANCH LIBRARY**  
 HULL STREET AT WEST 14TH STREET, RICHMOND, VIRGINIA  
 HARDWICKE JOHNSON INC. - ARCHITECTS - ENGINEERS - PLANNERS - 2001 WILLARD ROAD, RICHMOND, VIRGINIA 23229

DATE: MAY 1, 1985  
 REVISION: AS BUILTS PER 1986  
 COMMISSION: 84015  
 DESIGNED BY: A.L.C.  
 DRAWN BY: S.H. & V.C.  
 CHECKED BY: A.L.C.  
 SHEET NUMBER: A-1  
 0-21345

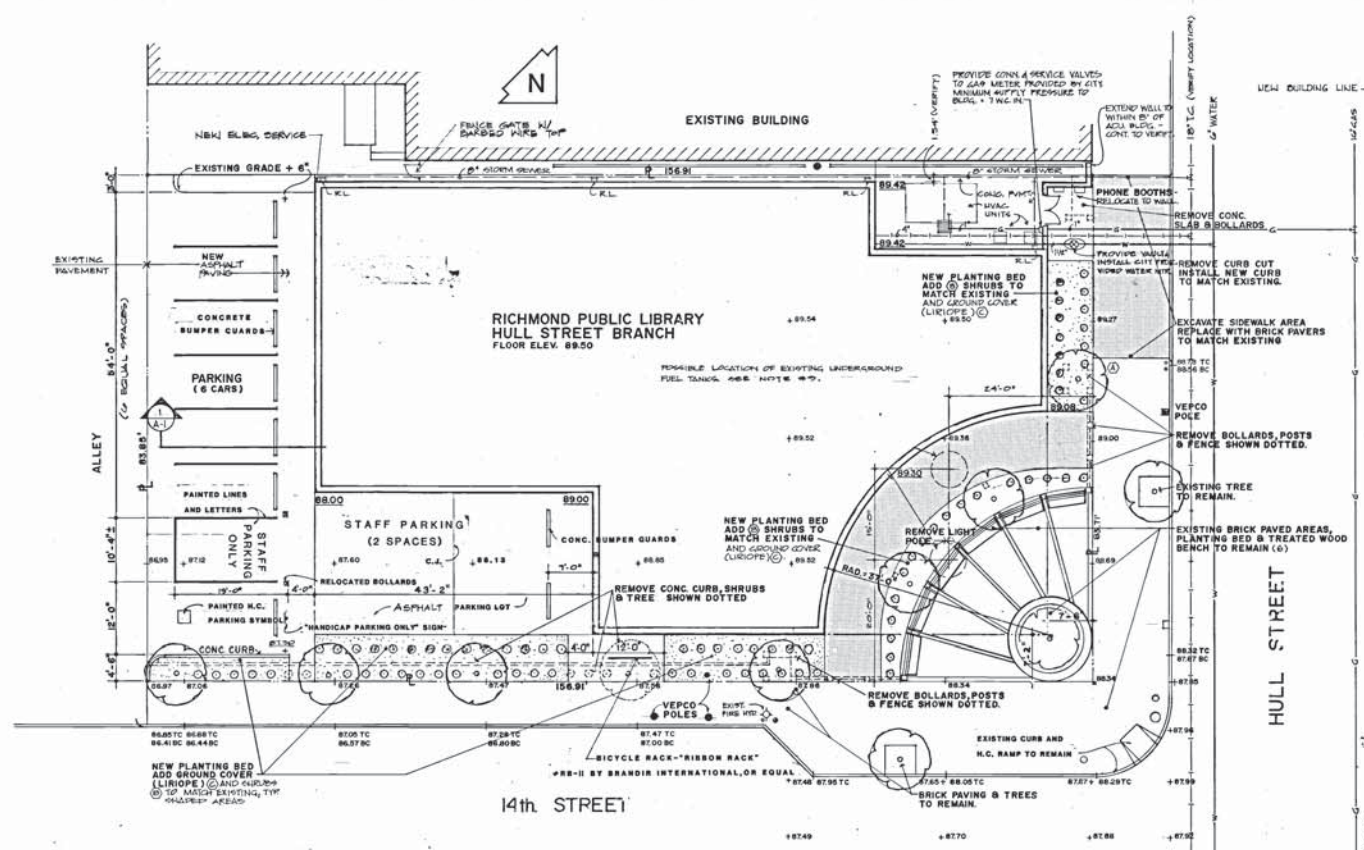

**TREE PLANTING - BED & POCKET AREAS**

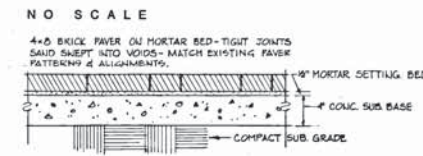

**BRICK PAVING SECTION**  
1 1/2" = 1'-0"

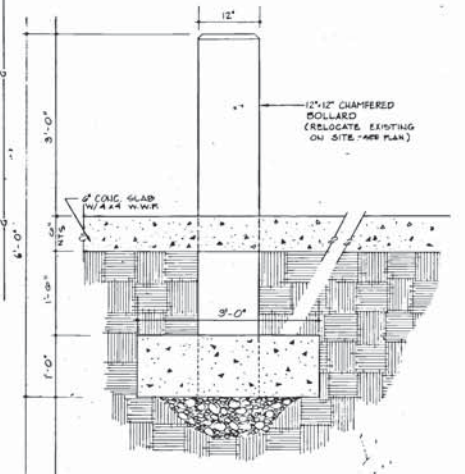

**TYP. BOLLARD SECTION**  
1" = 1'-0"

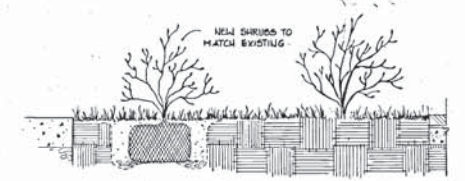

**SHRUB PLANTING**  
NO SCALE

**CODE COMPLIANCE INFORMATION**

APPLICABLE BUILDING CODE: 1981 BOCA BASIC BUILDING CODE AS AMENDED AND ADOPTED TO FORM THE VIRGINIA UNIFORM STATEWIDE BUILDING CODE  
 USE GROUP CLASSIFICATION: A-3 LIBRARY  
 CONSTRUCTION CLASSIFICATION: 2C NON-COMBUSTIBLE UNPROTECTED.  
 ALLOWABLE FLOOR AREA: 8,400 S.F. ACTUAL FLOOR AREA: 6,640 S.F.  
 ALLOWABLE BUILDING HEIGHT: 2ST/30' ACTUAL BUILDING HEIGHT: 1ST/16'  
 FIRE PROTECTION: NON-SPRINKLERED  
 ALLOWABLE TRAVEL DISTANCE TO AN EXIT: 150'  
 MAXIMUM TRAVEL DISTANCE TO AN EXIT: 75'  
 FIRE RESISTIVE CONSTRUCTION REQUIREMENTS: 1HR RATED WALL WITHIN 6' OF PROPERTY LINE

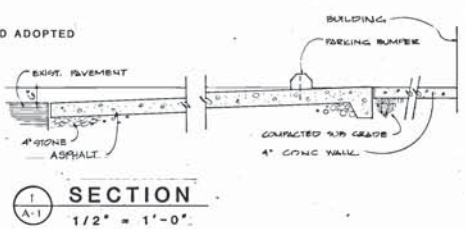

**SITE PLAN**  
SCALE: 1" = 10'

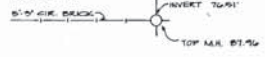

- NOTES:**
- EXISTING SITE DATUM FROM CITY DRAWINGS NO. 0-111100, SHEETS 1-3, DEPARTMENT OF PUBLIC WORKS.
  - SEE SPECIFICATION SECTION 0200 FOR EROSION CONTROL REQUIREMENTS.
  - CONTRACTOR TO VERIFY IN TANKS EXIST. NO INVESTIGATION WILL BE PERMITTED UNDER EXISTING SITE IMPROVEMENTS.
  - EXISTING GROUND COVER (LIRIOPE) TO BE DIG UP, ELIMINATED & DISTRIBUTED TO PROVIDE UNIFORM JOB.
  - REPLACE ADDITIONAL DWARF WINTERGREEN BARBERRY.

PLANT LIST						
KEY	QUANT.	BOTANICAL NAME	COMMON NAME	SIZE	COND.	REMARKS
A	1	GLEDTISIA TRIACANTHOS INERMIS SHADEMASTER	SHADEMASTER HONEY-LOCUST	SEE NOTE BELOW	B&B	IN BED & POCKETS
B	53	BERBERIS JULIANAE NANA	DWARF WINTERGREEN BARBERRY	18"-24"	B&B	BARK MULCH BED
C	3,683	LIRIOPE MUSCARI	LIRIOPE	GAL. CAN	CAN	PLANT 6" O.C.

NOTE: ITEM 'A' MAY BE EXISTING TREE TRANSPANTED AT CONTRACTOR'S OPTION. IF NEW TREE IS PROVIDED, IT SHALL BE OF APPROXIMATELY EQUAL HEIGHT TO EXISTING TREES.