

ELEVATION KEYNOTES

- ① BLACK METAL ROOF CAP ATTACHED TO P.T. EXTERIOR RATED WOOD BLOCKING. ATTACH WOOD BLOCKING TO TOP OF EXISTING PARAPET FLASHING OVER BLOCKING
- ② 10" WIDE INTERLOCKING SEAM COPPER PANEL. PATINA TREATED & SEALED OVER WATERPROOFING OVER 1/2" EXTERIOR RATED PLYWOOD OVER GALV. METAL FURRING. VERTICAL APPLICATION
- ③ 10" WIDE INTERLOCKING SEAM COPPER PANEL. PATINA TREATED & SEALED OVER WATERPROOFING OVER 1/2" EXTERIOR RATED PLYWOOD OVER 1 1/2" METAL FRAMING @ 24" O.C. VERTICAL APPLICATION. USE COPPER TO TRIM OUT AROUND DOOR & TRANSOM
- ④ 10" WIDE INTERLOCKING SEAM COPPER PANEL. PATINA TREATED & SEALED OVER WATERPROOFING OVER 1/2" EXTERIOR RATED PLYWOOD OVER GALV. METAL STUD FURRING. HORIZONTAL APPLICATION
- ⑤ 3/4" X 7.25" WIDE SHIPLAPPED WOOD SIDING (SEE FINISH SCHEDULE FOR SEALER) OVER WATERPROOFING OVER 1/2" EXTERIOR RATED PLYWOOD OVER GALV. METAL FRAMING. VERTICAL APPLICATION. USE SIDING TO TRIM OUT AROUND DOORS & WINDOWS
- ⑥ 4" x 8" x 12" PORCELAIN TILES SET WITHIN EXISTING PRE-CAST COLUMNS
- ⑦ NEW INSULATED GLASS PANEL & FRAMES TO MATCH EXISTING STOREFRONT - MUST MATCH EXACTLY.
- ⑧ BLACK METAL FASCIA BLACK TO MATCH NEW PARAPET CAPS
- ⑨ CAP EXISTING CURB @ FLASHING & COVER WITH MEMBRANE ROOFING MATERIAL - MUST USE REQUIRED MALL ROOFER
- ⑩ 12" HT. PORCELAIN TILE BASE DIRECT APPLIED TO BRICK FACE - PREP BRICK FACE WITH SCRATCH COAT
- ⑪ 12" HT. PORCELAIN TILE BASE OVER EXTERIOR RATED TILE BOARD. FASTEN TILE BOARD OVER EXISTING FINISH.
- ⑫ 4", 6", 12" PORCELAIN TILES OVER EXTERIOR RATED TILE BOARD OVER GALV. METAL FURRING & EXT. RATED BLOCKING. USE SCHLUTER - INDEC AT ALL OUTSIDE CORNERS AND TOP OF COLUMNS
- ⑬ ALUMINUM SQUARE TUBE RAILINGS - POWDER COATED FINISH - 2" SQUARE VERTICAL SUPPORTS - 3/8" X 2" FLAT BAR PICKETS - NO OPENINGS GREATER THAN 4" INCLUDING BOTTOM RAIL TO FINISHED FLOOR - OPERABLE GATES TO HAVE PANIC BAR AT 36" AFF MIN.
- ⑭ ALL EXTERIOR FINISHES NOT RECEIVING NEW FINISH TO RECEIVE NEW PAINT - SEE FINISH SCHEDULE
- ⑮ 10" WIDE INTERLOCKING SEAM COPPER PANEL. PATINA TREATED & SEALED OVER WATERPROOFING OVER 1/2" EXTERIOR RATED PLYWOOD OVER GALV. METAL FRAMING. HORIZONTAL APPLICATION
- ⑯ NEW CONCEALED GUTTER (SHOWN DASHED) WITH DARK BRONZE ALUM 4" DOWNSPOUT. MUST NOT DISCHARGE ONTO SIDEWALK



PROPOSED EXTERIOR ELEVATION - SOUTH ②
3/16 = 1'-0"



PROPOSED EXTERIOR ELEVATION - EAST ①
3/16 = 1'-0"



PROJECT: TENANT IMPROVEMENTS TO:
9216 STONY POINT PARKWAY, RICHMOND, VIRGINIA

OWNER: LATITUDE SEAFOOD
15532 WC COMMONS WAY, MIDLOTHIAN, VA 23113

EXTERIOR ELEVATIONS

MICHAEL PELLIS ARCHITECTURE
www.michaelpellis.com
804.212.9024
michael@michaelpellis.com

REVISIONS

N/A
N/A
N/A
N/A
N/A

A2.3
DATE MARCH 5, 2018

Color Renderings

ELEVATION KEYNOTES

- 1 BLACK METAL ROOF CAP ATTACHED TO P.T. EXTERIOR RATED WOOD BLOCKING. ATTACH WOOD BLOCKING TO TOP OF EXISTING PARAPET FLASHING OVER BLOCKING
- 2 10" WIDE INTERLOCKING SEAM COPPER PANEL PATINA TREATED & SEALED OVER WATERPROOFING OVER 1/2" EXTERIOR RATED PLYWOOD OVER GALV. METAL FURRING VERTICAL APPLICATION
- 3 10" WIDE INTERLOCKING SEAM COPPER PANEL PATINA TREATED & SEALED OVER WATERPROOFING OVER 1/2" EXTERIOR RATED PLYWOOD OVER 1 1/2" METAL FRAMING @ 24" O.C. VERTICAL APPLICATION. USE COPPER TO TRIM OUT AROUND DOOR & TRANSOM
- 4 10" WIDE INTERLOCKING SEAM COPPER PANEL PATINA TREATED & SEALED OVER WATERPROOFING OVER 1/2" EXTERIOR RATED PLYWOOD OVER GALV. METAL STUD FURRING HORIZONTAL APPLICATION
- 5 3/4" X 7 25" WIDE SHIP-LAPPED WOOD SIDING (SEE FINISH SCHEDULE FOR SEALER) OVER WATERPROOFING OVER 1/2" EXTERIOR RATED PLYWOOD OVER GALV. METAL FRAMING VERTICAL APPLICATION. USE SIDING TO TRIM OUT AROUND DOORS & WINDOWS
- 6 4" x 8" x 12" PORCELAIN TILES SET WITHIN EXISTING PRE-CAST COLUMNS
- 7 NEW INSULATED GLASS PANEL & FRAMES TO MATCH EXISTING STOREFRONT - MUST MATCH EXACTLY
- 8 BLACK METAL FASCIA BLACK TO MATCH NEW PARAPET CAPS
- 9 CAP EXISTING CURB @ FLASHING & COVER WITH MEMBRANE ROOFING MATERIAL - MUST USE REQUIRED MALL ROOFER
- 10 12" HT. PORCELAIN TILE BASE DIRECT APPLIED TO BRICK FACE - PREP BRICK FACE WITH SCRATCH COAT
- 11 12" HT. PORCELAIN TILE BASE OVER EXTERIOR RATED TILE BOARD - FASTEN TILE BOARD OVER EXISTING FINISH
- 12 4" x 8" x 12" PORCELAIN TILES OVER EXTERIOR RATED TILE BOARD OVER GALV. METAL FURRING & EXT. RATED BLOCKING. USE SCHLITZER - INDEC AT ALL OUTSIDE CORNERS AND TOP OF COLUMNS
- 13 ALUMINUM SQUARE TUBE RAILINGS - POWDER COATED FINISH - 2" SQUARE VERTICAL SUPPORTS - 3/8" x 2" FLAT BAR PICKETS - NO OPENINGS GREATER THAN 4" INCLUDING BOTTOM RAIL TO FINISHED FLOOR - OPERABLE GATES TO HAVE PANE BAR AT 36" AFF MIN.
- 14 ALL EXTERIOR FINISHES NOT RECEIVING NEW FINISH TO RECEIVE NEW PAINT - SEE FINISH SCHEDULE
- 15 10" WIDE INTERLOCKING SEAM COPPER PANEL PATINA TREATED & SEALED OVER WATERPROOFING OVER 1/2" EXTERIOR RATED PLYWOOD OVER GALV. METAL FRAMING HORIZONTAL APPLICATION
- 16 NEW CONCEALED GUTTER (SHOWN DASHED) WITH DARK BRONZE ALUM. 4" DOWNSPOUT. MUST NOT DISCHARGE ONTO SIDEWALK



PROPOSED EXTERIOR ELEVATION - SOUTH 2
3/16 = 1'-0"



PROPOSED EXTERIOR ELEVATION - EAST 1
3/16 = 1'-0"



PROJECT: TENANT IMPROVEMENTS TO:
9216 STONY POINT PARKWAY, RICHMOND, VIRGINIA

OWNER: LATITUDE SEAFOOD
15532 WC COMMONS WAY, MIDLOTHIAN, VA 23113

EXTERIOR ELEVATIONS

REVISIONS

N/A
N/A
N/A
N/A
N/A

MICHAEL PELLIS ARCHITECTURE
www.micropellis.com
803.212.9024
micropellis@micropellis.com

Drawing: R:\TENANT COORDINATION\Stony Point Fashion Park_VA00_CAD DRAWINGS\03_STO DEVELOPMENT\STO-Development_Plan_2016-09-23.dwg_Layout_Lease Plan 11X17_Sep 23_2016_1:00pm



Dillard's
204,000 SF
TWO LEVELS

Saks Fifth Avenue
80,000 SF
TWO LEVELS

DICK'S
84,000 SF
TWO LEVELS



NORTH
09.23.2016

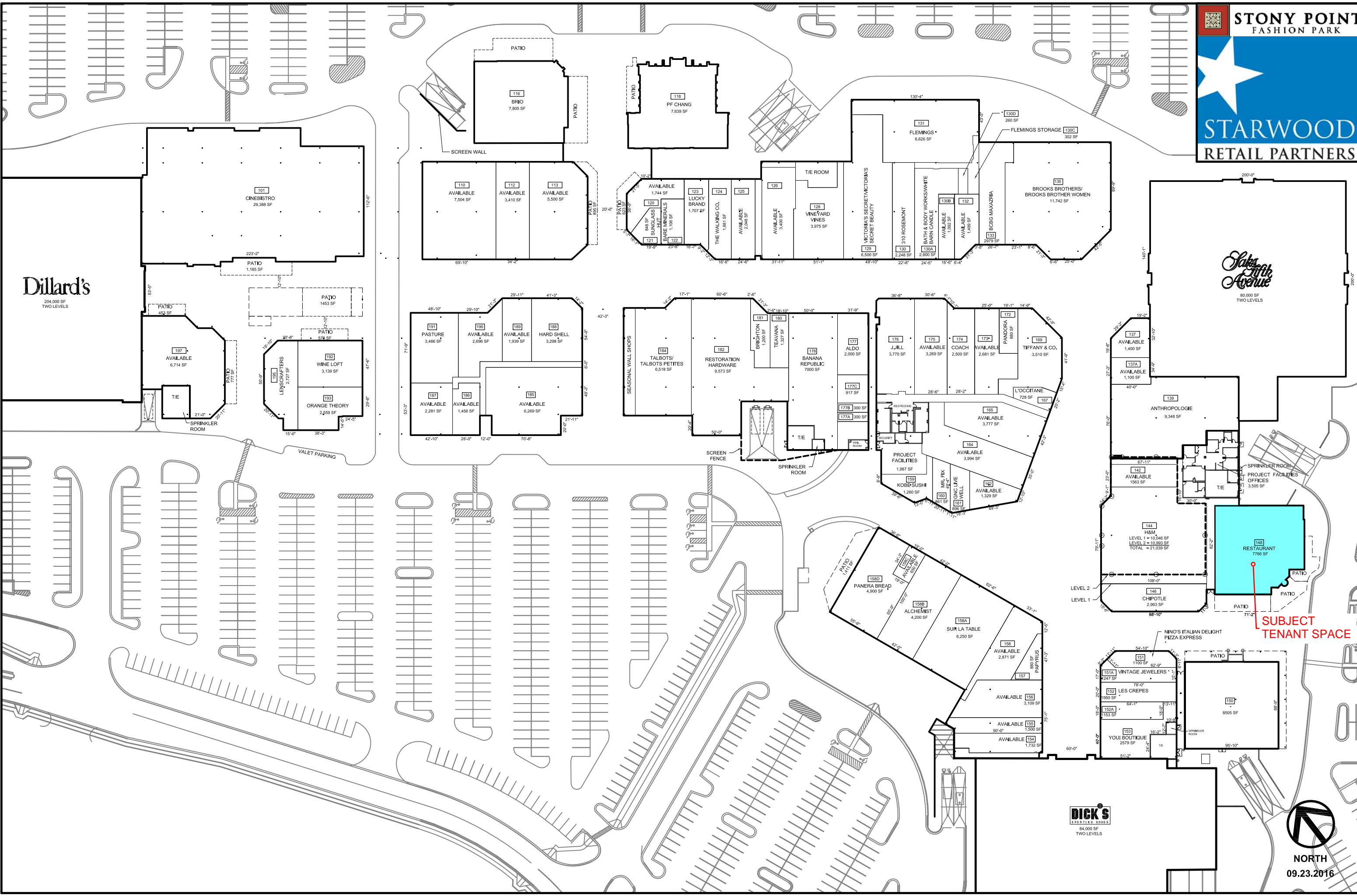

**SUBJECT
TENANT SPACE**