

CURVE TABLE						
CURVE	RADIUS	LENGTH	TANGENT	DELTA	CHORD BEARING	CHORD
C1	238.73'	104.18'	52.93'	25°00'10"	S15°43'05"E	103.35'

LINE TABLE		
LINE	BEARING	LENGTH
L1	N49°56'10"W	5.00'

**Legend**

- ⊗ Sprinkler Valve
- ⊠ Gas Drip
- ⊠ Gas Test
- ⊠ Gas Valve
- ⊠ Light Pole
- ⊠ Yard Light
- ⊠ Electric Meter
- ⊠ Electric Manhole
- ⊠ Electric Pedestal
- ⊠ Traffic Signal Pole
- ⊠ Sign
- ⊠ Mailbox
- ⊠ Sanitary Manhole
- ⊠ Sanitary Cleanout
- ⊠ Storm Manhole
- ⊠ Storm Grate
- ⊠ Utility Pole
- ⊠ Guy Anchor
- ⊠ Fire Hydrant
- ⊠ Water Meter
- ⊠ Water Valve
- ⊠ Property Corner Found
- ⊠ Concrete Monument Found

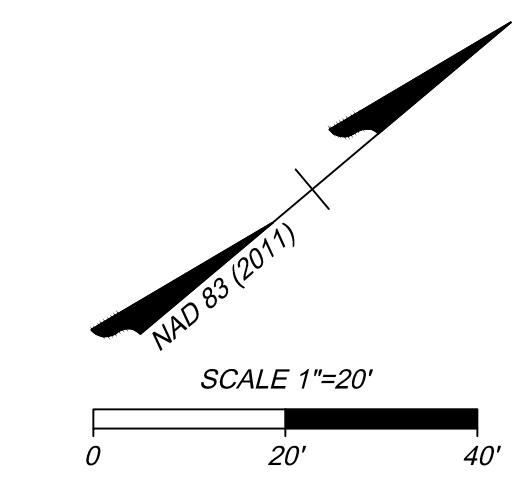

THIS TOPOGRAPHIC SURVEY WAS COMPLETED UNDER THE DIRECT AND RESPONSIBLE CHARGE OF WILLIAM R. HERX, LS FROM AN ACTUAL GROUND SURVEY MADE UNDER MY SUPERVISION; THAT THE ORIGINAL DATA WAS OBTAINED ON THE FOLLOWING DATES: OCT 23-27, 2020. THIS PLAT, MAP AND DIGITAL GEOSPATIAL DATA INCLUDING METADATA MEETS MINIMUM ACCURACY STANDARDS UNLESS OTHERWISE NOTED.

HORIZONTAL DATUM: NAD83  
 VERTICAL DATUM: NAVD88  
 DATUM ESTABLISHED BY RTK GPS (CORRECTIONS FROM RTCM-REF 0592)  
 FIELDWORK COMPLETED OCTOBER 27, 2020.  
 { 'X' } INDICATES PIPE SIZE PER CITY GIS RECORDS.

INTERSTATE 195  
 (VAR. WIDTH PUBLIC R/W)  
 LIMITED ACCESS

TOPOGRAPHIC  
 SURVEY OF TWO PARCELS  
 LYING ALONG HAMILTON  
 STREET

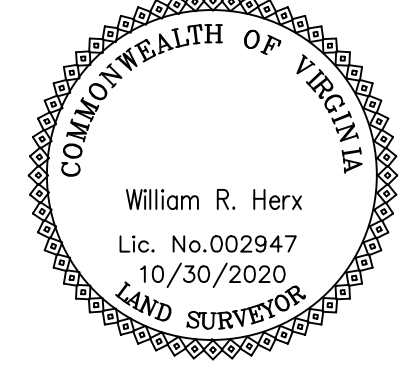

City of Richmond, Virginia	
Date: Oct. 30, 2020	Scale: 1" = 20'
Sheet 1 of 1	J.N.: 46889
Drawn by: W.R. Herx	Checked by: W.R. Herx
Revised:	