

- SODDING PROCEDURE:**
1. THE GENERAL CONTRACTOR WILL PROVIDE GRADES TO (+/-) .20' OF A FOOT OF PROPOSED GRADES.
 2. CULTIVATE ENTIRE AREA TO A MINIMUM DEPTH OF 6", HAND-RAKE SMOOTH.
 3. ADD ADDITIVES (PER SOIL TEST ANALYSIS) & ROTOTILL.
 4. WATER AREA TO BE SODDED PRIOR TO LAYING SOD.
 5. LAY & ROLL SOD, WATER THOROUGHLY.

5 SOD INSTALLATION DETAIL
1" = 1'-0"

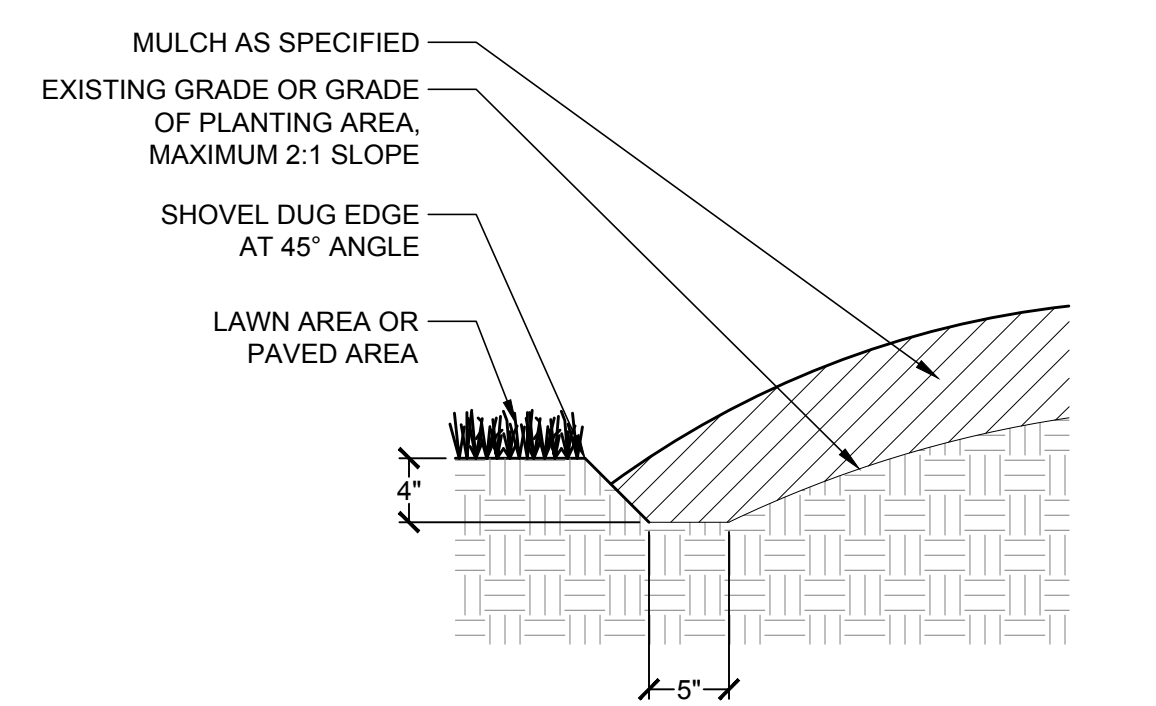

- NOTE:**
1. TRENCH EDGE DETAIL SHALL BE USED AT ALL LAWN EDGES & AT EDGES OF MULCHED AREA (FOR CONTAINMENT).
 2. TRENCH EDGE SHALL CREATE A CLEAN SEPARATION BETWEEN AREAS & SHALL CREATE SMOOTH & EVEN LINES (AS INDICATED ON THE PLANS).

6 TRENCH EDGE
1" = 1'-0"

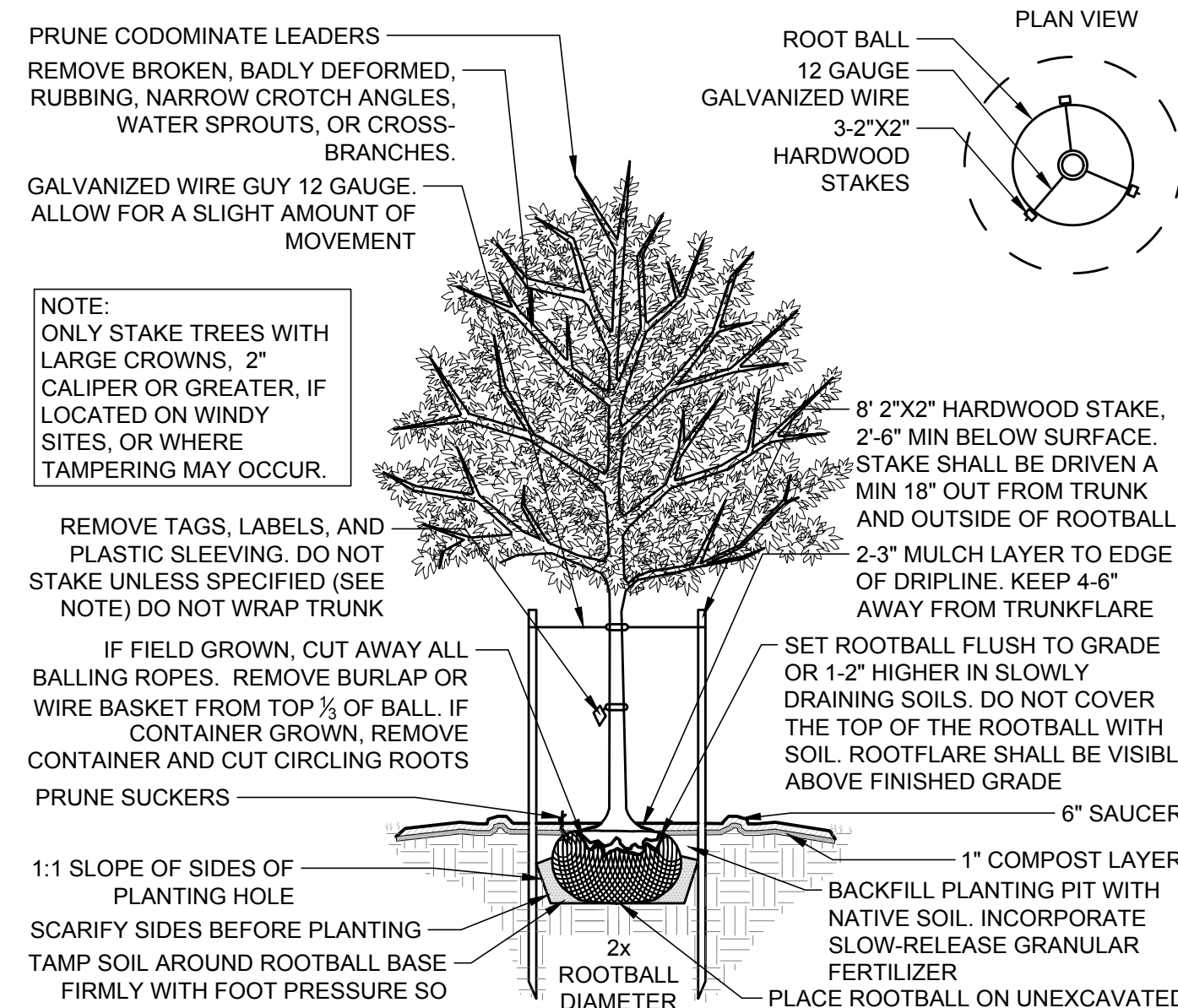

2 DECIDUOUS TREE PLANTING DETAIL
NTS

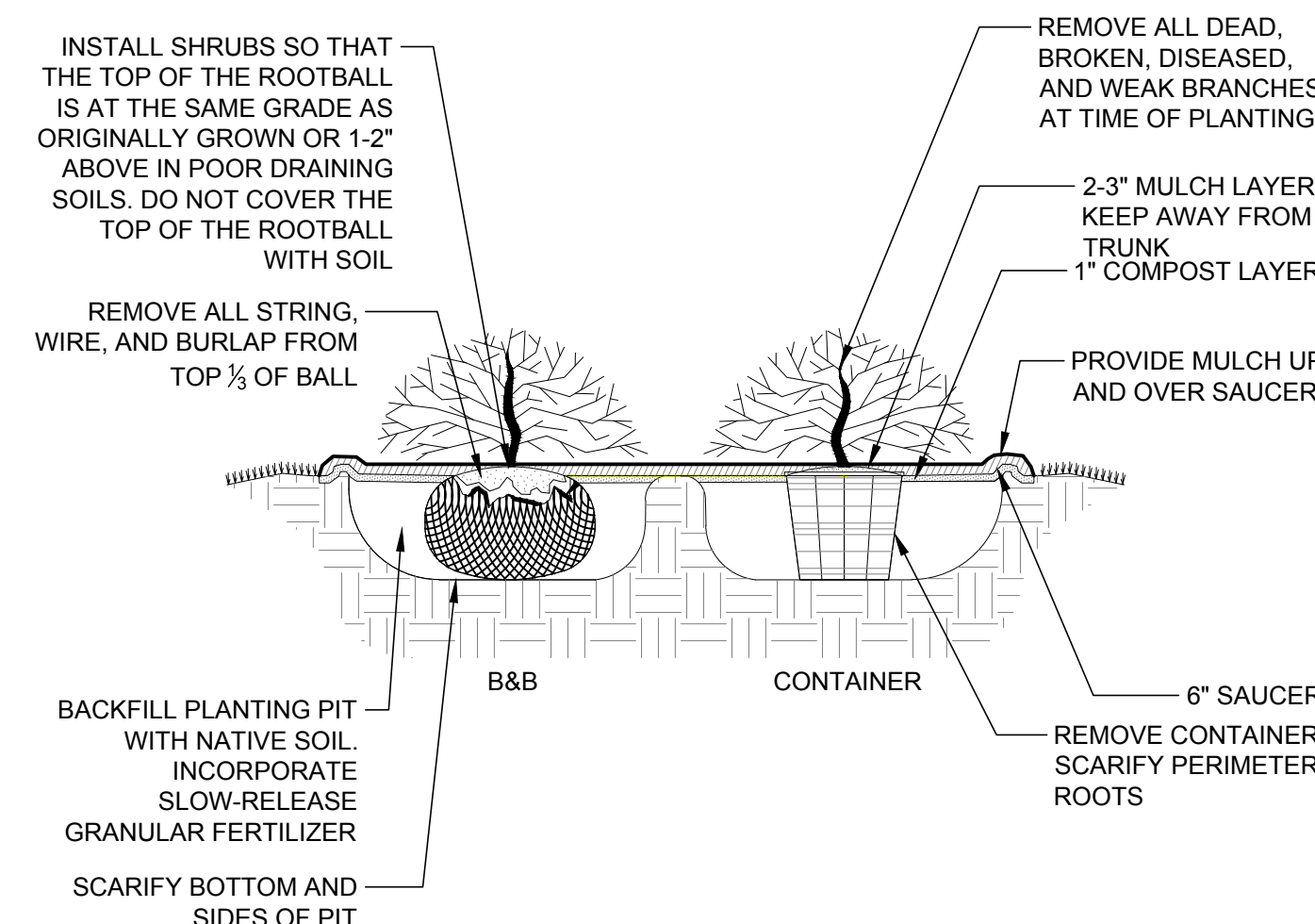

3 SHRUB PLANTING DETAIL
NTS

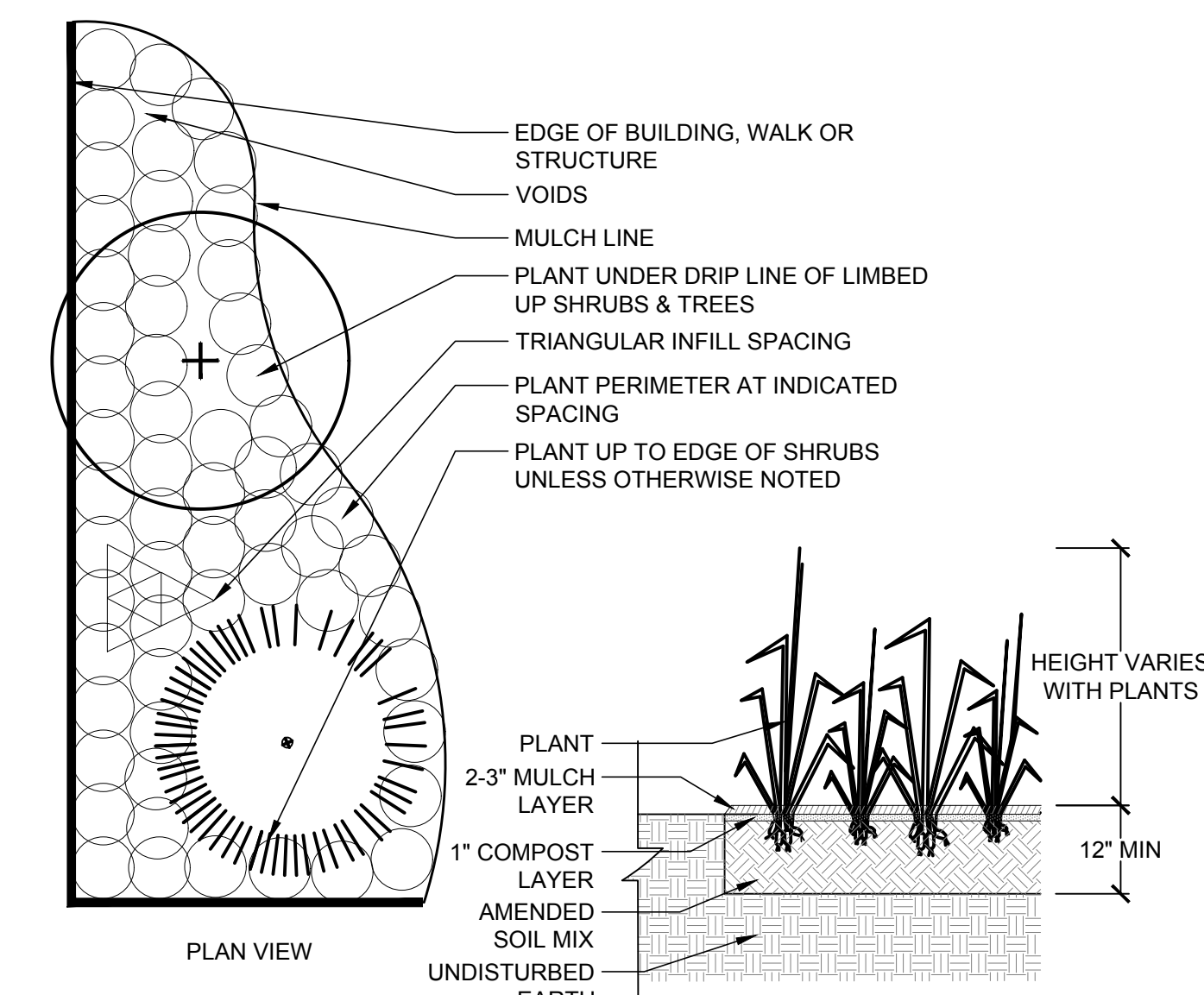

4 GROUND COVER PLANTING DETAIL
NTS

TREES	QTY	BOTANICAL NAME	COMMON NAME	MIN. INSTALLED SIZE	ROOT	TYPE	SPACING
CHI VIR	1	CHIONANTHUS VIRGINICUS	WHITE FRINGETREE	10' HT.	B&B	SINGLE STEM	
TIL GRE	1	TILIA CORDATA 'GREENSPIRE'	GREENSPIRE LITTLELEAF LINDEN	2.5' CAL.	B&B		

SHRUBS	QTY	BOTANICAL NAME	COMMON NAME	MIN. INSTALLED SIZE	ROOT	TYPE	SPACING
ILE GLA	20	ILEX GLABRA 'GEM BOX'	GEM BOX HOLLY	24\"/>			

REFERENCE NOTES SCHEDULE

SYMBOL	ROCK DESCRIPTION	QTY	DETAIL
(K-101)	RIVER STONE MULCH	128 SF	3/L1.01

SYMBOL	LAYOUT DESCRIPTION	QTY	DETAIL
(L-101)	STEEL EDGING	38 LF	4/L1.01
(L-102)	FLAG POLE	3	9/L1.01

SYMBOL	PAVING DESCRIPTION	QTY	DETAIL	MANUFACTURER	COLOR	TYPE / FINISH	DETAILS	FINISH	SIZE
(P-101)	BRICK PAVING	468 SF	1/L1.01	PINE HALL	FULL RANGE	SQUARE EDGE	RUNNING BOND W/ SOLDIER COURSE BORDER	WIRE CUT	4X8

SYMBOL	WALL DESCRIPTION	QTY	DETAIL	HEIGHT	WIDTH	MATERIAL
(W-101)	SEATWALL	27 LF	2/L1.01	20"	9"	BRICK

GENERAL NOTES

- PRE-CONSTRUCTION**
- CONTRACTOR IS RESPONSIBLE FOR CONTACTING "MISS UTILITY" AT 1-800-552-7001 FOR LOCATION OF ALL UTILITY LINES. TREES SHALL BE LOCATED A MINIMUM OF 5 FEET FROM SEWER/WATER CONNECTIONS. NOTIFY LANDSCAPE ARCHITECT OF CONFLICTS.
 - VERIFY ALL PLANT MATERIAL QUANTITIES ON THE PLAN PRIOR TO BIDDING. PLANT LIST TOTALS ARE FOR CONVENIENCE ONLY AND SHALL BE VERIFIED PRIOR TO BIDDING.
 - PROVIDE PLANT MATERIALS OF QUANTITY, SIZE, GENUS, SPECIES, AND VARIETY INDICATED ON PLANS. ALL PLANT MATERIALS AND INSTALLATION SHALL COMPLY WITH RECOMMENDATIONS AND REQUIREMENTS OF ANSI Z60.1 "AMERICAN STANDARD FOR NURSERY STOCK". IF SPECIFIED PLANT MATERIAL IS NOT OBTAINABLE, SUBMIT PROOF OF NON AVAILABILITY TO THE LANDSCAPE ARCHITECT. SUBMIT TOGETHER WITH PROPOSAL FOR USE OF EQUIVALENT MATERIAL.
 - PROVIDE AND INSTALL ALL PLANTS AS IN ACCORDANCE WITH DETAILS AND CONTRACT SPECIFICATIONS.
 - SOIL TESTS SHALL BE PERFORMED TO DETERMINE SOIL CHARACTER AND QUALITY. NECESSARY SOIL AMENDMENTS SHALL BE PERFORMED PER TEST RESULTS TO ENSURE PLANT HEALTH.
- CONSTRUCTION/INSTALLATION**
- LANDSCAPE ARCHITECT RESERVES THE RIGHT TO REJECT ANY PLANTS AND MATERIALS THAT ARE IN AN UNHEALTHY OR UNSIGHTLY CONDITION, AS WELL AS PLANTS AND MATERIALS THAT DO NOT CONFORM TO ANSI Z60.1 "AMERICAN STANDARD FOR NURSERY STOCK". LABEL AT LEAST ONE TREE AND ONE SHRUB OF EACH VARIETY AND CALIPER WITH A SECURELY ATTACHED, WATERPROOF TAG BEARING THE DESIGNATION OF BOTANICAL AND COMMON NAME.
 - INSTALL LANDSCAPE PLANTINGS AT ENTRANCES/EXITS AND PARKING AREAS ACCORDING TO PLANS SO THAT MATERIALS WILL NOT INTERFERE WITH SIGHT DISTANCES.
 - CONTRACTOR IS RESPONSIBLE FOR WATERING ALL PLANT MATERIAL DURING INSTALLATION AND UNTIL FINAL INSPECTION AND ACCEPTANCE BY OWNER. CONTRACTOR SHALL NOTIFY OWNER OF CONDITIONS WHICH AFFECTS THE GUARANTEE.
- INSPECTIONS/GUARANTEE**
- UPON COMPLETION OF LANDSCAPE INSTALLATION, THE LANDSCAPE CONTRACTOR SHALL NOTIFY THE GENERAL CONTRACTOR WHO WILL VERIFY COMPLETENESS, INCLUDING THE REPLACEMENT OF ALL DEAD PLANT MATERIAL. CONTRACTOR IS RESPONSIBLE FOR SCHEDULING A FINAL INSPECTION BY THE LANDSCAPE ARCHITECT.
 - ALL EXTERIOR PLANT MATERIALS SHALL BE GUARANTEED FOR ONE FULL YEAR AFTER DATE OF FINAL INSPECTION AGAINST DEFECTS INCLUDING DEATH AND UNSATISFACTORY GROWTH. DEFECTS RESULTING FROM NEGLIGENCE BY THE OWNER, ABUSE OR DAMAGE BY OTHERS, OR UNUSUAL PHENOMENA OR INCIDENTS WHICH ARE BEYOND THE CONTRACTORS CONTROL ARE NOT THE RESPONSIBILITY OF THE CONTRACTOR.
 - PLANT MATERIAL QUANTITIES AND SIZES WILL BE INSPECTED FOR COMPLIANCE WITH APPROVED PLANS BY A SITE PLAN REVIEW AGENT OF THE PLANNING DEPARTMENT PRIOR TO THE RELEASE OF THE CERTIFICATE OF OCCUPANCY.
 - REMOVE ALL GUY WIRES AND STAKES 12 MONTHS AFTER INSTALLATION.

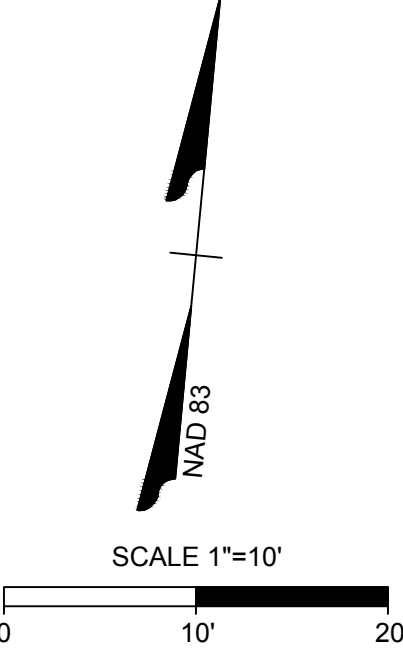
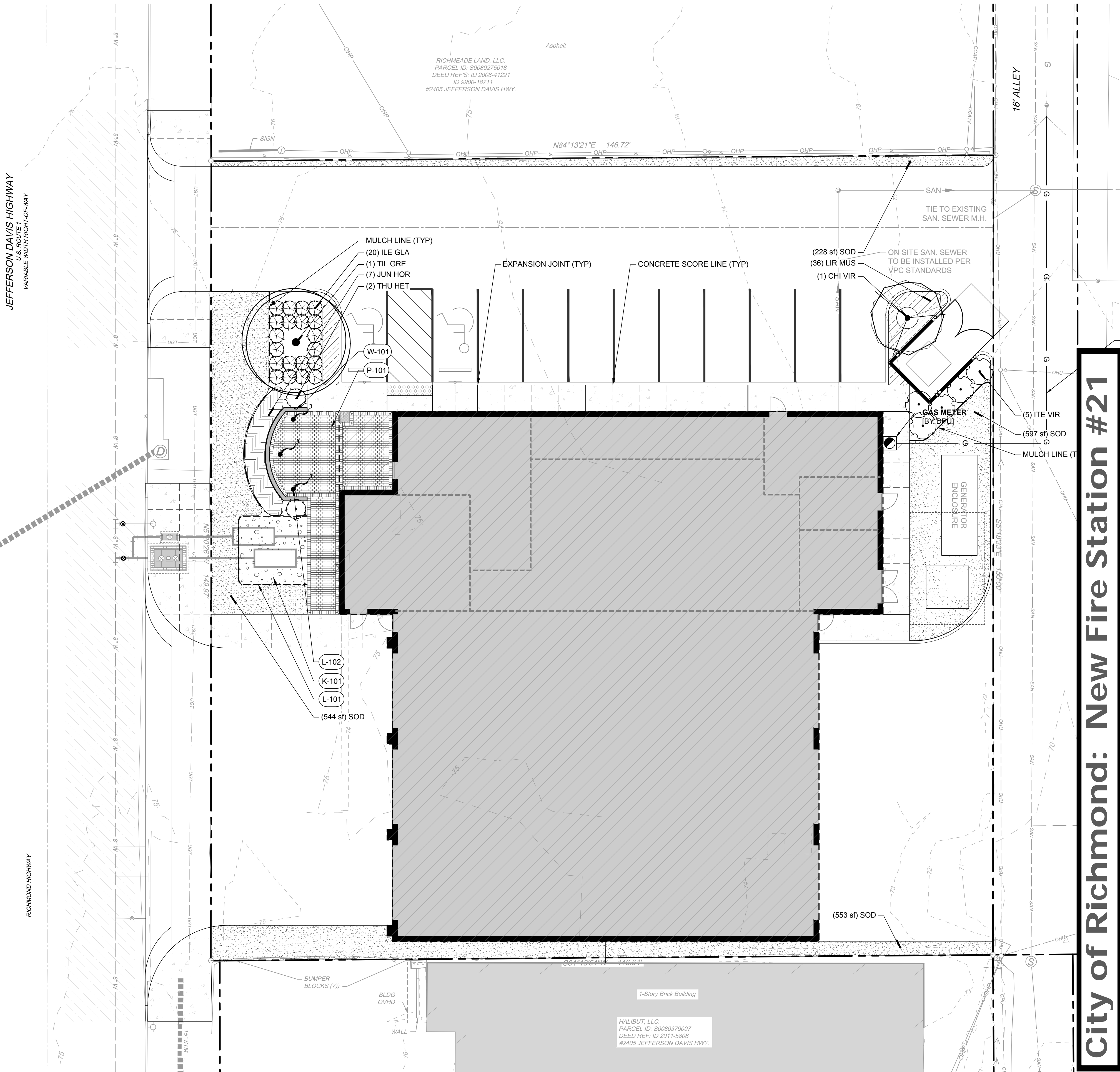

UDC FINAL REVIEW SUBMITTAL
NOT FOR CONSTRUCTION
PLAN SET DATE - 07/19/2023

THIS DRAWING PREPARED AT THE
CORPORATE OFFICE
1001 Boulders Parkway, Suite 300 | Richmond, VA 23225
TEL 804-200-6500 FAX 804-560-1016 www.timmons.com

YOUR VISION ACHIEVED THROUGH OURS.

REVISION DESCRIPTION	DATE
	07/19/2023

DRAWN BY
C. GREGORY
DESIGNED BY
CG / SW
CHECKED BY
S. WILEY
SCALE
1" = 10'

City of Richmond: New Fire Station #21

TIMMONS GROUP

CITY OF RICHMOND FIRE STATION 21
BROAD ROCK DISTRICT - CITY OF RICHMOND - VIRGINIA
LANDSCAPE LAYOUT AND MATERIALS PLAN AND NOTES AND DETAILS

JOB NO.	60040
SHEET NO.	L1.00

timmons.com/983000460040-CorP_FSL_Registration/CDWG/Sheet/CDWG004600.L1.00.PLAN.dwg | Printed on 7/19/2023 3:50 PM | by Kendall Underberg

These plans and associated documents are the exclusive property of TIMMONS GROUP and may not be reproduced in whole or in part and shall not be used for any purpose whatsoever, inclusive, but not limited to construction, bidding, and/or construction taking without the express written consent of TIMMONS GROUP.

