

Scale 1"=20' Date 12/13/18 Drawn by GAH
 E-MAIL AGHAROCOPOS72@GMAIL.COM
 OFFICE 804 744 2630 FAX 804 744 2632
 4920 E MILLRIDGE PKWY, SUITE 200 MIDLOTHIAN VA, 23112

A. G. HAROCOPOS & ASSOCIATES, P.C.
 CERTIFIED LAND SURVEYOR AND CONSULTANT

NOTE: PLAT PREPARED FOR THE EXCLUSIVE USE OF JOHN WHITWORTH

RICHMOND, VIRGINIA
 #821 N. 25th STREET

SURVEY OF LOT AND IMPROVEMENTS THEREON LOCATED AT

N. 25th STREET

- LEGEND
- Rod/S
 - Stone/F
 - ⊕ Power Pole
 - To Be Set

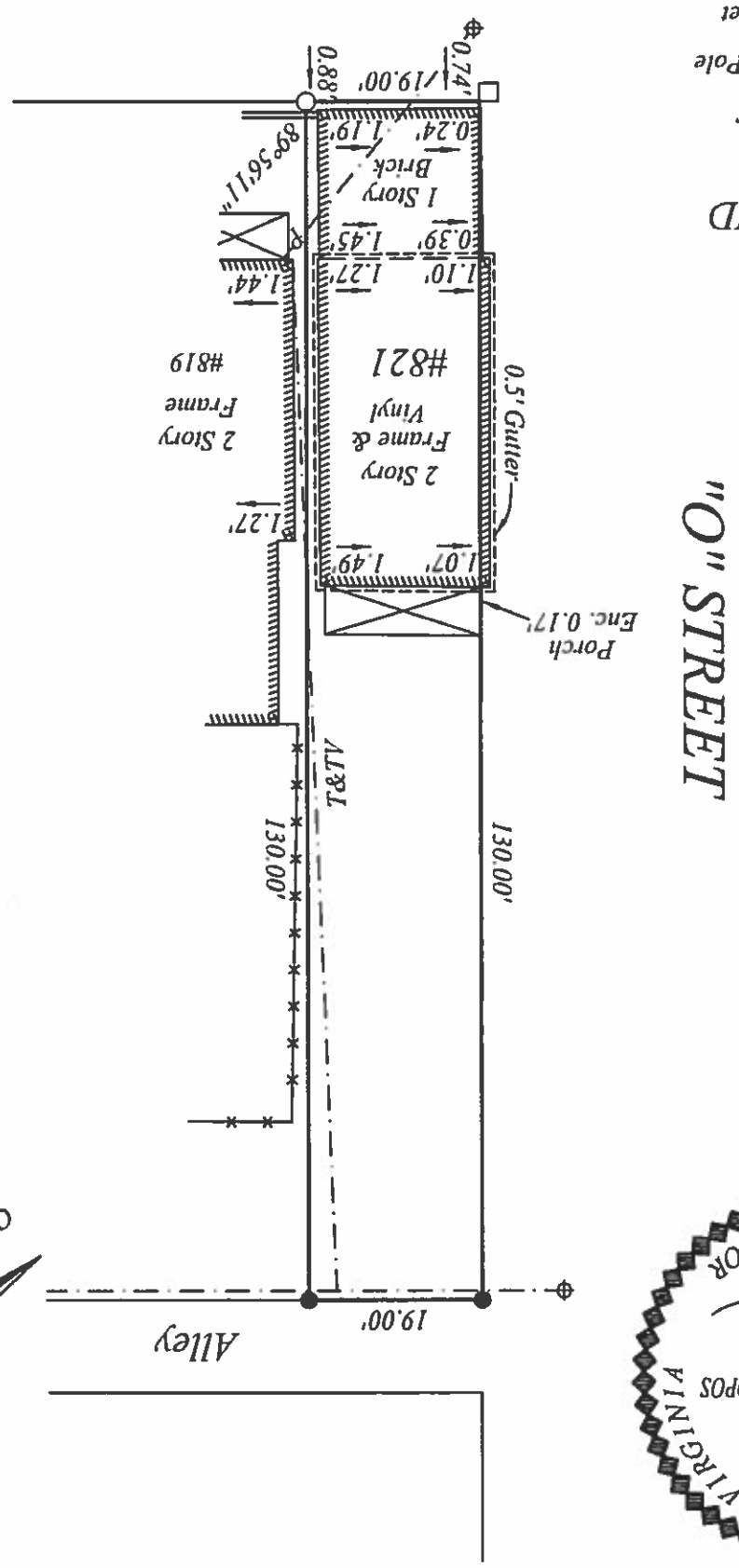

This is to certify that on 12/13/18 I made an accurate field survey of the known premises shown hereon; that all improvements known or visible are shown hereon; that there are no encroachments by improvements either from adjoining premises, or from subject premises upon adjoining premises, other than shown hereon.

NOTE: THIS LOT APPEARS TO BE IN FEMA FLOOD ZONE AS SHOWN ON HUD X AS SHOWN ON HUD COMMUNITY PANEL NUMBERS 5101290041E

NOTE: This survey has been prepared without the benefit of a title report and does not therefore necessarily indicate all encumbrances on the property.

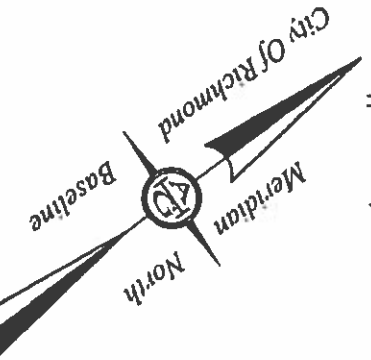

JN 48108