

TYPICAL DETAIL - STEPS AT SIDEWALK
SCALE - 1" = 1'-0"

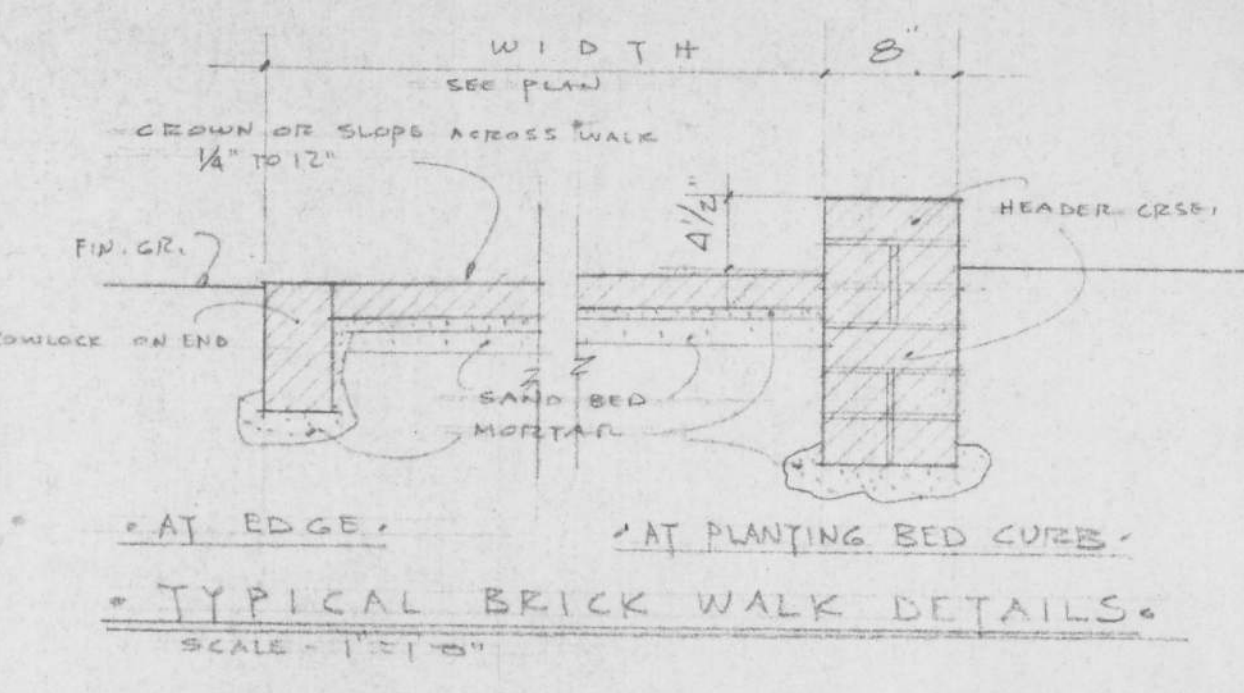

TYPICAL BRICK WALK DETAILS
SCALE - 1" = 1'-0"

NOTE: PATTERN OF BRICK WALK TO MATCH EXISTING WALK AT CHURCH HOUSE

MANHOLE
EL. R.I.M. 207.05
F.L. L.B. 193.05

LIST OF DRAWINGS

SHEET NO.	TITLE
1	PLOT PLAN
2	BASEMENT PLAN
3	FIRST FLOOR PLAN
4	SECOND FLOOR & ROOF PLANS
5	ELEVATIONS
6	ELEVATIONS & SECTIONS
7	SECTIONS & DETAILS
8	WALL SECTIONS
9	ENTRANCE DETAILS
10	WINDOW DETAILS
11	STEEPLE DETAILS
12	STAIR NO. 1 DETAILS
13	STAIR NO. 2 DETAILS
14	STAIR NO. 3 & TOWER STAIR DETAILS
15	NAVE DETAILS
16	MISCELLANEOUS DETAILS
17	ALTERATIONS TO EXISTING BLDG.
S-1	STRUCTURAL FRAMING DETAILS
S-2	ROOF FRAMING DETAILS
P-1	PLUMBING PLANS & DETAILS
H-1	BASEMENT HEATING PLANS
H-2	FIRST FLOOR HEATING PLANS
H-3	SECOND FLOOR HEATING PLANS
E-1	ELECTRICAL PLANS & DETAILS

SYMBOLS

MATERIAL	SMALL SCALE	LARGE SCALE
EARTH	[Symbol]	[Symbol]
GRAVEL	[Symbol]	[Symbol]
CONCRETE	[Symbol]	[Symbol]
STONE (CAST)	[Symbol]	[Symbol]
BRICK	[Symbol]	[Symbol]
CONC. BLOCK	[Symbol]	[Symbol]
WOOD	[Symbol]	[Symbol]
METAL	[Symbol]	[Symbol]
PLASTER	[Symbol]	[Symbol]
CER. TILE	[Symbol]	[Symbol]
ACOUSTICAL TIB	[Symbol]	[Symbol]
INSULATION	[Symbol]	[Symbol]

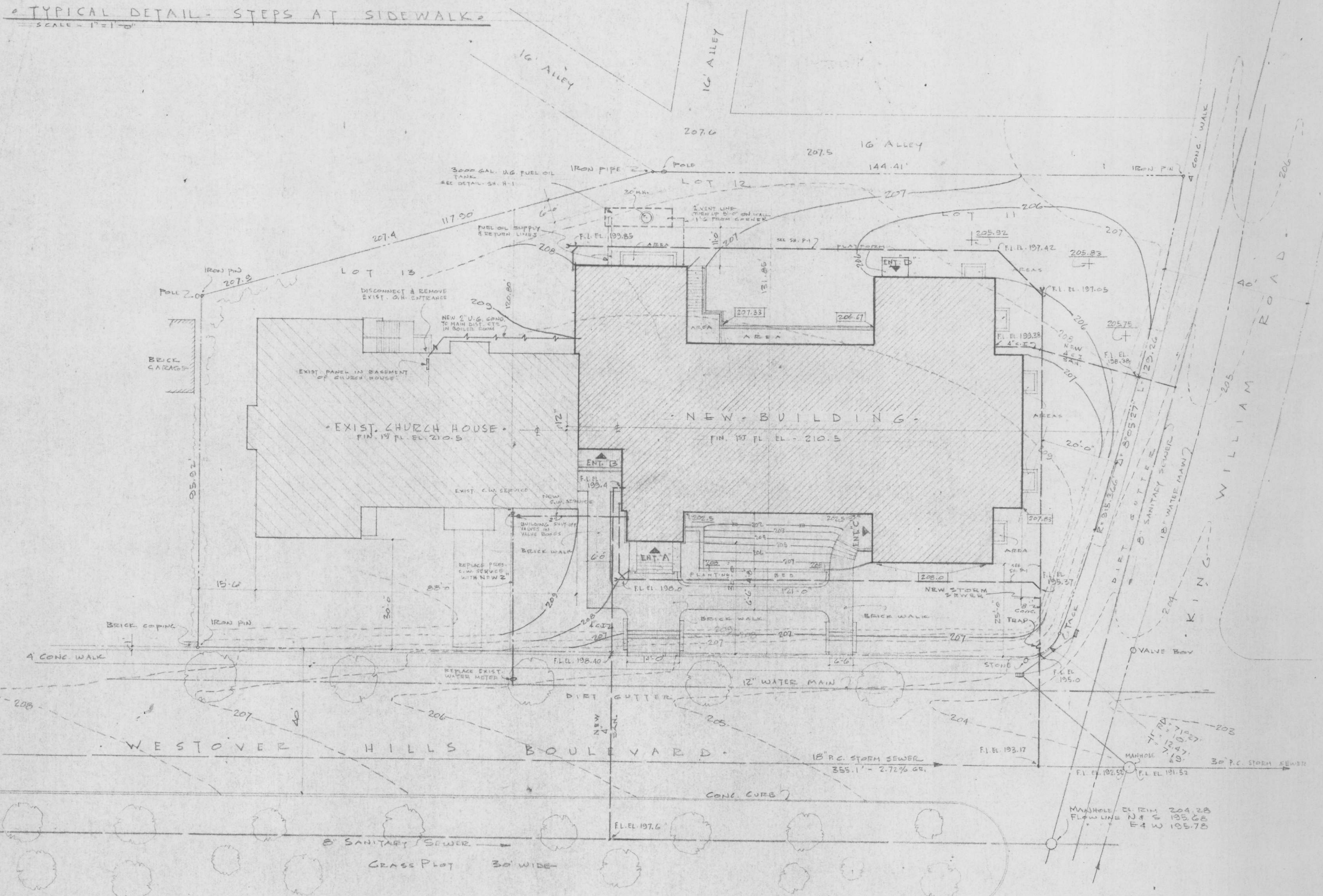

PLOT PLAN
SCALE - 1/4" = 1'-0"

FROM A SURVEY BY W.W. LIPTRAD & ASSOC. DATED MAY 21, 1947
OF A PARCEL OF LAND KNOWN AS LOTS 11, 12 & 13, BLOCK G
SUBDIVISION 'A', WESTOVER HILLS, RICHMOND, VIRGINIA.

LEGEND
EXISTING CONTOURS --- 206.0
NEW CONTOURS --- 206.0

PLOT PLAN
WESTOVER HILLS
METHODIST CHURCH
RICHMOND, VIRGINIA

BALLOU and JUSTICE
ARCHITECTS - ENGINEERS
RICHMOND, VIRGINIA

DATE SEPT 15 1955 SHEET 1 OF 17
CONTRACT NO. 5402