

**LEGEND**

- POCOMOKE CRAPEMYRTLE (SHRUB)
- CRAPEMYRTLE
- JUNIPER
- RED MAPLE
- DOWNY SERVICEBERRY
- RIVER BIRCH
- MULCH BED
- COTONEASTER
- SEED

**NOTES:**

1. GRASS SEED TYPE IS TO BE FESCUE BLEND - FINE BLADE TURF AND APPLIED AS REQUIRED.
2. THE LANDSCAPE ARCHITECT IS THE OWNER'S REPRESENTATIVE AND SHALL BE THE APPROVING AUTHORITY FOR INFORMATION PROVIDED ON THIS PLAN AND SPECIFICATIONS.
3. ALL PLANT MATERIALS, TOPSOIL, MULCH, FERTILIZERS, SOIL AMENITIES, PLANTING SUPPLIES AND METHODS SHALL BE SUBJECT TO LANDSCAPE ARCHITECTS APPROVAL. REJECTED MATERIAL SHALL BE REMOVED FROM THE SITE WITHOUT DELAY.
4. UPON COMPLETION OF LANDSCAPE INSTALLATION, THE LANDSCAPE CONTRACTOR SHALL NOTIFY THE GENERAL CONTRACTOR WHO WILL VERIFY COMPLETENESS AND SCHEDULE A FINAL INSPECTION FOR ACCEPTANCE BY OWNER.
5. THE ONE YEAR GUARANTEE PERIOD SHALL BEGIN UPON THE OWNER'S APPROVAL AND ACCEPTANCE OF THE PLANTING INSTALLATION. THE OWNER SHALL ASSUME RESPONSIBILITY FOR ALL GROUNDS MAINTENANCE.

**98% SUBMITTAL**  
2022

**GREELEY AND HANSEN**  
9020 STONY POINT PARKWAY, SUITE 275  
RICHMOND, VIRGINIA 23235

DESIGNED JJS  
DRAWN JJS  
CHECKED TD

APPROVED

NO.	DATE	APPD	DESCRIPTION

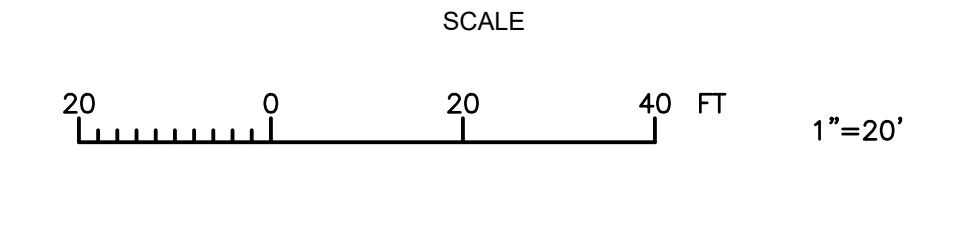

CITY OF RICHMOND, VIRGINIA  
DEPARTMENT OF PUBLIC UTILITIES  
WWTP ADMINISTRATION BUILDING



CIVIL  
LANDSCAPE PLAN

PROJECT NO.: 0218B.16
DWG <b>C107</b>
SHEET 13 OF ##
DATE NOVEMBER 2022 REV 0

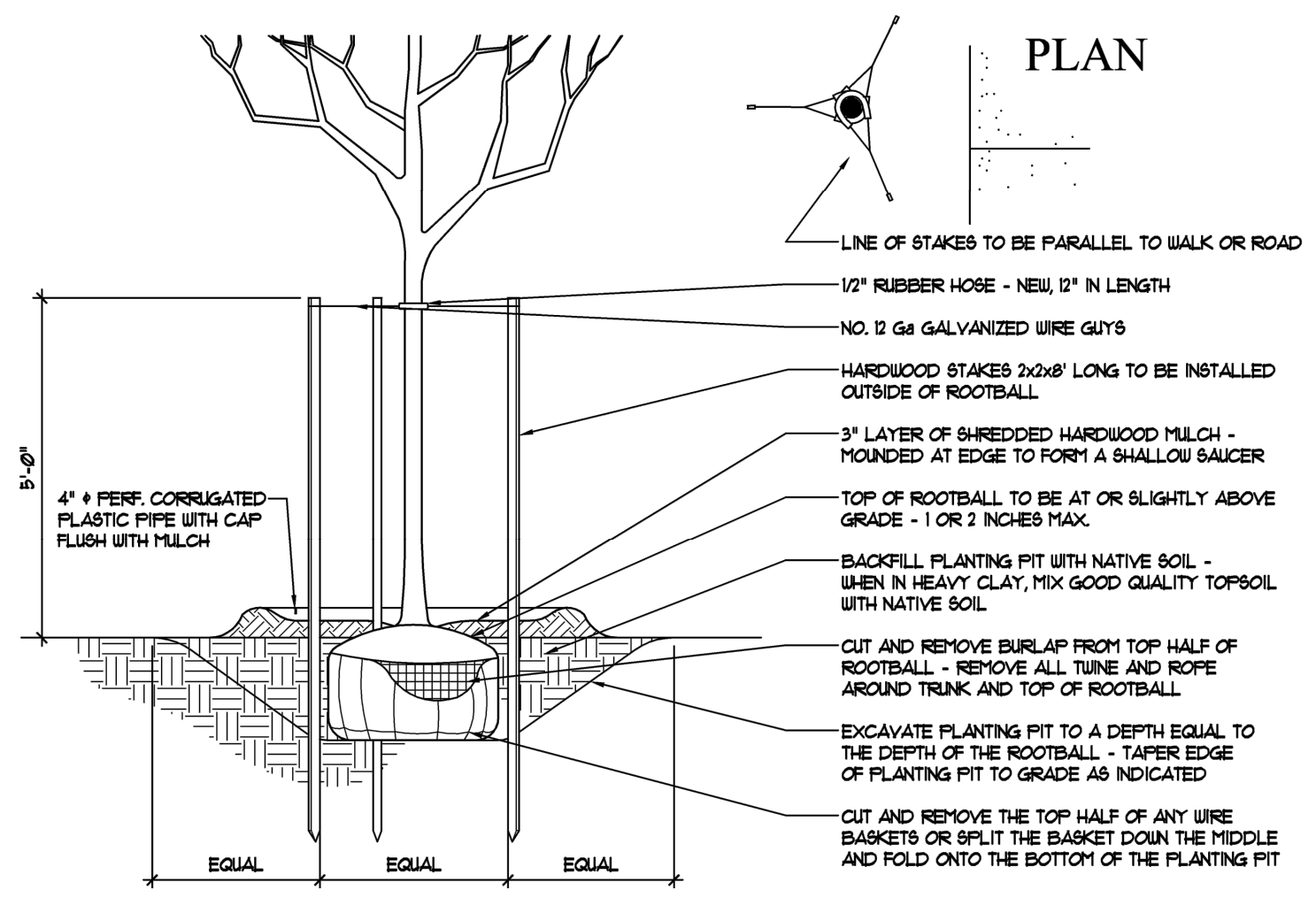

**DETAIL 1/C108**  
**DECIDUOUS TREE STAKING**  
SCALE: NOT TO SCALE

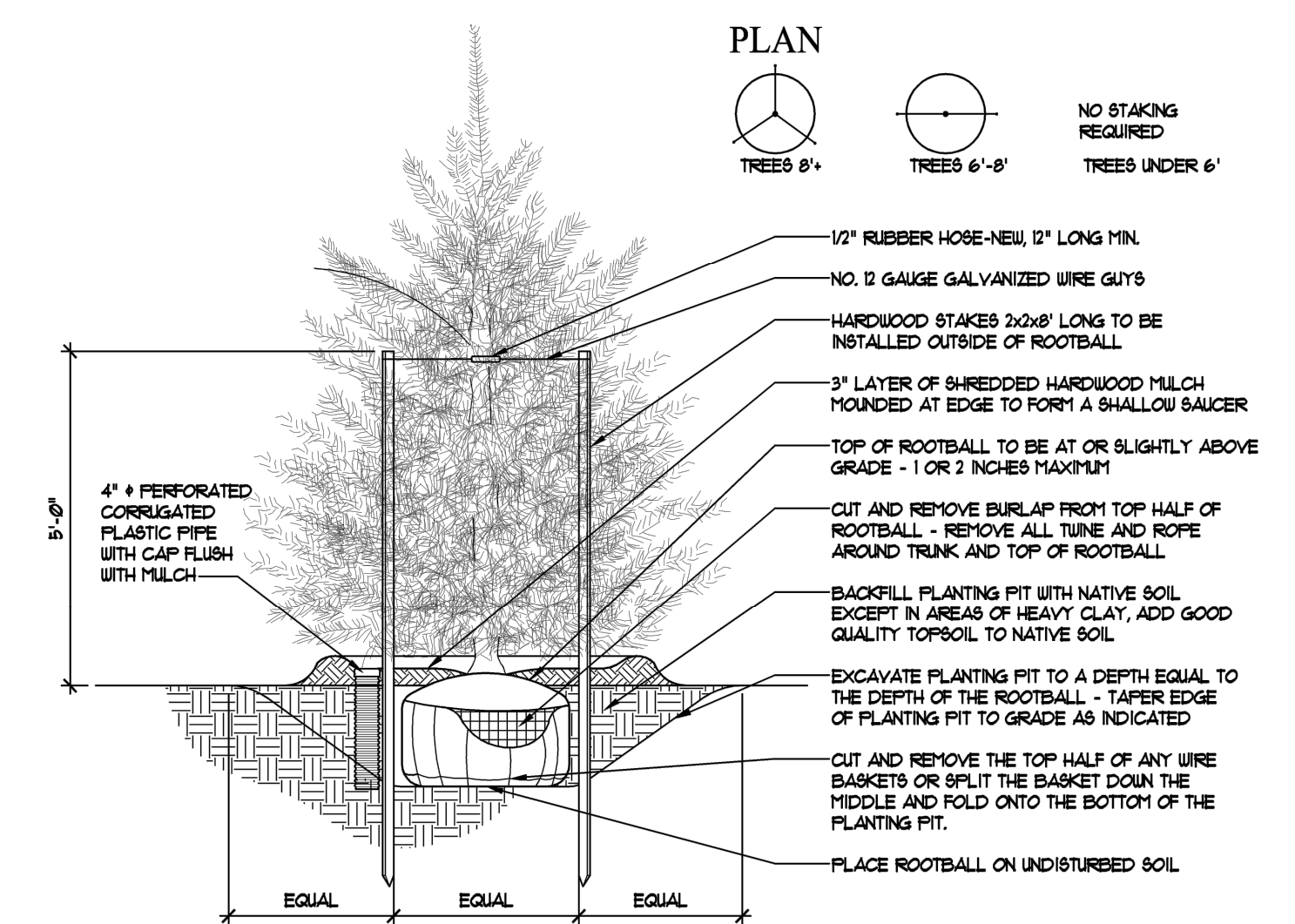

**DETAIL 3/C108**  
**CONIFEROUS AND EVERGREEN TREE STAKING**  
SCALE: NOT TO SCALE

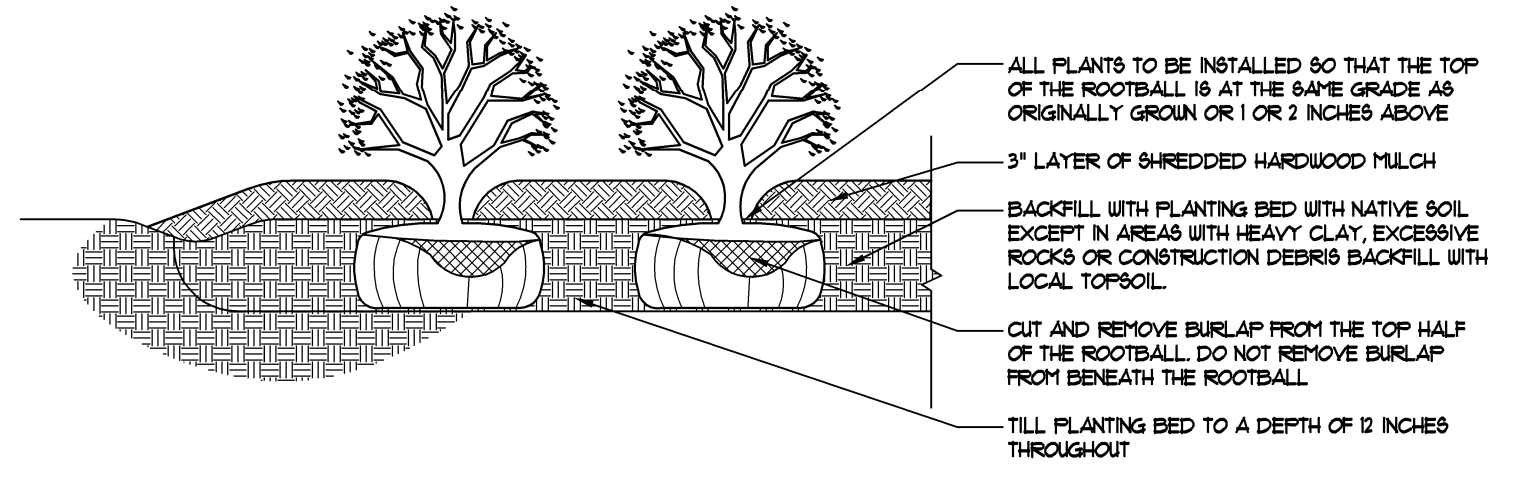

**DETAIL 2/C108**  
**SHRUB PLANTING**  
SCALE: NOT TO SCALE

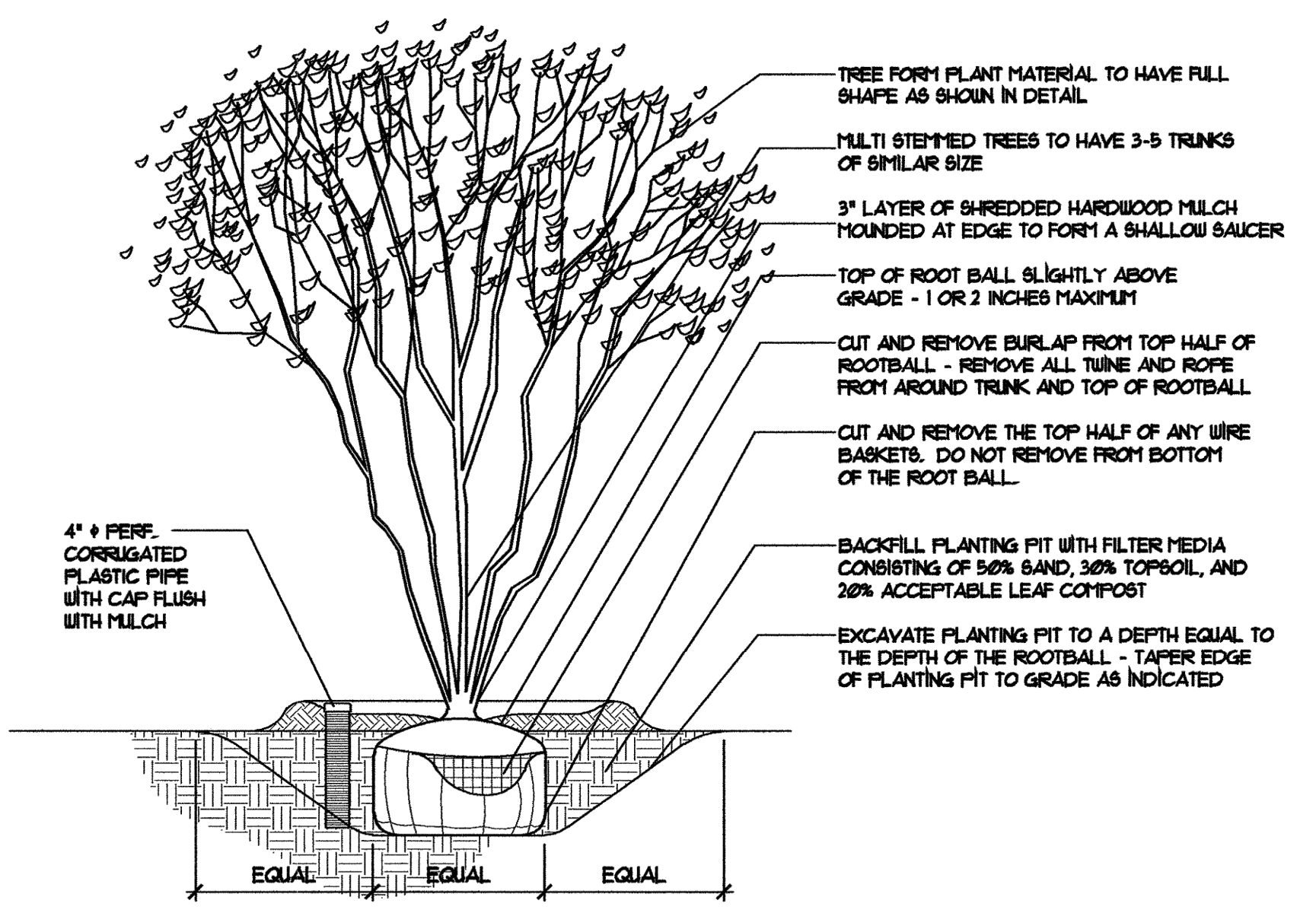

**DETAIL 4/C108**  
**MULTI STEM TREE PLANTING DETAIL**  
SCALE: NOT TO SCALE

**PLANT MATERIAL SCHEDULE**

QUANTITY	BOTANICAL NAME	COMMON NAME	SPACING	CALIPER	HT./SPREAD	ROOT TYPE	DETAIL	REMARKS
<b>TREES</b>								
2	LAGERSTROEMIA	CRAPEMYRTLE	SHOWN	-	-	CONTAINER	1	
3	JUNIPERUS SSP	JUNIPER, BLUE ARROW	SHOWN	-	3'-0"	B & B	3	
2	ACER RUBRUM	RED MAPLE	30' O/C	3"	-	B & B	1	5 FT. BRANCHING HEIGHT
6	AMELANCIER ARBOREA	DOWNY SERVICEBERRY	SHOWN	2 1/2"	-	-	1	
3	BETULA NIGRA	RIVER BIRCH	SHOWN	2 1/2"	-	-	4	
<b>SHRUBS</b>								
4	COTONEASTER DAMMERI	BEARBERRY COTONEASTER	SHOWN	-	-	1 GAL	2	MULCH ENTIRE BED, FULL
9	LAGERSTROEMIA	CRAPEMYRTLE, POKOMOKO	SHOWN	-	-	CONTAINER	1	

**NOTES:**

- CONTRACTOR SHALL VERIFY PLANT MATERIAL QUANTITIES SHOWN ON PLAN WITH TOTALS IN PLANTING SCHEDULE. NOTIFY LANDSCAPE ARCHITECT OF ANY DISCREPANCIES PRIOR TO FINAL BIDDING.
- ALL PLANT MATERIALS SHALL BE GUARANTEED FOR ONE FULL YEAR TO BE IN HEALTHY GROWING CONDITION. PLANT MATERIALS WHICH DO NOT FULFILL THIS GUARANTEE SHALL BE REPLACED AT NO COST TO THE OWNER. REPLACEMENT SHALL BE GUARANTEED THROUGHOUT THE ORIGINAL GUARANTEE PERIOD. PLANTS THAT DIE WITHIN 60 DAYS OF INSTALLATION SHALL BE REPLACED IMMEDIATELY.
- CONTRACTOR IS RESPONSIBLE FOR WATERING ALL PLANT MATERIAL DURING INSTALLATION AND UNTIL FINAL INSPECTION AND ACCEPTANCE BY OWNER.
- CONTRACTOR IS RESPONSIBLE FOR CONTACTING MISS UTILITY PRIOR TO BEGINNING OF CONSTRUCTION FOR LOCATION OF ALL UTILITY LINES. TREES SHALL BE LOCATED A MINIMUM OF 5 FEET FROM SEWER WATER CONNECTIONS. NOTIFY LANDSCAPE ARCHITECT IF ANY CONFLICTS OCCUR.
- THE LANDSCAPE ARCHITECT IS THE OWNER'S REPRESENTATIVE AND SHALL BE THE APPROVING AUTHORITY FOR INFORMATION PROVIDED IN THESE PLANS AND SPECIFICATIONS.
- ALL PLANT MATERIALS, TOPSOIL, MULCH, FERTILIZERS, SOIL AMENITIES, PLANTING SUPPLIES AND METHODS SHALL BE SUBJECT TO LANDSCAPE ARCHITECTS APPROVAL. REJECTED MATERIAL SHALL BE REMOVED FROM THE SITE WITHOUT DELAY.
- ALL PLANT MATERIALS AND PLANTING METHODS SHALL CONFORM TO AAN STANDARDS.
- CONTRACTOR SHALL LAYOUT AND MARK LOCATION FOR ALL PLANT MATERIAL, PLANTING BEDS AND IMPROVEMENTS SHOWN AND REQUEST IN FIELD APPROVAL FROM LANDSCAPE ARCHITECT.
- BEDS TO CONTAIN SHRUBS OR GROUND COVER SHALL BE TILLED TO A DEPTH OF 12" AND THE SOIL CONDITIONED BY ADDING CLEAN, WELL-ROTTED MANURE. IF EXISTING SOIL IS CONSIDERED TO BE UNUSABLE BY OWNER, BEDS SHALL BE TREATED TO ELIMINATE WEEDS AND WEED SEEDS.
- ALL PLANTING BED AREAS SHALL BE COVERED WITH A 2" MINIMUM LAYER OF MEDIUM TEXTURE SHREDDED HARDWOOD MULCH.
- ALL SUBSTITUTIONS OF PLANT MATERIAL SHALL BE REQUESTED IN WRITING TO THE LANDSCAPE ARCHITECT AND APPROVED IN WRITING BY THE OWNER.
- ALL PLANTING OPERATIONS SHALL BE UNDER THE SUPERVISION OF AN EXPERIENCED PLANTSMAN.
- LANDSCAPE ARCHITECT RESERVES THE RIGHT TO SELECT PLANT MATERIALS IN THE NURSERY.
- UPON COMPLETION OF LANDSCAPE INSTALLATION, THE LANDSCAPE CONTRACTOR SHALL NOTIFY THE GENERAL CONTRACTOR WHO WILL VERIFY COMPLETENESS INCLUDING THE REPLACEMENT OF ALL DEAD PLANT MATERIAL AND SCHEDULE A FINAL INSPECTION FOR ACCEPTANCE BY OWNER.
- THE ONE YEAR GUARANTEE PERIOD SHALL BEGIN UPON THE OWNER'S APPROVAL AND ACCEPTANCE OF THE PLANTING INSTALLATION. THE OWNER SHALL ASSUME RESPONSIBILITY FOR MAINTENANCE INCLUDING WATERING AND WEEDING.
- FOR TREES BALLED IN WIRE BASKETS, CUT AND REMOVE TOP AND SIDES OF BASKET AFTER INSTALLATION.
- CONTRACTOR SHALL REMOVE STAKING FROM TREES AT THE END OF THE ONE YEAR WARRANTY PERIOD.
- LANDSCAPE ARCHITECT RESERVE THE RIGHT TO REJECT ANY PLANTS AND MATERIALS THAT ARE IN AN UNHEALTHY OR UNSIGHTLY CONDITION, AS WELL AS PLANTS AND MATERIALS THAT DO NOT CONFORM TO AAN STANDARDS. SEE AMERICAN STANDARD FOR NURSERY STOCK, ANSI Z60.1- (CURRENT EDITION).

**98% SUBMITTAL**  
2022

**GREELEY AND HANSEN**  
9020 STONY POINT PARKWAY, SUITE 275  
RICHMOND, VIRGINIA 23235

DESIGNED JJS  
DRAWN JJS  
CHECKED TD

APPROVED

NO.	DATE	APPD	DESCRIPTION

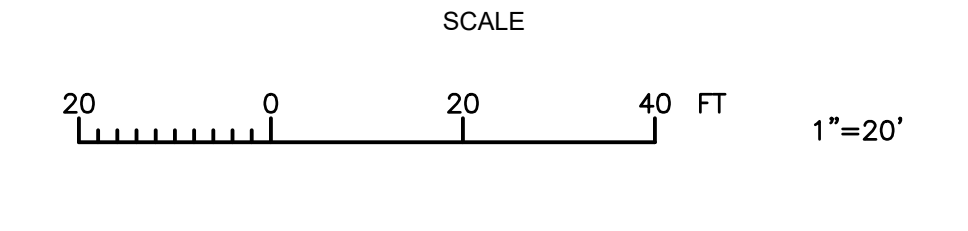

CITY OF RICHMOND, VIRGINIA  
DEPARTMENT OF PUBLIC UTILITIES  
WWTP ADMINISTRATION BUILDING



CIVIL  
PLANTING DETAILS, SCHEDULE, AND NOTES

PROJECT NO.: 0218B.16  
DWG **C108**  
SHEET 13 OF ###  
DATE NOVEMBER 2022 REV 0