



City of Richmond Department of Planning & Development Review

Location, Character, and Extent

LOCATION: The intersection of Williamsburg Ave. and E. Main St.; Nicholson St. from E. Main St. to Williamsburg Ave.

COUNCIL DISTRICT: 7

PROPOSAL: Conceptual location, character, and extent review of streetscape improvements around the intersection of Williamsburg Ave. and E. Main St. and along Nicholson St.

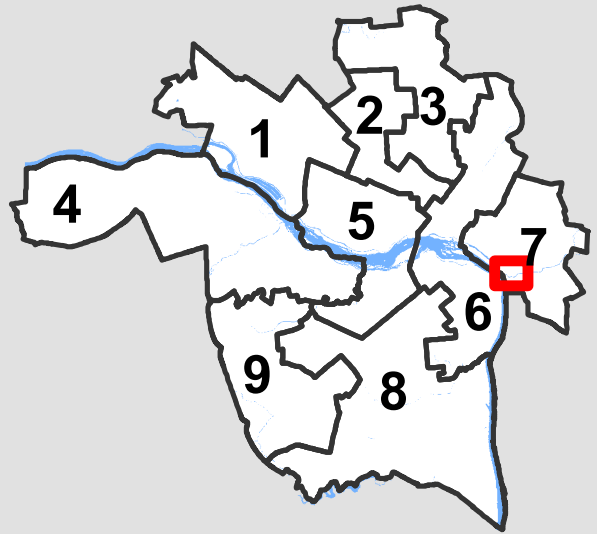

For questions, please contact Josh Son at 646-3741 or joshua.son@richmondgov.com

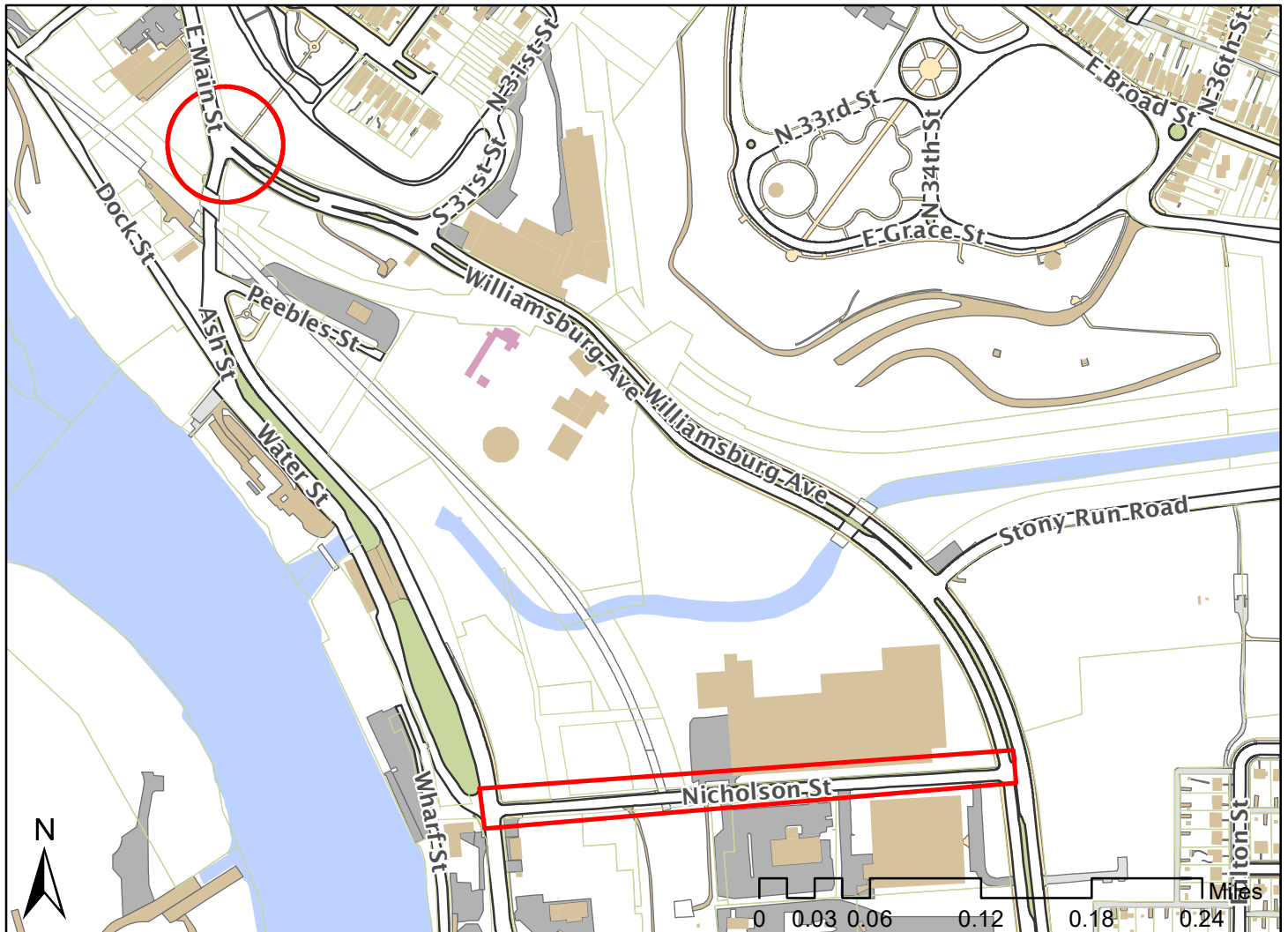



Application for URBAN DESIGN COMMITTEE Review

Department of Planning and Development Review
Planning & Preservation Division
900 E. Broad Street, Room 510
Richmond, Virginia 23219
(804) 646-6335

<http://www.richmondgov.com/CommitteeUrbanDesign>

Application Type

- Addition/Alteration to Existing Structure
 New Construction
 Streetscape
 Site Amenity

- Encroachment
 Master Plan
 Sign
 Other

Review Type

- Conceptual
 Final

Project Name: Phase I - Int. Improv. - Main St. & Wmsbrq Ave; Phase II - Nicholson St. Streetsc

Project Address: Int. Main St. & Wmsbrq Ave. and Nicholson St. (Main St to Wmsbrq Ave.)

Brief Project Description (this is not a replacement for the required detailed narrative) : _____

Phase I - The int. of Main St. (Rte. 5) and Wmsbrg Ave. will be realign as a continuous traffic movement, Phase II - Nicholson St. will be enhanced with landscaping and sidewalk on the south side of the street.

Applicant Information

(on all applications other than encroachments, a City agency representative must be the applicant)

Name: Marvin Tart Email: marvin.tart@richmondgov.com

City Agency: DPW-CIP Phone: 646-6396

Address: 900 E. Broad St., City Hall, Room 603

Main Contact (if different from Applicant): same

Company: NA Phone: NA

Email: NA

Submittal Deadlines

All applications and support materials must be filed no later than 21 days prior to the scheduled meeting of the Urban Design Committee (UDC). Please see the schedule on page 3 as actual deadlines are adjusted due to City holidays. Late or incomplete submissions will be deferred to the next meeting.

Filing

Applications can be mailed or delivered to the attention of "Urban Design Committee" at the address listed at the top of this page. It is important that the applicant discuss the proposal with appropriate City agencies, Zoning Administration staff, and area civic associations and residents prior to filing the application with the UDC.

UDC Background

The UDC is a ten member committee created by City Council in 1968 whose purpose is to advise the City Planning Commission on the design of projects on City property or right-of-way. The UDC provides advice of an aesthetic nature in connection with the performance of the duties of the Commission under Sections 17.05, 17.06 and 17.07 of the City Charter. The UDC also advises the Department of Public Works in regards to private encroachments in the public right-of-way.

East Main Street & Williamsburg Avenue Intersection Improvement Project – Phase I Nicholson Street Streetscape – Phase II

CITY OF RICHMOND

NARRATIVE

PROJECT PURPOSE

- This improvement will enhance safety by providing route continuity via an improved roadway design. The existing intersection is a source of motorist confusion which has resulted in accidents.
- To improve the intersection of **East Main Street and Williamsburg Avenue – Phase I**, specific design elements include:
 - Motorist and pedestrian safety
 - Design improvements that create a continuous flow movement through the intersection.
 - Pedestrian and bike connectivity from Libbie Hill and Poe’s Pub.
 - Full signal modernization with high visibility cross walks
 - Pavement replacement and/or mill & overlay
- To enhance **Nicholson Street – Phase II** with a streetscape design and to tie in to the improvement constructed by the East Riverfront project. Specific design elements to include:
 - Landscaping
 - On-street parking
 - Decorative lighting
 - Sidewalk extension
 - Pavement mill & overlay

PROJECT BACKGROUND

Route 5 currently routes traffic along East Main Street until it turns into Old Osborne Turnpike east of Rockett’s Landing. There are developments planned along the East Riverfront corridor on East Main Street. The redesigned intersection will continue to allow access to the East Riverfront corridor and improve the connection of the traffic flow from East Main Street to Williamsburg Avenue.

The City’s current plan is divided into two phases. Phase I is the intersection improvements at East Main Street and Williamsburg Avenue, and Phase II is the streetscape design on Nicholson Street.

PROJECT FUNDING SOURCE

The intersection improvement project will be funded using state revenue sharing funds. The preparation and documentation of all necessary environmental documents, project development phases and permitting will be completed as required when utilizing state funds.

Funding – Revenue Sharing:

PE - 475,000
RW - 200,000
CON - 1,625,000
TOTAL – 2,300,000

PROJECT CONSTRUCTION DESCRIPTION

Phase I is the intersection improvements at East Main Street/Williamsburg Avenue. This phase begins west of the existing intersection and terminates at 31st Street to the east. It will also tie in what will now be the intersecting East Main Street and connect into the newly reconstructed bridge over Norfolk Southern Railroad. Phase I will be built in stages requiring the use of detours for the East Main Street connection due to grade adjustments at the intersection.

Phase II is the streetscape design of Nicholson Street. This phase begins at the intersection of Williamsburg Avenue and will terminate just past the railroad (CSX) trestle, where it ties into the East Riverfront project improvements.

PROJECT SCHEDULE

The project shall be developed in accordance with the following proposed schedule:

60% Plans	September 2018
Final UDC Meeting	November 2018
Environmental Documents Complete	December 2018
Final Plans	January 2019
Advertisement	February 2019

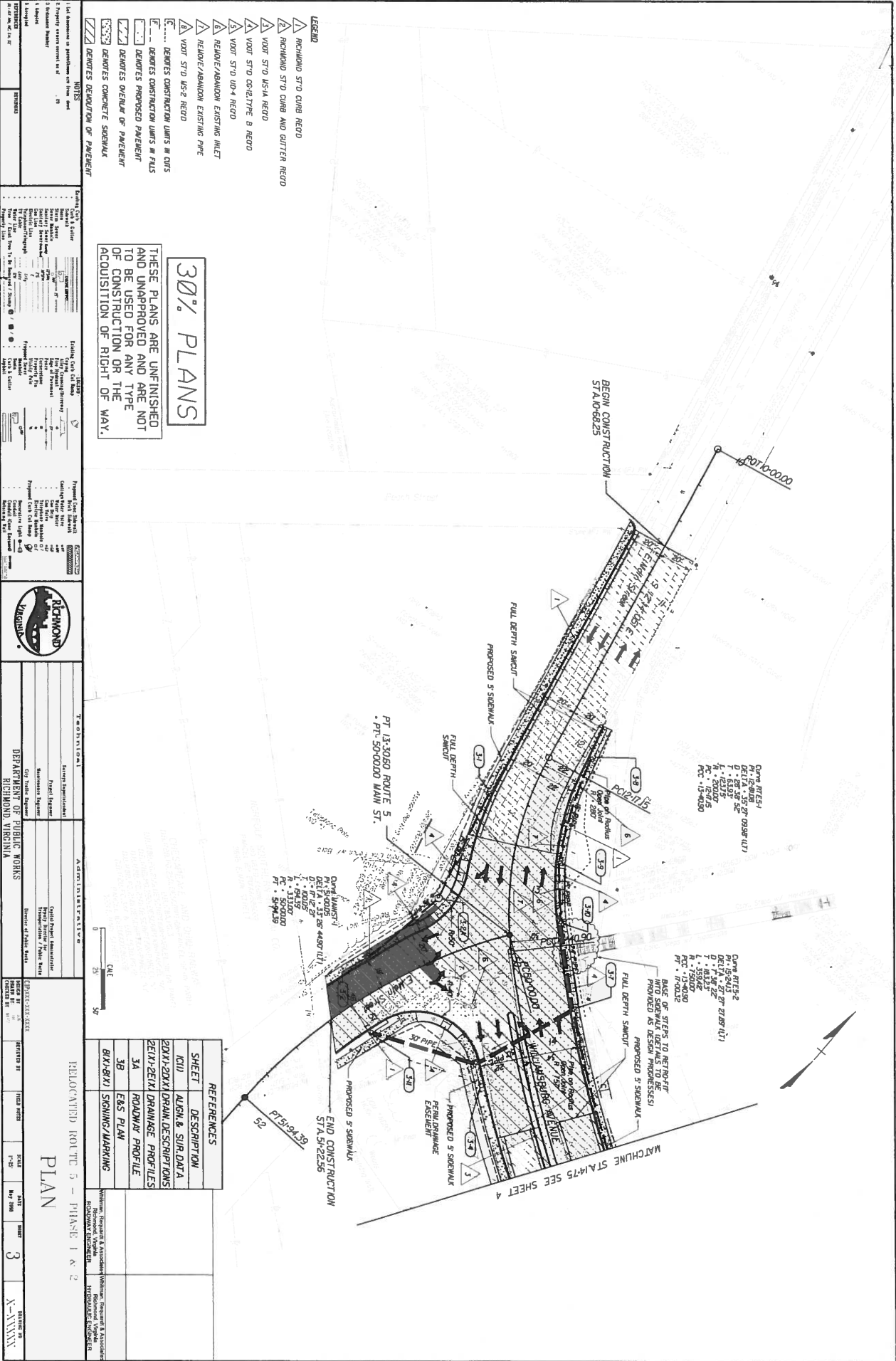

- LEGEND**
- ▲ RICHMOND STD CURB REGD
 - ▲ RICHMOND STD CURB AND CUTTER REGD
 - ▲ VDOT STD USA4 REGD
 - ▲ VDOT STD CR-2/TYPE B REGD
 - ▲ VDOT STD US-4 REGD
 - ▲ RELIEF/ABANDON EXISTING INLET
 - ▲ VDOT STD US-2 REGD
 - ▲ ... DENOTES CONSTRUCTION LIMITS IN CURS
 - ▲ ... DENOTES PROPOSED PAVEMENT
 - ▲ ... DENOTES OVERLAY OF PAVEMENT
 - ▲ ... DENOTES CONCRETE SIDEWALK
 - ▲ ... DENOTES REDUCTION OF PAVEMENT

30% PLANS

THESE PLANS ARE UNFINISHED AND UNAPPROVED AND ARE NOT TO BE USED FOR ANY TYPE OF CONSTRUCTION OR THE ACQUISITION OF RIGHT OF WAY.

- NOTES**
1. All dimensions in parentheses are from best available information.
 2. Property owner name as of 1/1/2010.
 3. Contour interval 2.0 feet.
 4. Vertical curve data as shown.
 5. Stationing as shown.
 6. All dimensions in parentheses are from best available information.
 7. All dimensions in parentheses are from best available information.
 8. All dimensions in parentheses are from best available information.
 9. All dimensions in parentheses are from best available information.
 10. All dimensions in parentheses are from best available information.

EXISTING DATA

Survey	ASCE 9000
Scale	ASCE 9000
Method	ASCE 9000
Control	ASCE 9000
Accuracy	ASCE 9000
Horizontal	ASCE 9000
Vertical	ASCE 9000
Horizontal	ASCE 9000
Vertical	ASCE 9000
Horizontal	ASCE 9000
Vertical	ASCE 9000

PROPOSED DATA

Survey	ASCE 9000
Scale	ASCE 9000
Method	ASCE 9000
Control	ASCE 9000
Accuracy	ASCE 9000
Horizontal	ASCE 9000
Vertical	ASCE 9000
Horizontal	ASCE 9000
Vertical	ASCE 9000
Horizontal	ASCE 9000
Vertical	ASCE 9000

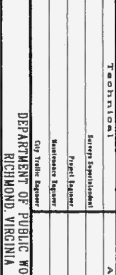

APPROVED

Project Engineer	ASCE 9000
Senior Designer	ASCE 9000
Designer	ASCE 9000
Checker	ASCE 9000
Planner	ASCE 9000
Estimator	ASCE 9000
Quantity Surveyor	ASCE 9000
Construction Manager	ASCE 9000
Inspector	ASCE 9000
Asst. Inspector	ASCE 9000
Materials Inspector	ASCE 9000
Quality Control	ASCE 9000
Records Manager	ASCE 9000
Office Manager	ASCE 9000
Secretary	ASCE 9000
Janitor	ASCE 9000
Driver	ASCE 9000
Other	ASCE 9000

REFERENCES

SHEET	DESCRIPTION
IC11	ALIGN. & SUR. DATA
IC12	20XX-20XX DRAIN. DESCRIPTIONS
IC13	20XX-20XX DRAINAGE PROFILES
3A	ROADWAY PROFILE
3B	E&S PLAN
3C	30% PLAN
3D	30% PLAN
3E	30% PLAN
3F	30% PLAN
3G	30% PLAN
3H	30% PLAN
3I	30% PLAN
3J	30% PLAN
3K	30% PLAN
3L	30% PLAN
3M	30% PLAN
3N	30% PLAN
3O	30% PLAN
3P	30% PLAN
3Q	30% PLAN
3R	30% PLAN
3S	30% PLAN
3T	30% PLAN
3U	30% PLAN
3V	30% PLAN
3W	30% PLAN
3X	30% PLAN
3Y	30% PLAN
3Z	30% PLAN

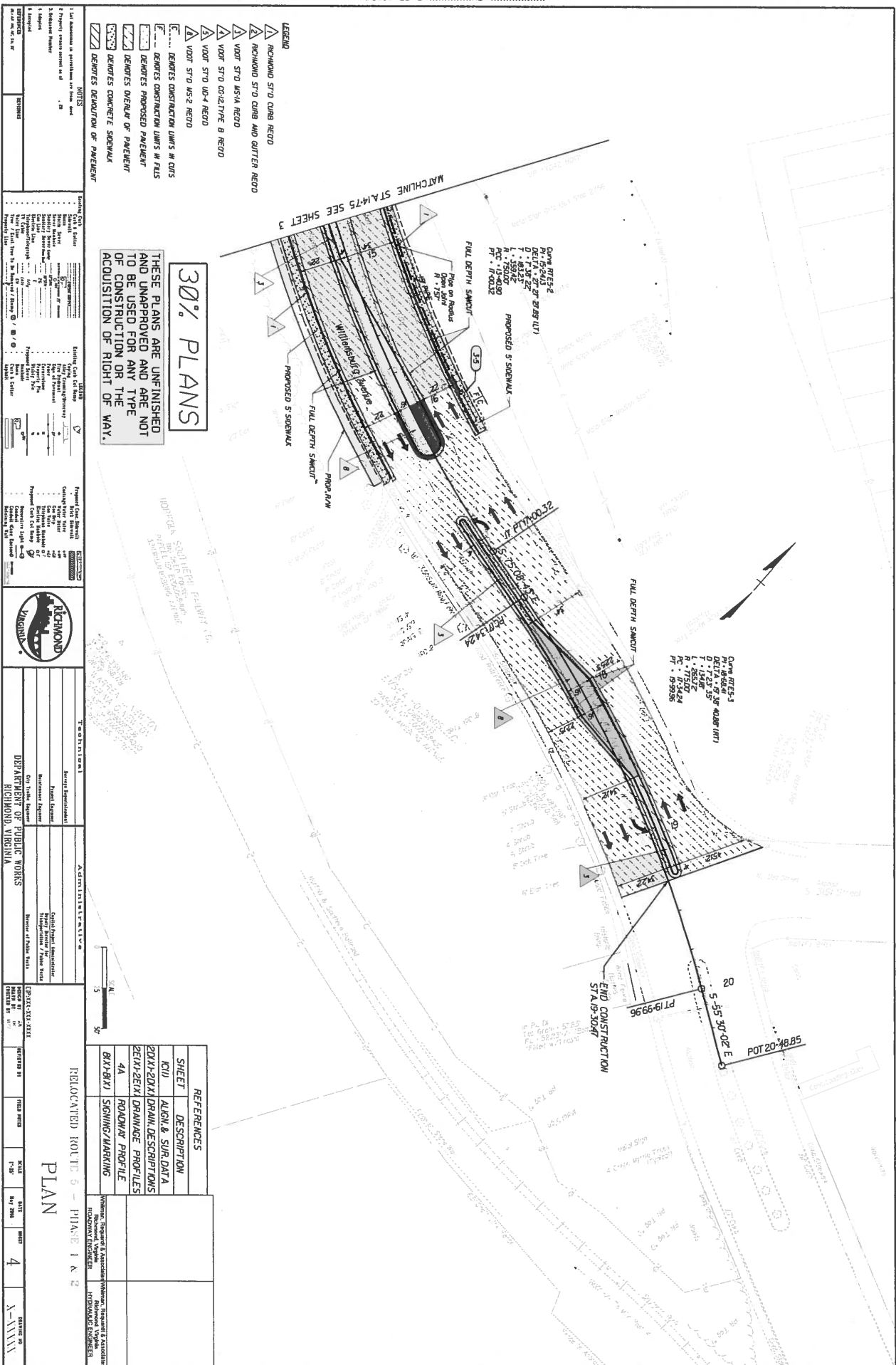

30% PLANS

THESE PLANS ARE UNFINISHED AND UNAPPROVED AND ARE NOT TO BE USED FOR ANY TYPE OF CONSTRUCTION OR THE ACQUISITION OF RIGHT OF WAY.

- LEGEND**
- ▷ RICHMOND STD CURB REGD
 - ▷ RICHMOND STD CURB AND GUTTER REGD
 - ▷ VORT STO USA REGD
 - ▷ VORT STO COXIALTIVE B REGD
 - ▷ VORT STO US-4 REGD
 - ▷ VORT STO MS-2 REGD
 - C... DENOTES CONSTRUCTION LIMITS IN CUTS
 - E... DENOTES PROPOSED PAVEMENT
 - D... DENOTES EXISTING PAVEMENT
 - ██ DENOTES CONCRETE SIDEWALK
 - ██ DENOTES DEMOLITION OF PAVEMENT
- NOTES**
- 1. All dimensions in parenthesis are from end of proposed feature to centerline.
 - 2. Proposed features shown in red.
 - 3. Existing features shown in black.
 - 4. All elevations are in feet.

DATE	BY	DESCRIPTION



DEPARTMENT OF PUBLIC WORKS
 RICHMOND, VIRGINIA

ADMINISTRATIVE
 DATE: 12/28/2011
 TIME: 10:00 AM

SHEET	DESCRIPTION	DATE	BY	CHKD BY	APP'D BY

RELAYED: KOLLE 5 - PHASE 1 & 2
 PLAN

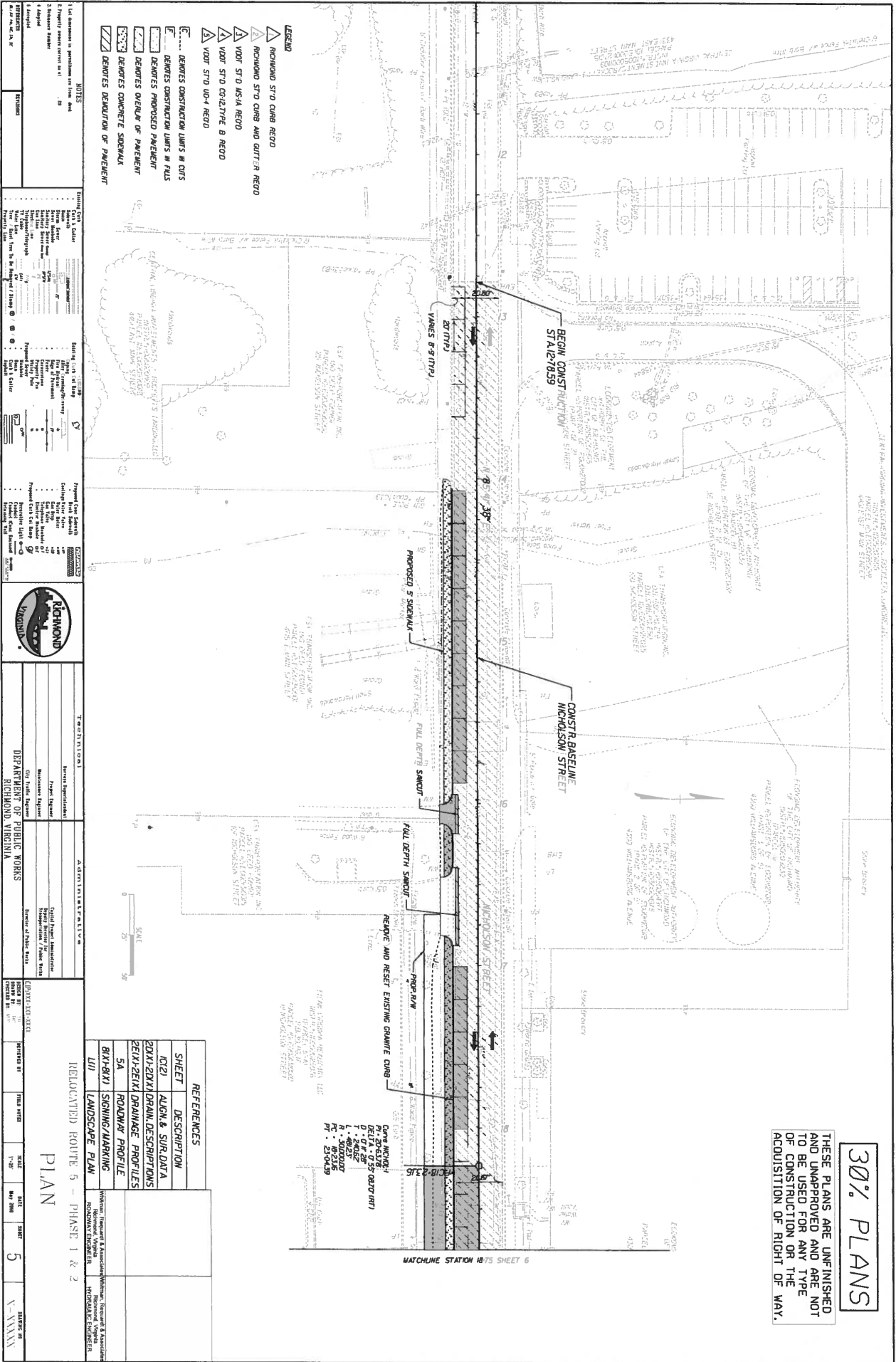

30% PLANS

THESE PLANS ARE UNFINISHED AND UNAPPROVED AND ARE NOT TO BE USED FOR ANY TYPE OF CONSTRUCTION OR THE ACQUISITION OF RIGHT OF WAY.

REFERENCES	
SHEET	DESCRIPTION
ALPH. & SUR. DATA	
20XX-20XX DRAIN DESCRIPTIONS	
20XX-20XX DRAINAGE PROFILES	
ROADWAY PROFILE	
SIGNING/MARKING	

DATE	10/20/2011
PROJECT	RELOCATED ROUTE 5 - PHASE 1 & 2
SHEET	5
DATE	10/20/2011

SURVEYED BY: ...H&B SURVEYING AND MAPPING...
 SUPERVISED BY: ...MSV...
 DESIGNED BY: ...ADW...

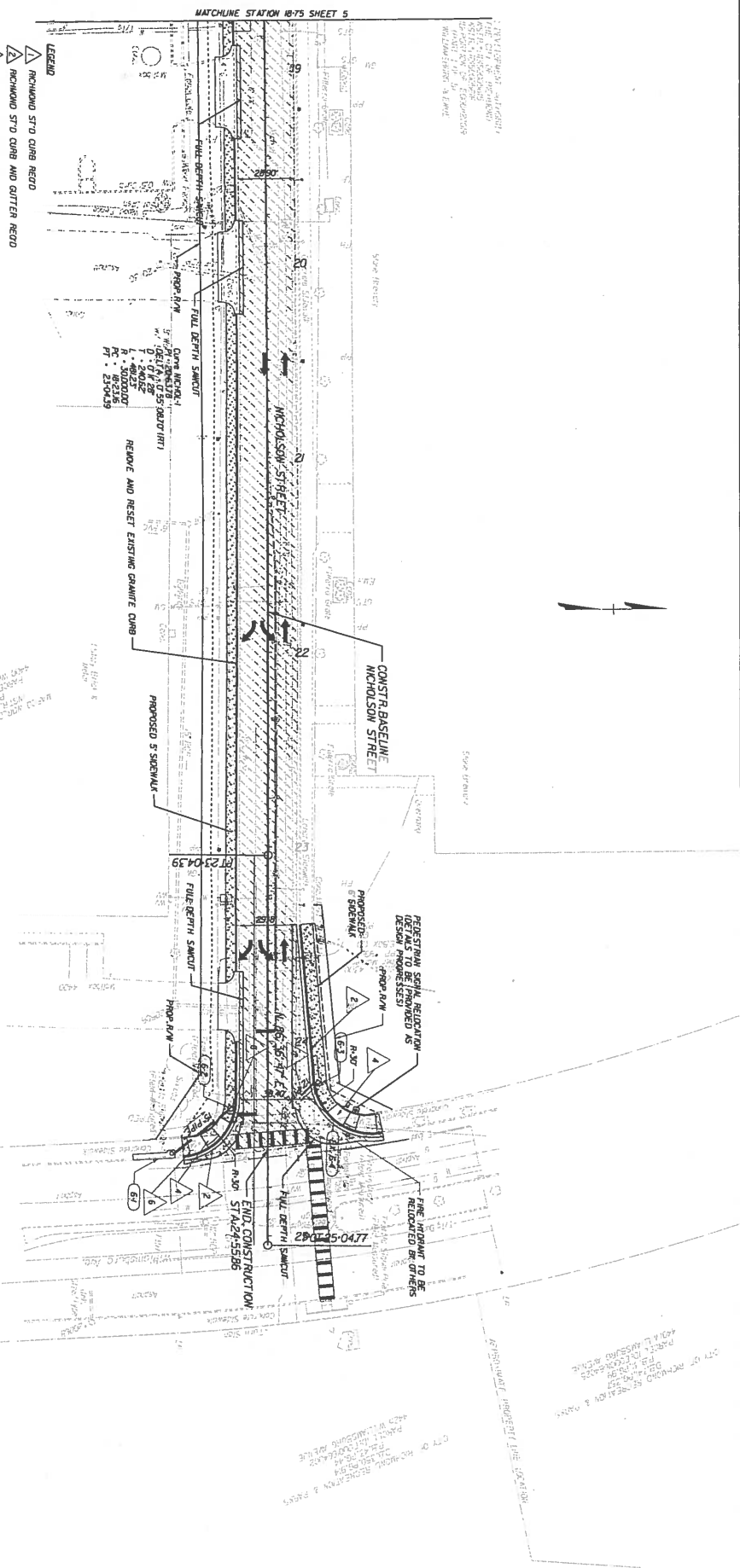

Richmond Virginia logo

DEPARTMENT OF PUBLIC WORKS
 RICHMOND, VIRGINIA

PROJECT: RICHMOND STREETS & PARKS
 PHASE: 1 A 2

SCALE: 1" = 20'

DATE: 11/11/11

PROJECT NO: 11-11-11

PHASE: 1 A 2

PLAN

SHEET	DESCRIPTION
K12	ALIGN. & SURF DATA
20XX-20XX	DRAINAGE DESCRIPTIONS
20XX-20XX	DRAINAGE PROFILES
6A	ROADWAY PROFILE
8X1-8X1	SIGNING/MARKING
U31	LANDSCAPE PLAN

Charleston (1237) Specification Sheet

Project Name: MFG Philips Lighting
 Location: CNY
 Catalog No.:
 City:

Ordering Guide
 Example: 4237-ABE-A-D-H-E-B

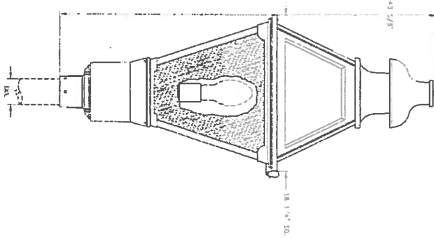

Product Code	1237	Finish	1237	Material
ABE	Antique Brass	ASB	Antique Brass	Cast Aluminum
ASB	Antique Brass	ASL	Antique Silver	Cast Aluminum
ASL	Antique Silver	BRZ	Brass	Cast Aluminum
BRZ	Brass	FCN	Forest Green	Cast Aluminum
FCN	Forest Green	IRN	Iron	Cast Aluminum
IRN	Iron	BRZ	Rustic Bronze	Cast Aluminum
BRZ	Rustic Bronze	VCU	Vermont Copper	Cast Aluminum
VCU	Vermont Copper	VICU	Verde Copper	Cast Aluminum
VICU	Verde Copper	WBZ	Weathered Bronze	Cast Aluminum
WBZ	Weathered Bronze	WHT	White	Cast Aluminum
WHT	White			

Finish/Color	A	B	C	D	E	F	G	H	I	J	K	L	M	N	O
Material	Clear Acrylic	Opal Acrylic	Opal Acrylic	Opal Acrylic	Opal Acrylic	Opal Acrylic	Opal Acrylic	Opal Acrylic	Opal Acrylic	Opal Acrylic	Opal Acrylic	Opal Acrylic	Opal Acrylic	Opal Acrylic	Opal Acrylic
Finish/Color	Clear Acrylic	Opal Acrylic	Opal Acrylic	Opal Acrylic	Opal Acrylic	Opal Acrylic	Opal Acrylic	Opal Acrylic	Opal Acrylic	Opal Acrylic	Opal Acrylic	Opal Acrylic	Opal Acrylic	Opal Acrylic	Opal Acrylic
Material	Cast Aluminum	Cast Aluminum	Cast Aluminum	Cast Aluminum	Cast Aluminum	Cast Aluminum	Cast Aluminum	Cast Aluminum	Cast Aluminum	Cast Aluminum	Cast Aluminum	Cast Aluminum	Cast Aluminum	Cast Aluminum	Cast Aluminum

PHILIPS
 Copyright © 2014 Koninklijke Philips N.V. (Royal Philips). All rights reserved. Specifications are subject to change without notice.
 Philips Lighting Company, 200 Franklin Square Drive, Somerset, NJ 08873 | P: +1-855-486-2716 | www.philips.com/lighting

NOTES

1. List dimensions in parentheses on line and
2. Property values given on line and
3. Release number
4. Legend

Material: 1237

Charleston (1237) Specification Sheet

Project Name: MFG Philips Lighting
 Location: CNY
 Catalog No.:
 City:

None

Specifications

CONSTRUCTION: This luminaire is constructed with cast aluminum solid (hinged) roof for easy cleaning. Cast aluminum top & bottom cage frames. Cast aluminum post (see spec for O.D. post or iron).

FINISH: ETL Listed powder coated (optional) finish is electrocoat applied in grey/white. Specialty finishes are available for Philips Outdoor Lighting. It provides UV protection, and the highest temperature rating in the industry. In addition to the standard color choices shown, a spectrum of custom colors is available.

PANELS: ENIGI CODE: See manual for available options.

LAMPING: Lamp is not included.

ELECTRICAL ASSEMBLY: Luminaire will be prewired and tested. All electrical components are ETL listed.

BALL AST: Ballast and component parts mounted inside 3-piece cast aluminum moisture proof ballast compartment with hinged access door and slide-out ballast tray. (Customer must specify wattage and voltage.)

MOUNTING: Fixture mounts to 3" dia. post or iron.

WARRANTY: Three-year limited warranty.

CERTIFICATIONS: ETL Listed to U.S. safety standards for wet locations. ETL Listed to Canadian safety standards for wet locations.

Height: 42.58"

Width: 10.16"

EPA: 2.28

Max. Weight: 40 lbs.

PHILIPS
 Copyright © 2014 Koninklijke Philips N.V. (Royal Philips). All rights reserved. Specifications are subject to change without notice.
 Philips Lighting Company, 200 Franklin Square Drive, Somerset, NJ 08873 | P: +1-855-486-2716 | www.philips.com/lighting

TECHNICAL

RELOCATED ROUTING 5 - PHASIS 1 & 2

LIGHTING DETAILS

DATE: 9/20/11

BY: X

DATE: X

BY: X

DATE: X

BY: X

30% PLANS

THESE PLANS ARE UNFINISHED AND UNAPPROVED AND ARE NOT TO BE USED FOR CONSTRUCTION OR THE ACQUISITION OF RIGHT OF WAY.

SURVEYED BY:..CITY OF RICHMOND..
 SUPERVISED BY:.....MSV.....
 DESIGNED BY:.....ADW.....



NOTE:
 LIGHTING DESIGN PENDING
 COORDINATION WITH OVERHEAD
 UTILITY RELOCATION DESIGN.

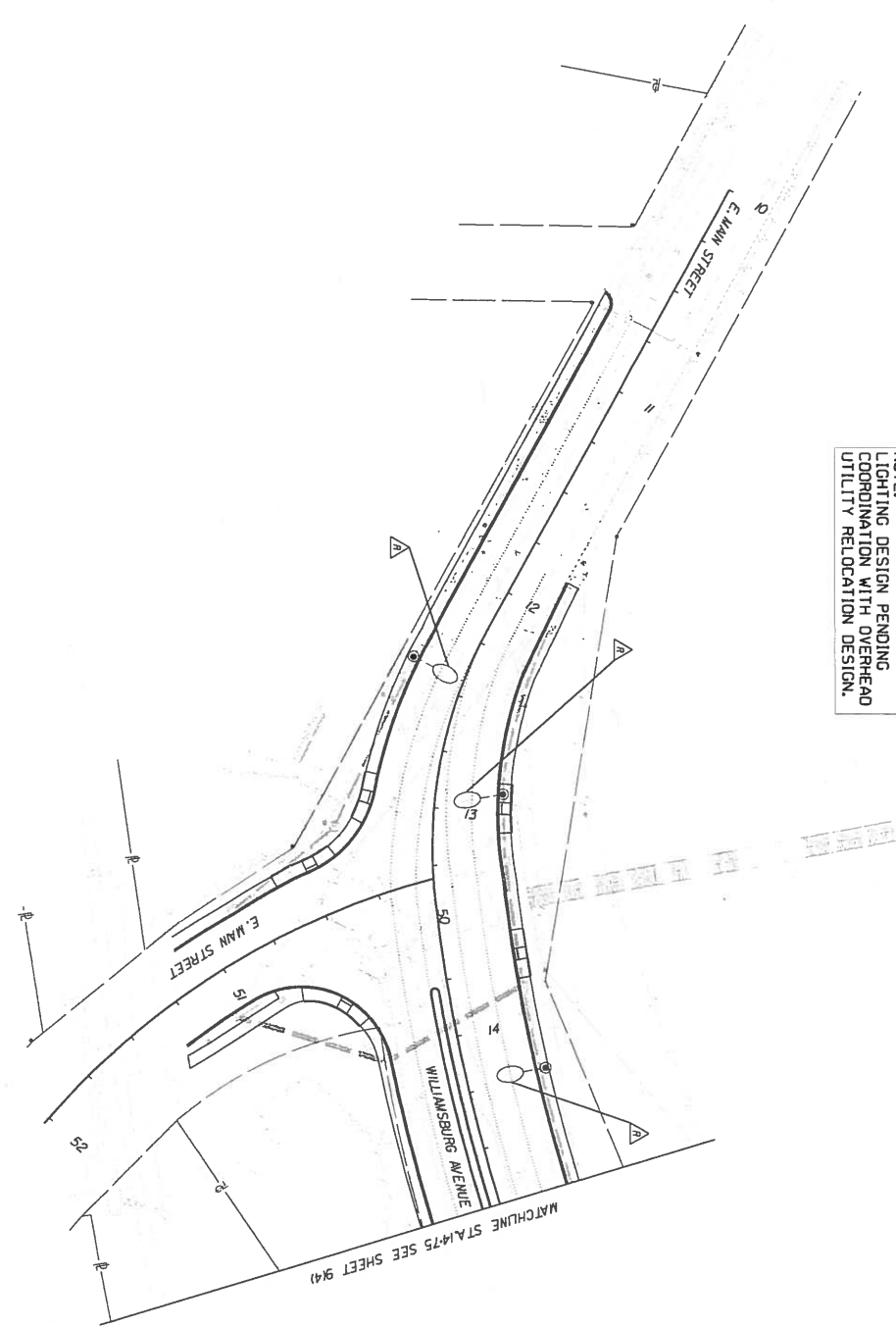

THESE PLANS ARE UNFINISHED
 AND UNAPPROVED AND ARE NOT
 TO BE USED FOR ANY TYPE
 OF CONSTRUCTION OR THE
 ACQUISITION OF RIGHT OF WAY.

30% PLANS

△ INDICATES EXISTING STREET LIGHT TO BE REMOVED
 △ INDICATES EXISTING STREET LIGHT TO REMAIN

NOTES

1. All dimensions in parentheses are from curb.
2. Property owner's name, if any.
3. Utility symbols.
4. Symbols.
5. Symbols.

EXISTING	PROPOSED
Existing Pole Details	Proposed Pole Details
Existing Pole Location	Proposed Pole Location
Existing Pole Height	Proposed Pole Height
Existing Pole Spacing	Proposed Pole Spacing
Existing Pole Type	Proposed Pole Type
Existing Pole Material	Proposed Pole Material
Existing Pole Finish	Proposed Pole Finish
Existing Pole Color	Proposed Pole Color
Existing Pole Diameter	Proposed Pole Diameter
Existing Pole Weight	Proposed Pole Weight
Existing Pole Strength	Proposed Pole Strength
Existing Pole Life	Proposed Pole Life
Existing Pole Maintenance	Proposed Pole Maintenance
Existing Pole Replacement	Proposed Pole Replacement
Existing Pole Removal	Proposed Pole Removal
Existing Pole Installation	Proposed Pole Installation
Existing Pole Inspection	Proposed Pole Inspection
Existing Pole Testing	Proposed Pole Testing
Existing Pole Certification	Proposed Pole Certification
Existing Pole Approval	Proposed Pole Approval
Existing Pole Permit	Proposed Pole Permit
Existing Pole License	Proposed Pole License
Existing Pole Insurance	Proposed Pole Insurance
Existing Pole Bond	Proposed Pole Bond
Existing Pole Surety	Proposed Pole Surety
Existing Pole Guaranty	Proposed Pole Guaranty
Existing Pole Indemnity	Proposed Pole Indemnity
Existing Pole Release	Proposed Pole Release
Existing Pole Waiver	Proposed Pole Waiver
Existing Pole Assignment	Proposed Pole Assignment
Existing Pole Subcontract	Proposed Pole Subcontract
Existing Pole Agreement	Proposed Pole Agreement
Existing Pole Contract	Proposed Pole Contract
Existing Pole Order	Proposed Pole Order
Existing Pole Invoice	Proposed Pole Invoice
Existing Pole Receipt	Proposed Pole Receipt
Existing Pole Statement	Proposed Pole Statement
Existing Pole Certificate	Proposed Pole Certificate
Existing Pole License	Proposed Pole License
Existing Pole Permit	Proposed Pole Permit
Existing Pole Approval	Proposed Pole Approval
Existing Pole Inspection	Proposed Pole Inspection
Existing Pole Testing	Proposed Pole Testing
Existing Pole Certification	Proposed Pole Certification
Existing Pole Approval	Proposed Pole Approval



DEPARTMENT OF PUBLIC WORKS
 RICHMOND, VIRGINIA

PROJECT NO.	111
DATE	11/11/11
SCALE	1"=25'
SHEET NO.	9(3)
TOTAL SHEETS	9(3)
DATE	11/11/11
SCALE	1"=25'
SHEET NO.	9(3)
TOTAL SHEETS	9(3)
DATE	11/11/11
SCALE	1"=25'
SHEET NO.	9(3)
TOTAL SHEETS	9(3)

RELOCATED ROUTE 5 - PHASE 1 & 2
 LIGHTING PLAN

SURVEYED BY: ...CITY OF RICHMOND..
 SUPERVISED BY: ...MSV..
 DESIGNED BY: ...ADW..

NOTE:
 LIGHTING DESIGN PENDING
 COORDINATION WITH OVERHEAD
 UTILITY RELOCATION DESIGN.

△ INDICATES EXISTING STREET LIGHT TO BE REMOVED
 △ INDICATES EXISTING STREET LIGHT TO REMAIN

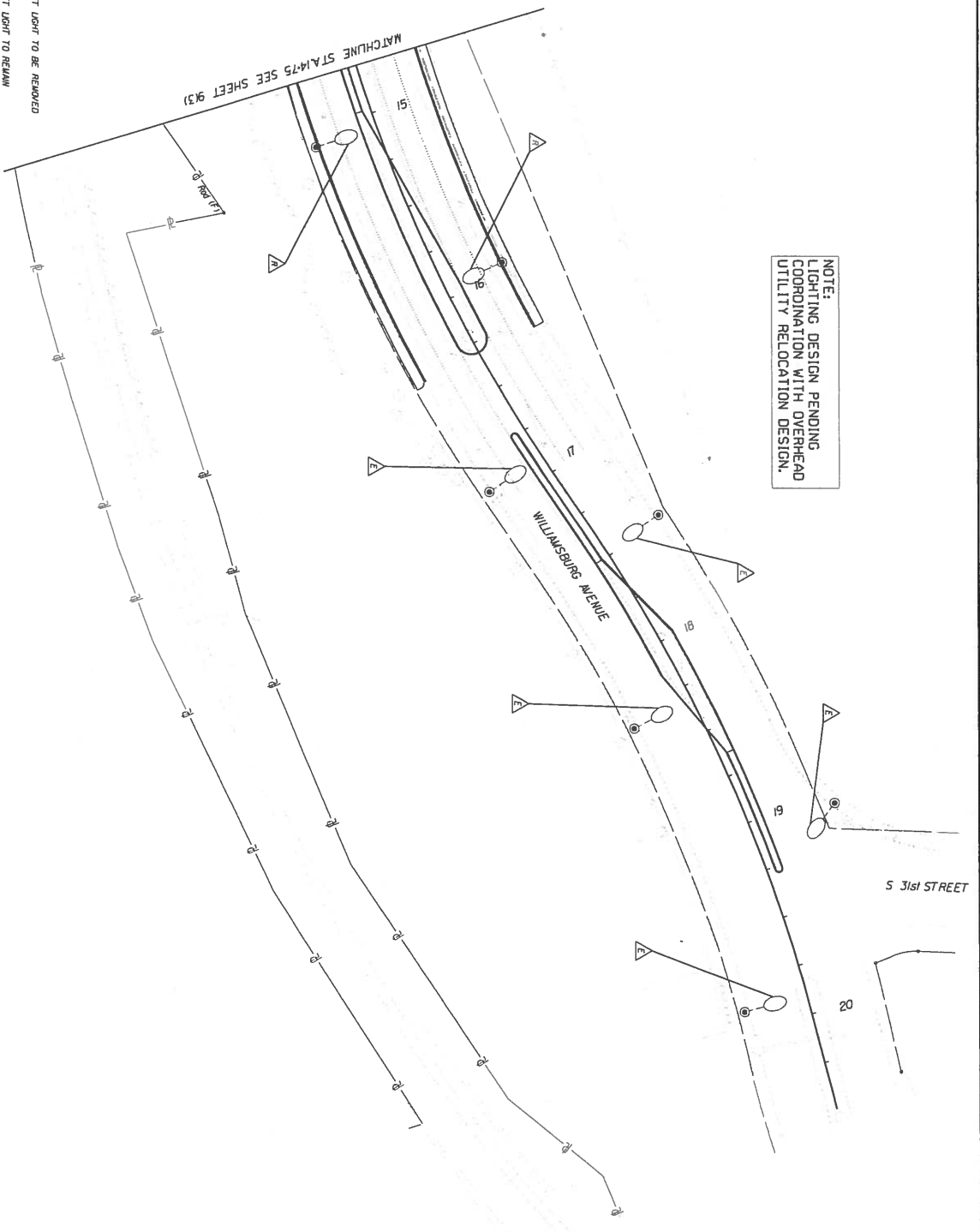

THESE PLANS ARE UNFINISHED
 AND UNAPPROVED AND ARE NOT
 TO BE USED FOR ANY TYPE
 OF CONSTRUCTION OR THE
 ACQUISITION OF RIGHT OF WAY.

30% PLANS

NOTES

1. All dimensions in parentheses are from the
2. Property / Street center line as at
3. Existing center
4. Proposed

REVISIONS

NO.	DATE	DESCRIPTION

EXISTING DATA

STREET NAME	WILLIAMSBURG AVENUE
STREET TYPE	
STREET WIDTH	
STREET CENTERLINE	
STREET RIGHT-OF-WAY	
STREET CURB	
STREET SIDEWALK	
STREET LIGHTING	
STREET SIGNAGE	
STREET UTILITIES	

PROPOSED DATA

STREET NAME	WILLIAMSBURG AVENUE
STREET TYPE	
STREET WIDTH	
STREET CENTERLINE	
STREET RIGHT-OF-WAY	
STREET CURB	
STREET SIDEWALK	
STREET LIGHTING	
STREET SIGNAGE	
STREET UTILITIES	



DEPARTMENT OF PUBLIC WORKS
 RICHMOND, VIRGINIA

Project Engineer	
Project Designer	
Project Checker	
Project Approver	

REPLICATED ROUTE 5 - PHASE 1 & 2
 LIGHTING PLAN

DATE	NO.	SHEET	DATE

9(4)

SURVEYED BY: ..CITY OF RICHMOND..
 SUPERVISED BY: ..MSV.....
 DESIGNED BY: ..ADW.....

THESE PLANS ARE UNFINISHED
 AND UNAPPROVED AND ARE NOT
 TO BE USED FOR ANY TYPE
 OF CONSTRUCTION OR THE
 ACQUISITION OF RIGHT OF WAY.

30% PLANS

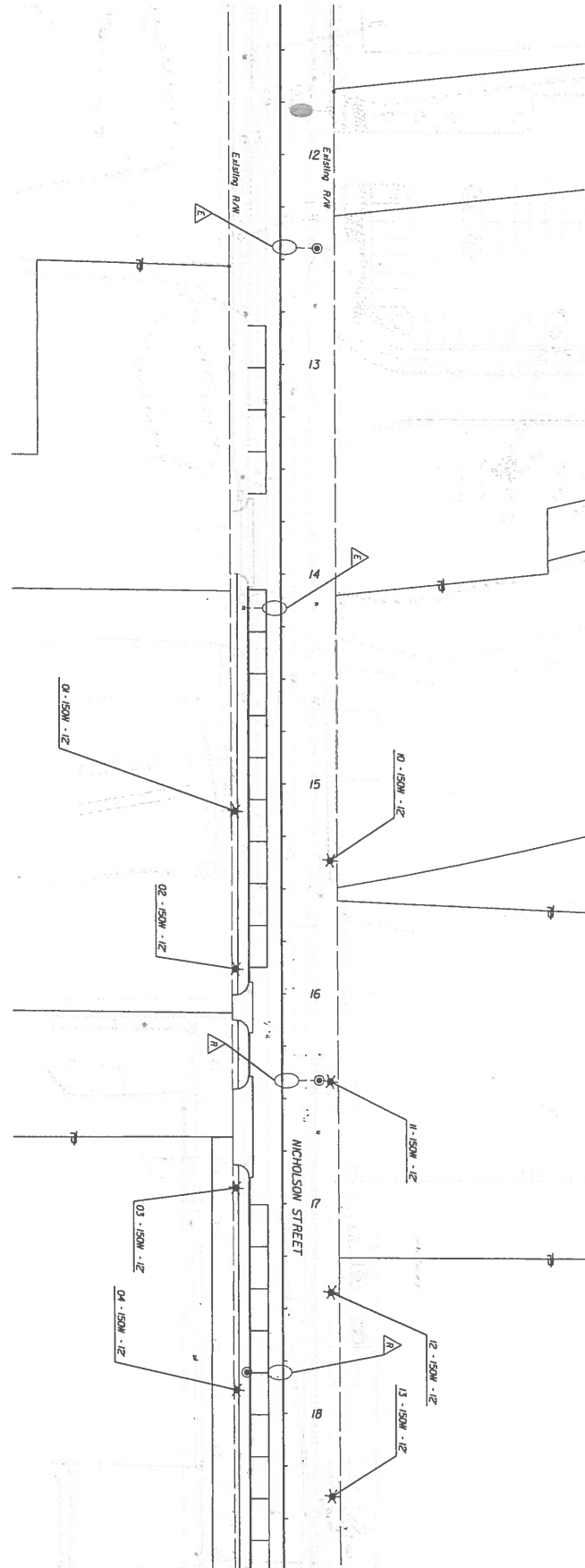

MATCHLINE STATION 18+75 SHEET 916J

INDICATES EXISTING STREET LIGHT TO BE REPAIRED
 INDICATES EXISTING STREET LIGHT TO BE REMOVED

NOTES	
1. All dimensions in parentheses are from date	
2. Property owner's name	
3. Reference number	
4. Elevation	
5. Elevation	
6. Elevation	
7. Elevation	
8. Elevation	
9. Elevation	
10. Elevation	
11. Elevation	
12. Elevation	
13. Elevation	
14. Elevation	
15. Elevation	
16. Elevation	
17. Elevation	
18. Elevation	
19. Elevation	
20. Elevation	
21. Elevation	
22. Elevation	
23. Elevation	
24. Elevation	
25. Elevation	
26. Elevation	
27. Elevation	
28. Elevation	
29. Elevation	
30. Elevation	
31. Elevation	
32. Elevation	
33. Elevation	
34. Elevation	
35. Elevation	
36. Elevation	
37. Elevation	
38. Elevation	
39. Elevation	
40. Elevation	
41. Elevation	
42. Elevation	
43. Elevation	
44. Elevation	
45. Elevation	
46. Elevation	
47. Elevation	
48. Elevation	
49. Elevation	
50. Elevation	



DEPARTMENT OF PUBLIC WORKS
 RICHMOND, VIRGINIA

PROJECT NO. 100-100-100
 SHEET NO. 100-100-100

DATE: 10/10/10

SCALE: 1" = 30'

9(5)

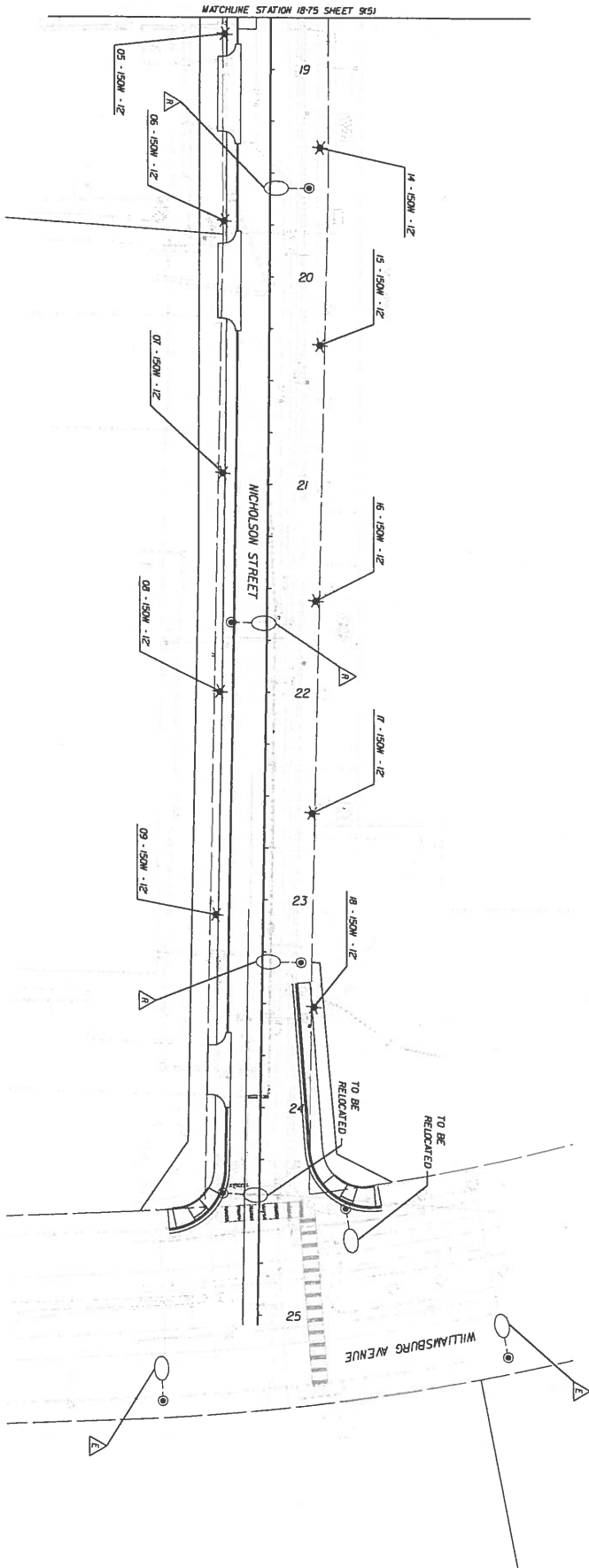

INDICATES EXISTING STREET LIGHT TO BE REMOVED
 INDICATES EXISTING STREET LIGHT TO BE RELOCATED

NOTES 1. All dimensions in parentheses are from back of property unless noted as ft. 2. Proposed street shown as ft. 3. Easement shown as ft. 4. Right-of-way shown as ft.		EXISTING DATA Stationing Right-of-way Easement Utility Structure Other		PROPOSED DATA Stationing Right-of-way Easement Utility Structure Other		DEPARTMENT OF PUBLIC WORKS Director Assistant Director Chief Engineer Traffic Engineer Planning Engineer Survey Engineer Inspection Engineer Maintenance Engineer Construction Engineer Safety Engineer Environmental Engineer Information Systems Engineer Public Works Engineer Traffic Engineer Planning Engineer Survey Engineer Inspection Engineer Maintenance Engineer Construction Engineer Safety Engineer Environmental Engineer Information Systems Engineer Public Works Engineer		SCALE 1" = 25' 1" = 50'	
PROJECT LIGHTING ROUTE 5 - PHASE 1 & 2		DATE 9/6		SCALE 1" = 25' 1" = 50'		PROJECT NO. 9(6)		DATE 9/6	

30% PLANS
 THESE PLANS ARE UNFINISHED AND UNAPPROVED AND ARE NOT TO BE USED FOR ANY TYPE OF CONSTRUCTION OR THE ACQUISITION OF RIGHT OF WAY.

30% PLANS

THESE PLANS ARE UNFINISHED
 AND UNAPPROVED AND ARE NOT
 TO BE USED FOR ANY TYPE
 OF CONSTRUCTION OR THE
 ACQUISITION OF RIGHT OF WAY.

NO.	DESCRIPTION	DATE	BY
1	Let documents in production for final bid
2	Final plans issued
3	Revised plans
4	As built
5	Revised

OWNER		DESIGNER		CONSULTANT	
NAME	ADDRESS	NAME	ADDRESS	NAME	ADDRESS
PROJECT NO.		PROJECT NO.		PROJECT NO.	
CITY		CITY		CITY	
STATE		STATE		STATE	
COUNTY		COUNTY		COUNTY	
ZONE		ZONE		ZONE	



CONSULTANT		ADMINISTRATIVE	
NAME	ADDRESS	NAME	ADDRESS
CITY		CITY	
STATE		STATE	
COUNTY		COUNTY	

PROJECT NO.	SHEET NO.	TITLE
DATE	SCALE	BY
APPROVED BY	CHECKED BY	DRAWN BY
RELOCATED ROUTE 5 PHASE I & II PLANTING PLAN		
DATE	SCALE	BY
APPROVED BY	CHECKED BY	DRAWN BY

SCALE
 0 25 50

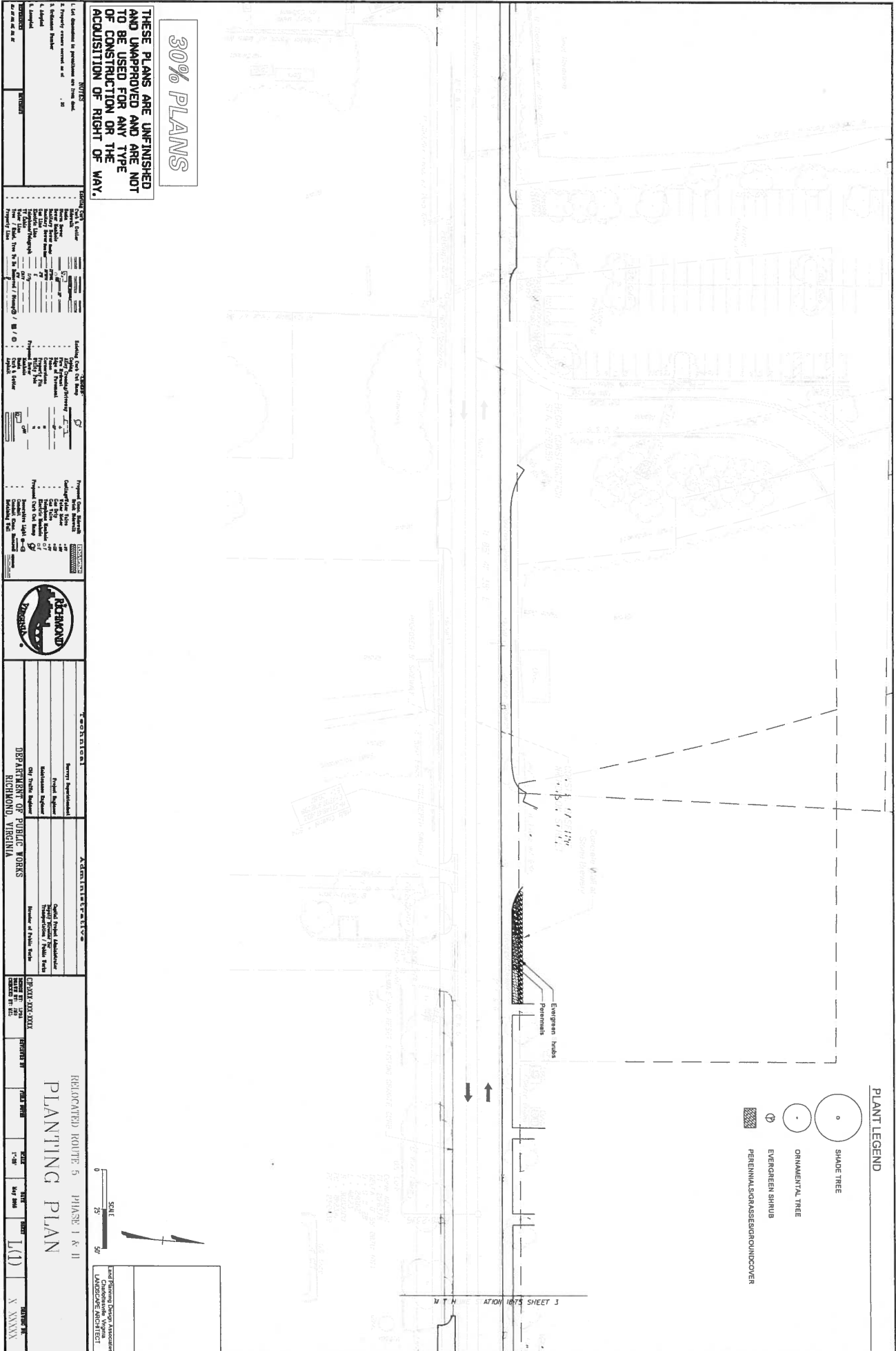
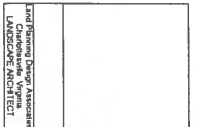





PLANT LEGEND

- SHADE TREE
- ORNAMENTAL TREE
- EVERGREEN SHRUB
- PERENNIAL GRASS
- GROUNDCOVER

SUPERVISED BY: MSV
 DESIGNED BY: ADW

PLANT LEGEND

-  SHADE TREE
-  ORNAMENTAL TREE
-  EVERGREEN SHRUB
-  PERENNIALS/GIRASSOLE/GROUNDCOVER

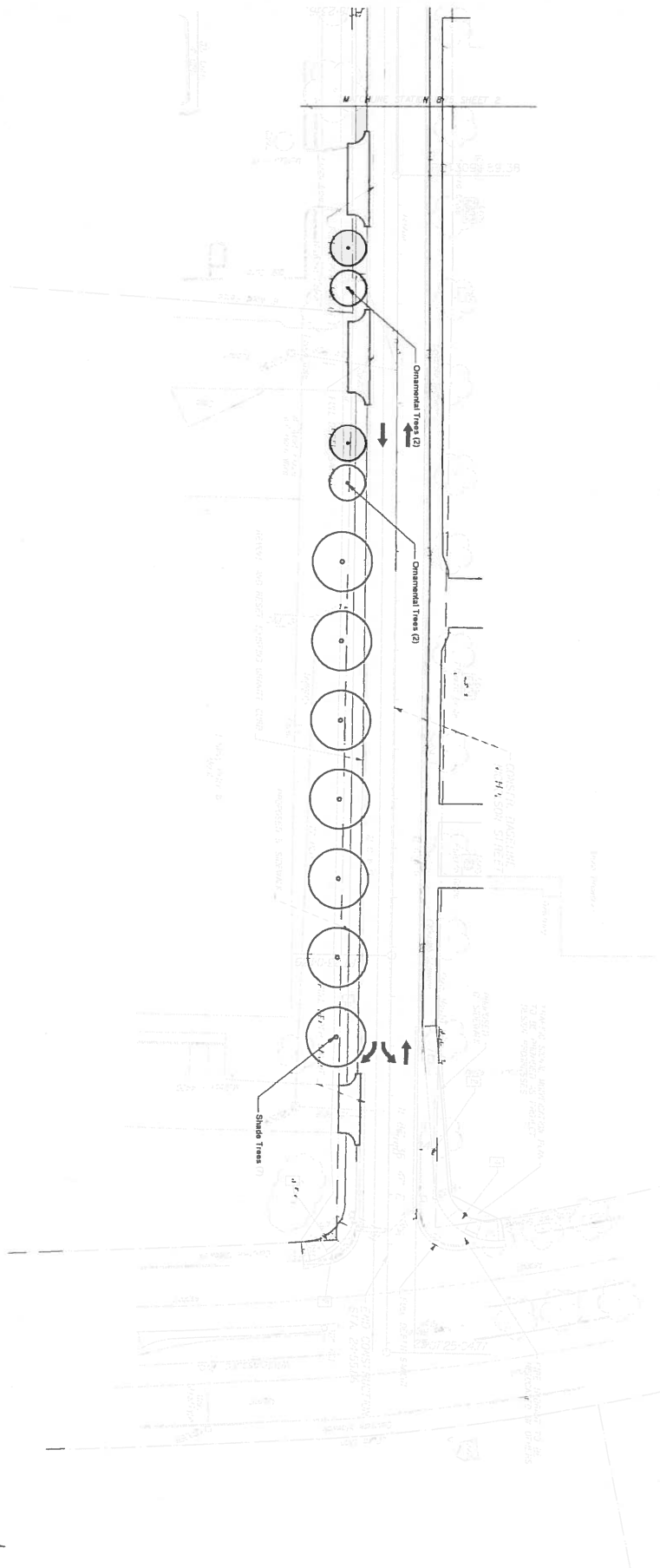

30% PLANS

THESE PLANS ARE UNFINISHED AND UNAPPROVED AND ARE NOT TO BE USED FOR ANY TYPE OF CONSTRUCTION OR THE ACQUISITION OF RIGHT OF WAY.

TITLES	1. List all revisions in parentheses and show date 2. Property owner approval in red ink 3. Revision number 4. Date 5. Description	REVISIONS		DATE	
DESIGNER	ADW	CHECKED	MSV	DATE	
DRAWN	ADW	APPROVED	MSV	DATE	
SCALE	1" = 20' (1/2" = 10') SCALE 0 25 50'				
PROJECT NAME	RELOCATED ROUTE 5 PHASE I & II				
PROJECT LOCATION	PLANTING PLAN				
DATE	SEP 2000				
DRAWING NO.	L(2)				
SCALE	1/2" = 10'				
DRAWING NO.	X XXXXX				



TECHNICAL
 Project Supervisor: [Name]
 Project Engineer: [Name]
 Mechanical Engineer: [Name]
 Electrical Engineer: [Name]
 Sanitary Engineer: [Name]

ADMINISTRATIVE
 Deputy Project Administrator: [Name]
 Project Manager: [Name]
 Director of Public Works: [Name]

DEPARTMENT OF PUBLIC WORKS
 RICHMOND, VIRGINIA